

Estação	0	1	2	3	4	5	6	7	8	9	10	11	12	13	14	15	16	17	
Cota do terreno	195,362	193,791	193,335	193,004	192,741	192,623	192,678	192,905	193,302	193,499	193,032	192,191	191,453	190,922	190,459	189,638	188,329	187,123	186,986
Cota da terraplenagem	195,612	194,141	193,708	193,335	193,150	193,073	193,073	193,231	193,567	193,724	193,123	192,518	191,914	191,310	190,672	189,783	188,641	187,599	187,438
Cota vermelha	0,250	0,350	0,372	0,332	0,410	0,473	0,395	0,326	0,265	0,225	0,090	0,328	0,462	0,388	0,213	0,145	0,313	0,476	0,452

TERRENO NATURAL

PROJETADO

ATERRO

CORTE

CURVAS DE NÍVEL

JOTA BARROS PROJETOS  
 Engº Civil - CREA 53900/D - CE

PREFEITURA MUNICIPAL DE MILHÃ - CE  
 ADEQUAÇÃO DE ESTRADAS VICINAIS NO MUNICÍPIO DE MILHÃ / CE  
**CE 371 A ASSUNÇÃO - ESTAQUEAMENTO E PERFIL LONGITUDINAL**

PRANCHA:  
**1 / 20**  
 ESCALA:  
**1/1000**

PROJETA: ENG. CIVIL ARTHUR MOREIRA TORQUATO - CREA 53.900D-CE  
 ARQUIVO: MILHÃ\_REC ESTRADA ASSUNÇÃO\_GEO\_R1.DWG

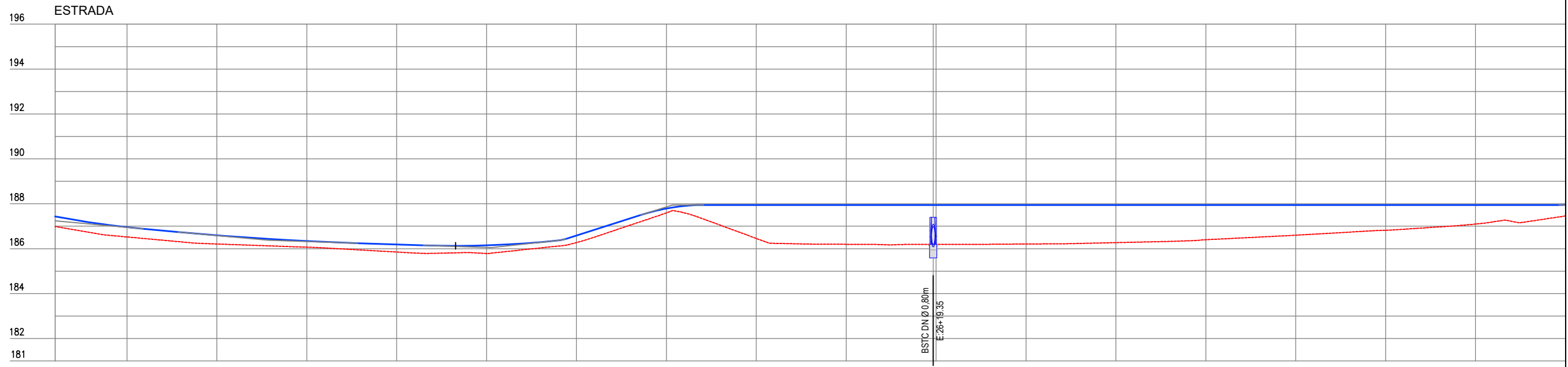
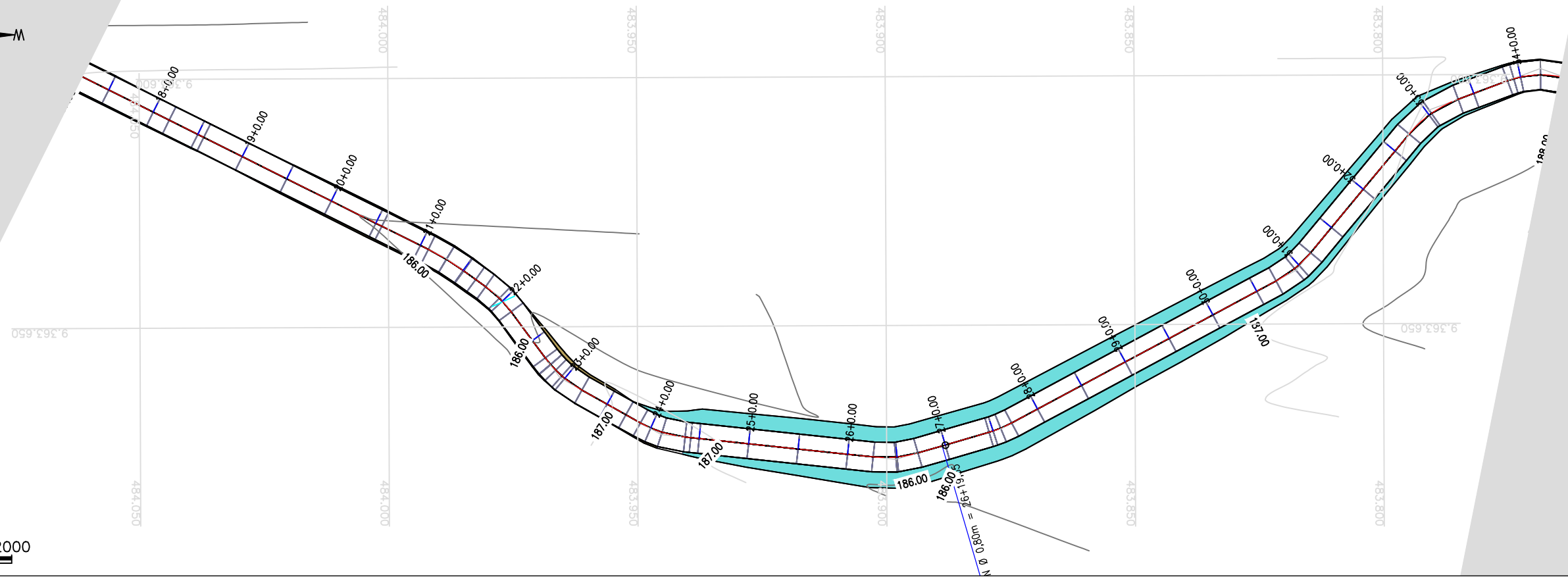
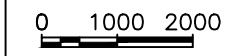
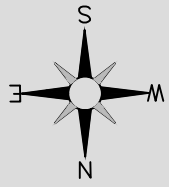

Estação	17	18	19	20	21	22	23	24	25	26	26+19.35	28	29	30	31	32	33	34
Cota do terreno	186,986	186,522	186,208	186,068	186,650	186,785	186,272	187,597	186,456	186,195	186,192	186,207	186,269	186,398	186,601	186,821	187,096	187,461
Cota da terraplenagem	187,438	186,957	186,595	186,339	186,188	186,148	186,589	187,788	187,947	187,947	187,947	187,947	187,947	187,947	187,947	187,947	187,947	187,949
Cota vermelha	0,452	0,434	0,387	0,271	0,338	0,363	0,317	0,192	1,491	1,752	1,755	1,740	1,678	1,548	1,346	1,126	0,850	0,489

JOTA BARROS PROJETOS  
 Arthur Moreira Torquato  
 Engº Civil - CREA 53900/D - CE



PREFEITURA MUNICIPAL DE MILHÃ - CE		PRANCHA:
ADEQUAÇÃO DE ESTRADAS VICINAIS NO MUNICÍPIO DE MILHÃ / CE		2 / 20
CE 371 A ASSUNÇÃO - ESTAQUEAMENTO E PERFIL LONGITUDINAL		ESCALA:
PROJETISTA:	ENG. CIVIL ARTHUR MOREIRA TORQUATO - CREA 53.900D-CE	1/1000
ARQUIVO:	MILHÃ_REC ESTRADA ASSUNÇÃO_GEO_R1.DWG	

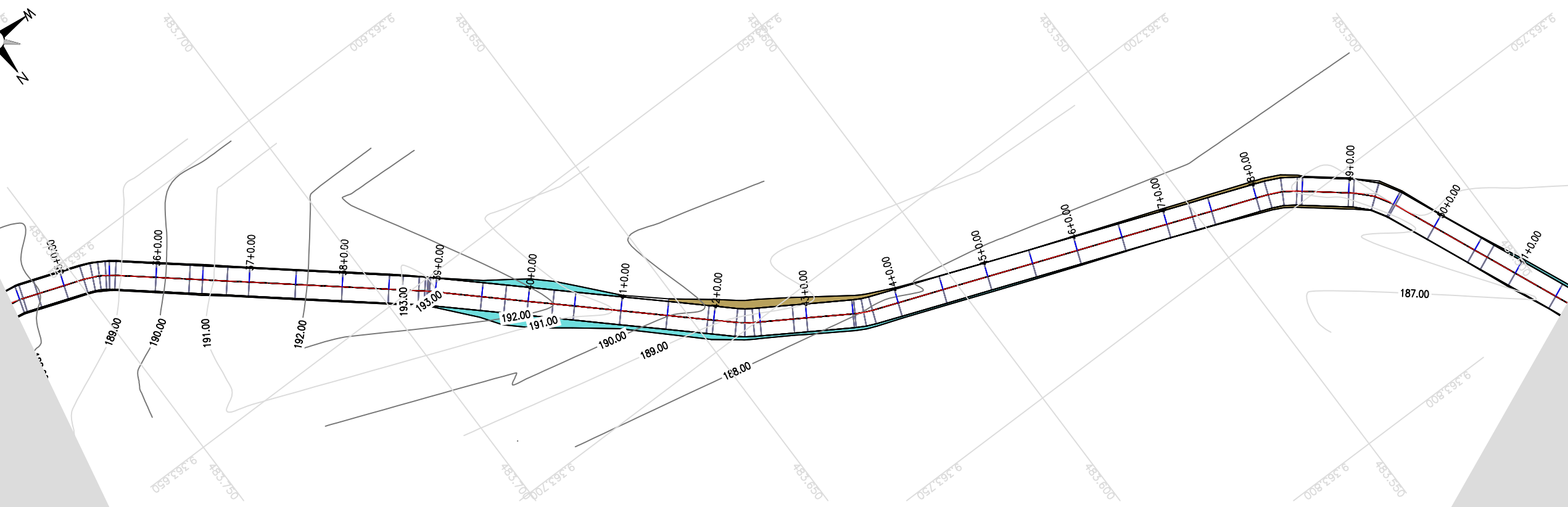
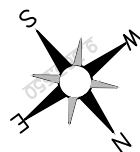

0 1000 2000

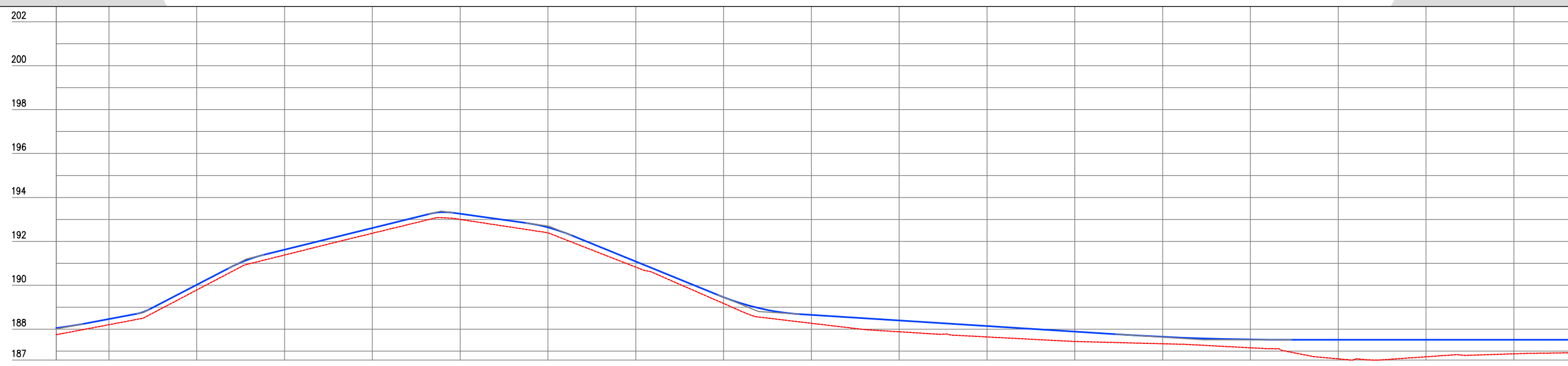

Estaca	Cota do terreno	Cota da terraplenagem	Cota vermelha
34	187,754	188,055	0,301
35	188,206	188,465	0,259
36	188,786	190,026	0,240
37	191,379	191,624	0,245
38	192,388	192,610	0,242
39	192,999	193,259	0,260
40	192,385	192,636	0,251
41	190,829	191,082	0,253
42	189,172	189,457	0,285
43	188,271	188,654	0,383
44	187,884	188,400	0,516
45	187,649	188,145	0,496
46	187,444	187,890	0,447
47	187,339	187,654	0,315
48	187,154	187,531	0,377
49	186,652	187,518	0,866
50	186,745	187,518	0,773
51	186,881	187,518	0,637
51	186,929	187,518	0,589

JOTA BARROS PROJETOS  
 Arthur Moreira Torquato  
 Engº Civil - CREA 53900/D - CE



PREFEITURA MUNICIPAL DE MILHÃ - CE	
ADEQUAÇÃO DE ESTRADAS VICINAIS NO MUNICÍPIO DE MILHÃ / CE	
CE 371 A ASSUNÇÃO - ESTAQUEAMENTO E PERFIL LONGITUDINAL	
PROJETISTA:	ENG. CIVIL ARTHUR MOREIRA TORQUATO - CREA 53.900D-CE
ARQUIVO:	MILHÃ_REC ESTRADA ASSUNÇÃO_GEO_R1.DWG

PRANCHA:  
**3 / 20**  
 ESCALA:  
 1/1000

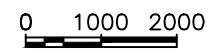
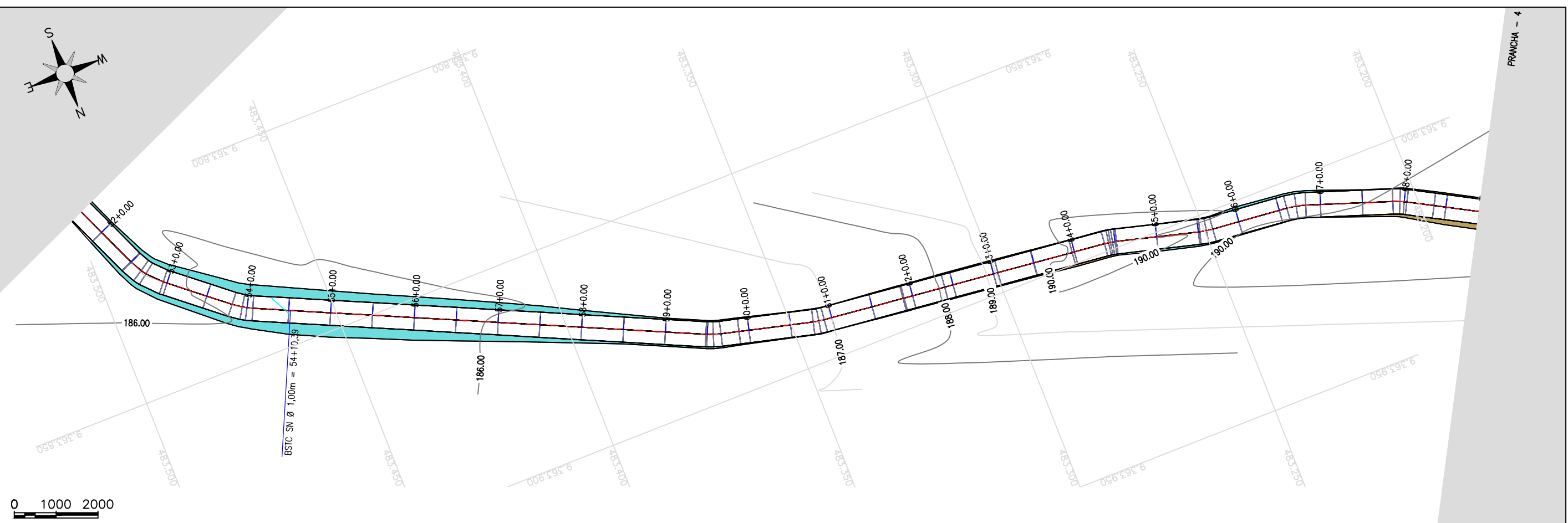
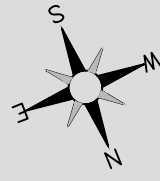

PRANCHA - 4

ESTRADA

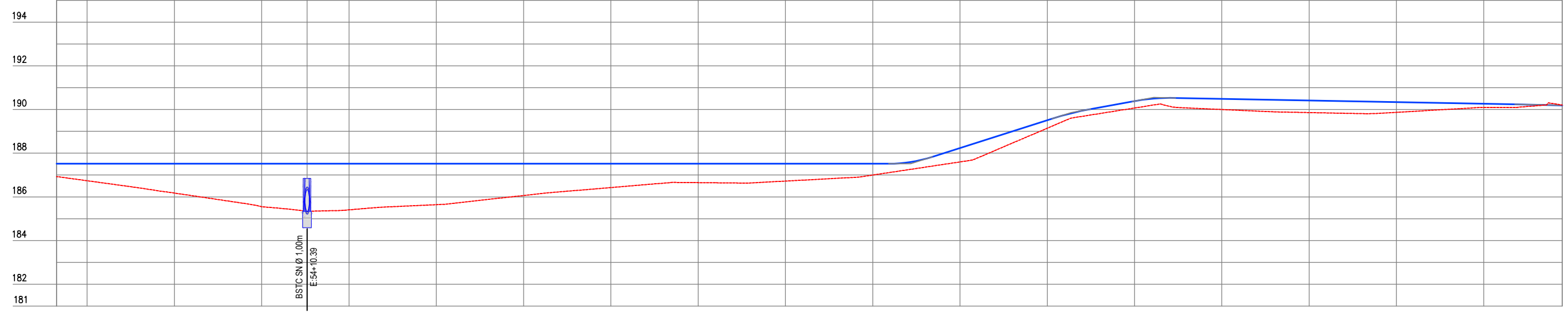

Estação	Cota do terreno	Cota da terraplenagem	Cota vermelha
51	186,929	187,518	0,589
52	186,739	187,518	0,779
53	186,175	187,518	1,343
54	185,548	187,518	1,969
54+10,39	185,339	187,518	2,178
55	185,406	187,518	2,111
56	185,643	187,518	1,875
57	186,063	187,518	1,455
58	186,426	187,518	1,091
59	186,652	187,518	0,866
60	186,723	187,518	0,795
61	187,000	187,518	0,518
62	187,600	186,237	0,637
63	188,144	189,507	0,364
64	190,068	190,387	0,318
65	189,999	190,490	0,490
66	189,859	190,413	0,554
67	189,871	190,337	0,467
68	190,092	190,261	0,170
68	190,203	190,184	-0,020

JOTA BARROS PROJETOS
   
 Arthur Moreira Torquato
   
 Engº Civil - CREA 53900/D - CE



PREFEITURA MUNICIPAL DE MILHÃ - CE  
 ADEQUAÇÃO DE ESTRADAS VICINAIS NO MUNICÍPIO DE MILHÃ / CE  
**CE 371 A ASSUNÇÃO - ESTAQUEAMENTO E PERFIL LONGITUDINAL**  
 PROJETA: ENG. CIVIL ARTHUR MOREIRA TORQUATO - CREA 53.900D-CE  
 ARQUIVO: MILHÃ\_REC ESTRADA ASSUNÇÃO\_GEO\_R1.DWG

PRANCHA:  
**4 / 20**  
 ESCALA:  
**1/1000**

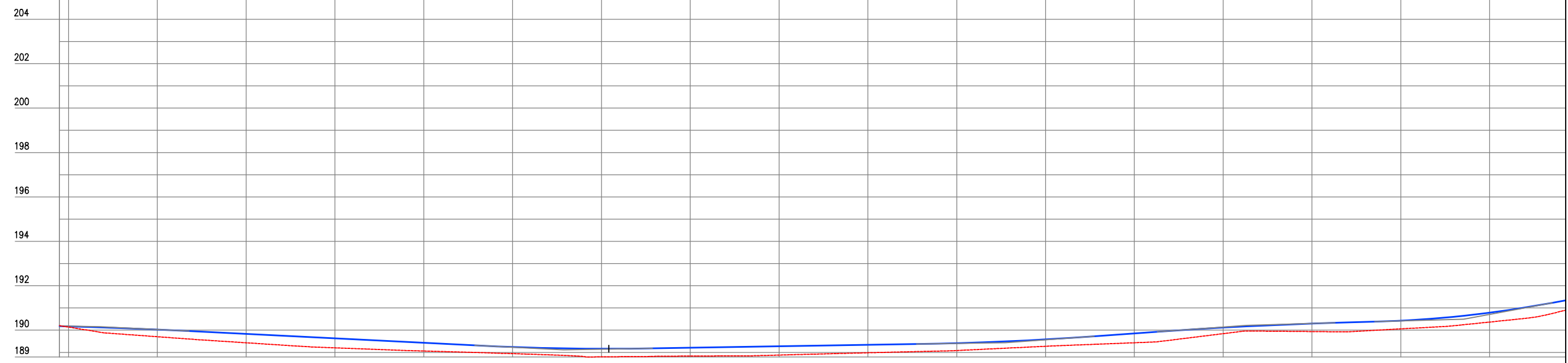
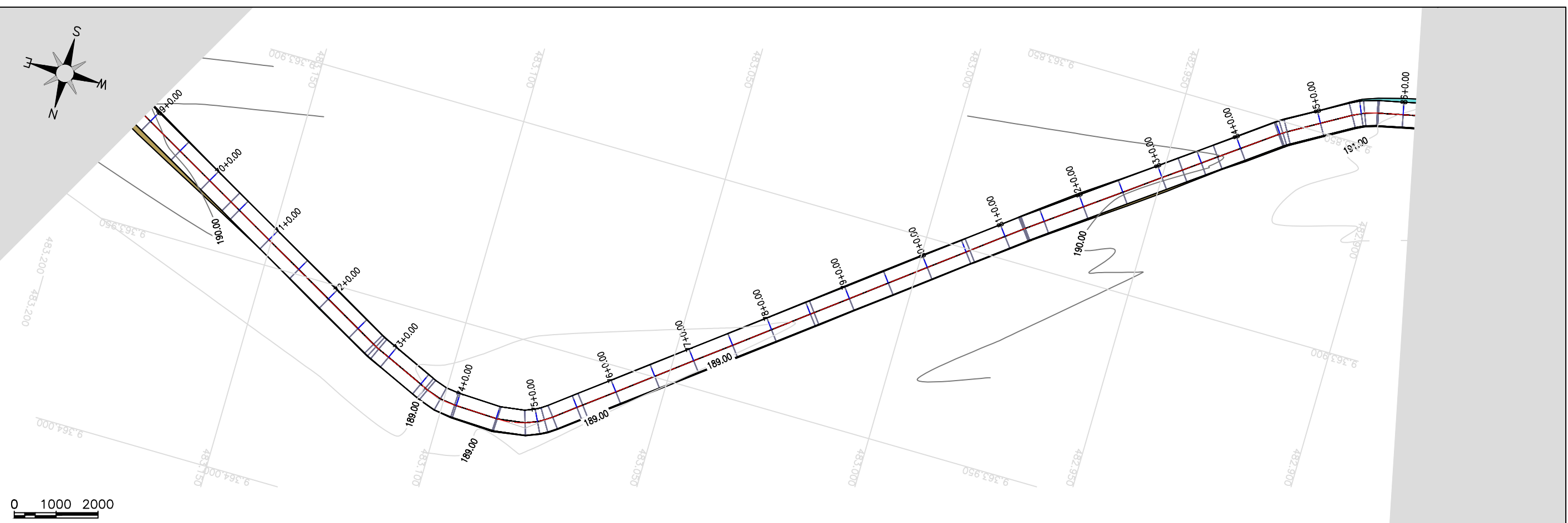
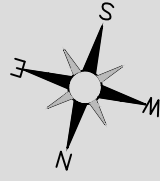

Estaca	Cota do terreno	Cota da terraplenagem	Cota vermelha
68	190,203	190,184	-0,020
69	190,139	190,172	0,033
70	189,706	190,026	0,320
71	189,433	189,830	0,397
72	189,205	189,630	0,425
73	189,061	189,431	0,370
74	188,944	189,243	0,299
75	188,901	189,166	0,365
76	188,834	189,209	0,374
77	188,879	189,274	0,394
78	188,983	189,338	0,355
79	189,083	189,414	0,331
80	189,276	189,585	0,309
81	189,434	189,855	0,421
82	189,843	190,117	0,274
83	189,938	190,297	0,359
84	190,059	190,428	0,369
85	190,366	190,790	0,424

JOTA BARROS PROJETOS  
 Arthur Moreira Torquato  
 Engº Civil - CREA 53900/D - CE



PREFEITURA MUNICIPAL DE MILHÃ - CE		PRANCHA: <b>5 / 20</b>
ADEQUAÇÃO DE ESTRADAS VICINAIS NO MUNICÍPIO DE MILHÃ / CE		
<b>CE 371 A ASSUNÇÃO - ESTAQUEAMENTO E PERFIL LONGITUDINAL</b>		
PROJETISTA:	ENG. CIVIL ARTHUR MOREIRA TORQUATO - CREA 53.900D-CE	ESCALA: <b>1/1000</b>
ARQUIVO:	MILHÃ_REC ESTRADA ASSUNÇÃO_GEO_R1.DWG	

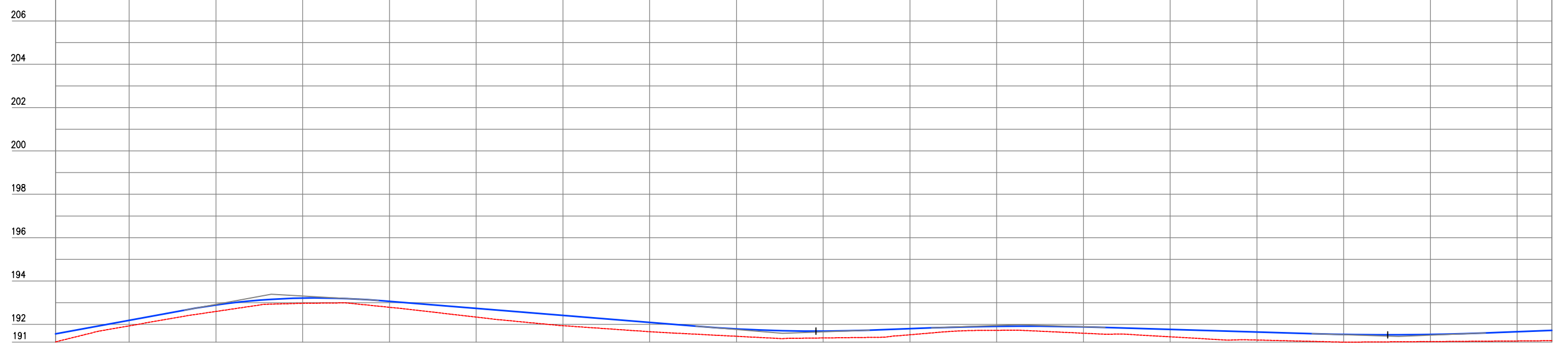
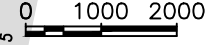
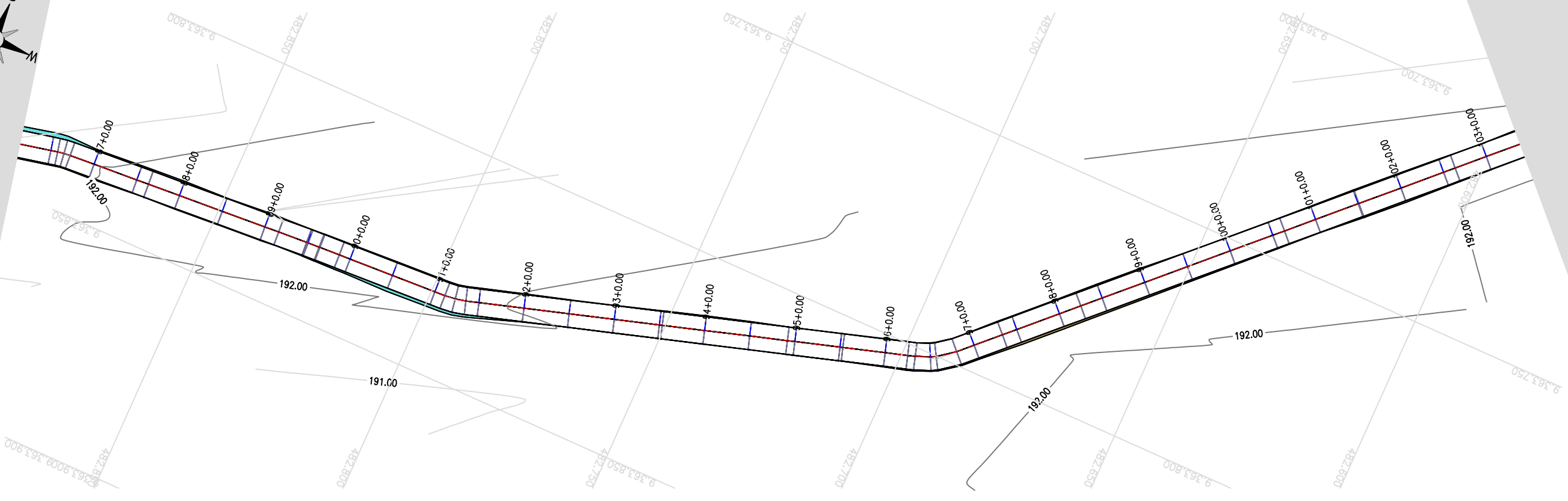
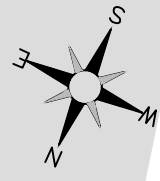

Estaca	Cota do terreno	Cota da terraplenagem	Cota vermelha
86	191,192	191,560	0,368
87	191,931	192,187	0,256
88	192,596	192,892	0,296
89	192,971	193,212	0,240
90	192,787	193,057	0,270
91	192,335	192,733	0,398
92	191,938	192,410	0,471
93	191,660	192,086	0,426
94	191,449	191,786	0,338
95	191,373	191,690	0,318
96	191,521	191,801	0,279
97	191,725	191,907	0,183
98	191,591	191,885	0,294
99	191,426	191,767	0,342
100	191,277	191,645	0,368
101	191,179	191,532	0,353
102	191,205	191,531	0,326
103	191,235	191,661	0,426
103	191,247	191,724	0,476

TERRENO NATURAL	PROJETADO	ATERRO	CORTE	CURVAS DE NÍVEL

JOTA BARROS PROJETOS  
 Arthur Moreira Torquato  
 Engº Civil - CREA 53900/D - CE



PREFEITURA MUNICIPAL DE MILHÃ - CE

ADEQUAÇÃO DE ESTRADAS VICINAIS NO MUNICÍPIO DE MILHÃ / CE

**CE 371 A ASSUNÇÃO - ESTAQUEAMENTO E PERFIL LONGITUDINAL**

PROJETISTA:	ENG. CIVIL ARTHUR MOREIRA TORQUATO - CREA 53.900D-CE
ARQUIVO:	MILHÃ_REC ESTRADA ASSUNÇÃO_GEO_R1.DWG

PRANCHA:  
**6 / 20**

ESCALA:  
**1/1000**

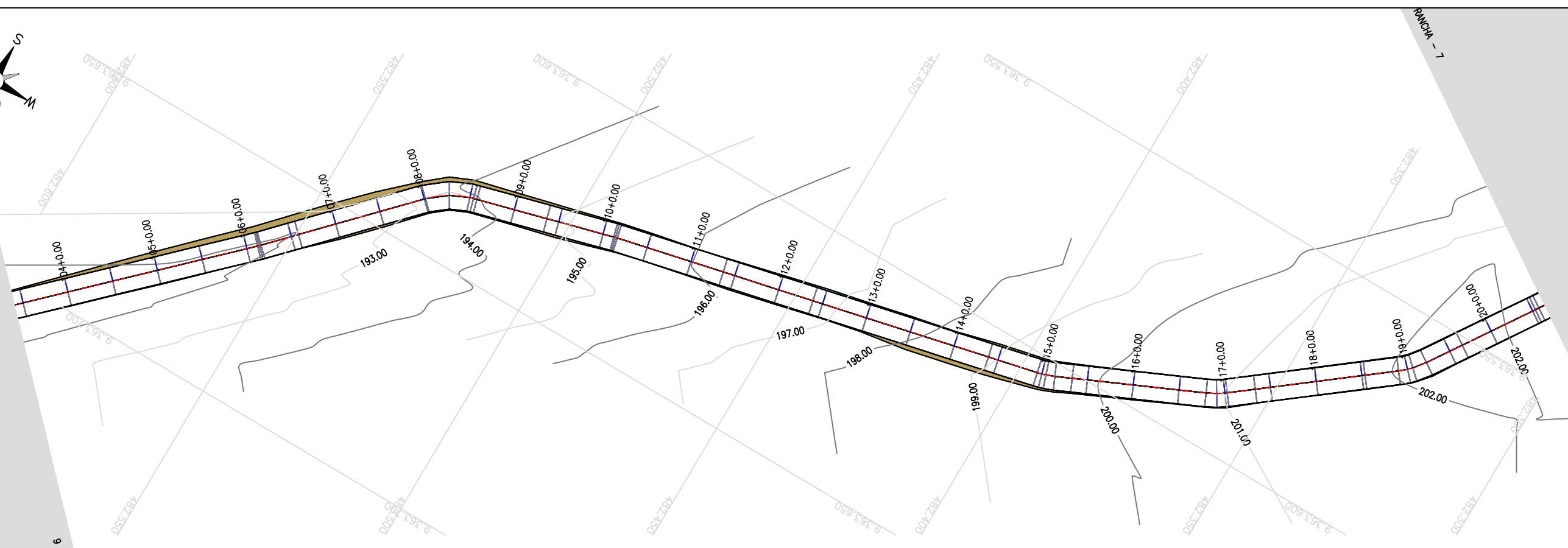
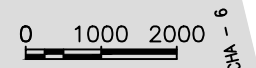
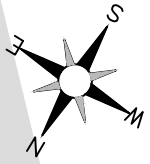

Estaca	03	04	05	06	07	08	09	10	11	12	13	14	15	16	17	18	19	20	20
Cota do terreno	191,247	191,455	191,726	191,803	192,312	193,230	194,418	195,386	195,988	196,518	197,271	198,479	199,468	200,276	201,021	201,570	202,074	202,054	201,809
Cota da terraplenagem	191,724	191,818	192,026	192,333	192,721	193,409	194,424	195,458	196,303	196,985	197,685	198,544	199,544	200,504	201,239	201,787	202,270	202,343	202,133
Cota vertebra	0,476	0,364	0,300	0,530	0,410	0,178	0,006	0,073	0,316	0,467	0,415	0,066	0,075	0,228	0,218	0,218	0,196	0,288	0,324

TERRENO NATURAL	PROJETADO	ATERRO	CORTE	CURVAS DE NÍVEL

JOTA BARROS PROJETOS  
 Arthur Moreira Torquato  
 Engº Civil - CREA 53900/D - CE



PREFEITURA MUNICIPAL DE MILHÃ - CE

ADEQUAÇÃO DE ESTRADAS VICINAIS NO MUNICÍPIO DE MILHÃ / CE

**CE 371 A ASSUNÇÃO - ESTAQUEAMENTO E PERFIL LONGITUDINAL**

PROJETISTA:	ENG. CIVIL ARTHUR MOREIRA TORQUATO - CREA 53.900D-CE
ARQUIVO:	MILHÃ_REC ESTRADA ASSUNÇÃO_GEO_R1.DWG

PRANCHA:

7 / 20

ESCALA:

1/1000

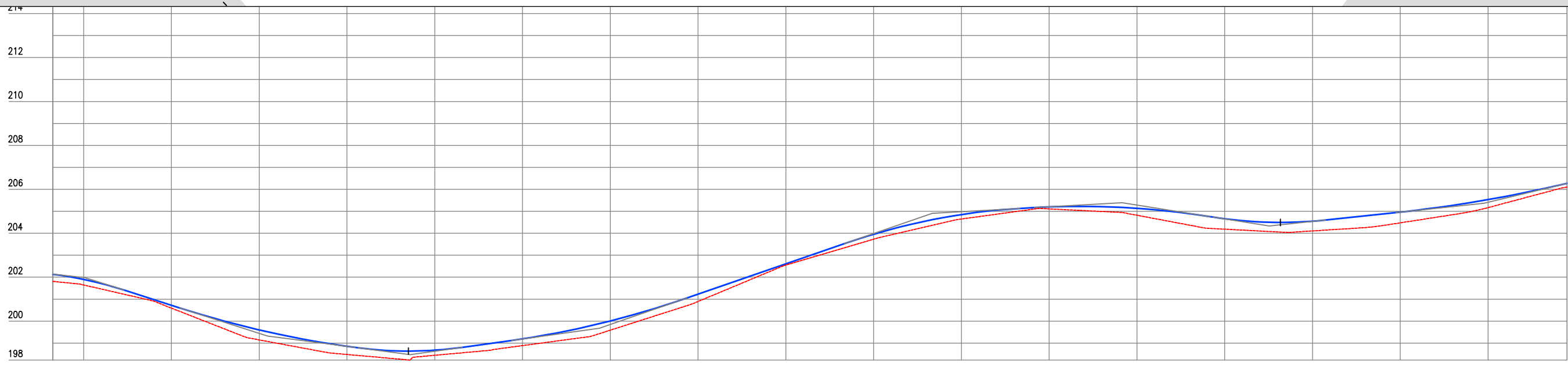
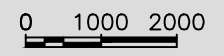
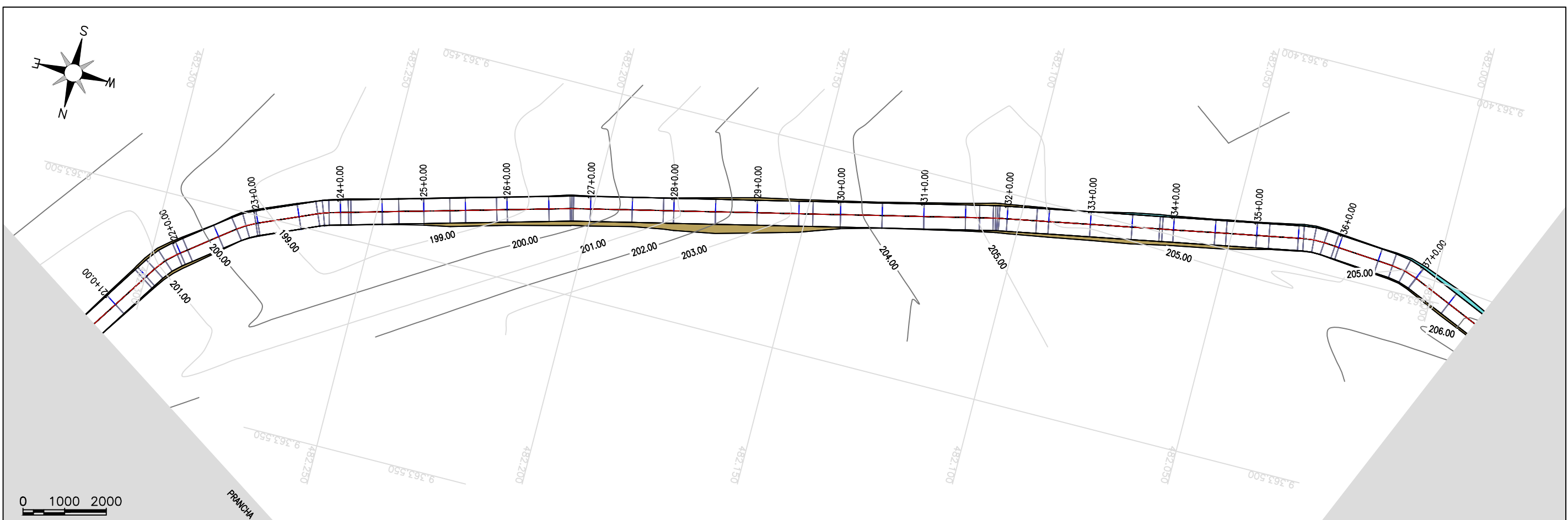
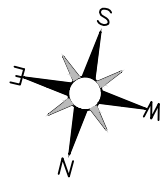

Estaca	120	121	122	123	124	125	126	127	128	129	130	131	132	133	134	135	136	137	
Cota da terra	201,809	201,647	200,592	199,144	198,481	198,444	198,885	199,588	200,894	202,551	203,728	204,648	205,109	204,821	204,186	204,106	204,474	205,167	206,103
Cota da terraplenagem	202,133	201,901	200,724	199,600	198,854	198,678	199,194	200,008	201,229	202,607	203,954	204,852	205,199	205,136	204,659	204,548	204,964	205,534	206,274
Cota vermelha	0,324	0,254	0,132	0,456	0,372	0,233	0,308	0,420	0,335	0,056	0,226	0,204	0,090	0,315	0,473	0,443	0,490	0,367	0,171

TERRENO NATURAL	PROJETADO	ATERRO	CORTE	CURVAS DE NÍVEL

JOTA BARROS PROJETOS  
 Arthur Moreira Torquato  
 Engº Civil - CREA 53900/D - CE



PREFEITURA MUNICIPAL DE MILHÃ - CE	
ADEQUAÇÃO DE ESTRADAS VICINAIS NO MUNICÍPIO DE MILHÃ / CE	
CE 371 A ASSUNÇÃO - ESTAQUEAMENTO E PERFIL LONGITUDINAL	
PROJETISTA:	ENG. CIVIL ARTHUR MOREIRA TORQUATO - CREA 53.900D-CE
ARQUIVO:	MILHÃ_REC ESTRADA ASSUNÇÃO_GEO_R1.DWG

PRANCHA:	8 / 20
ESCALA:	1/1000



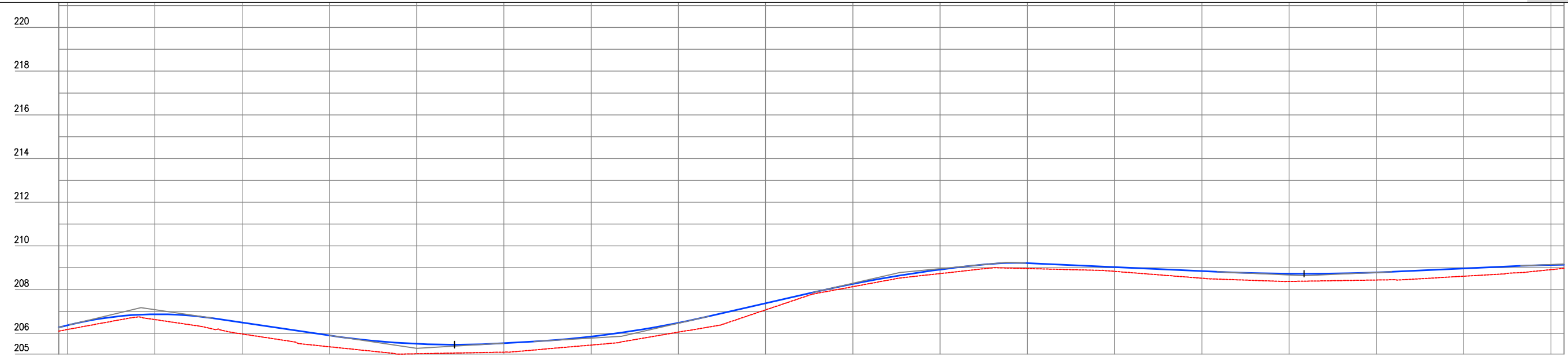
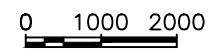
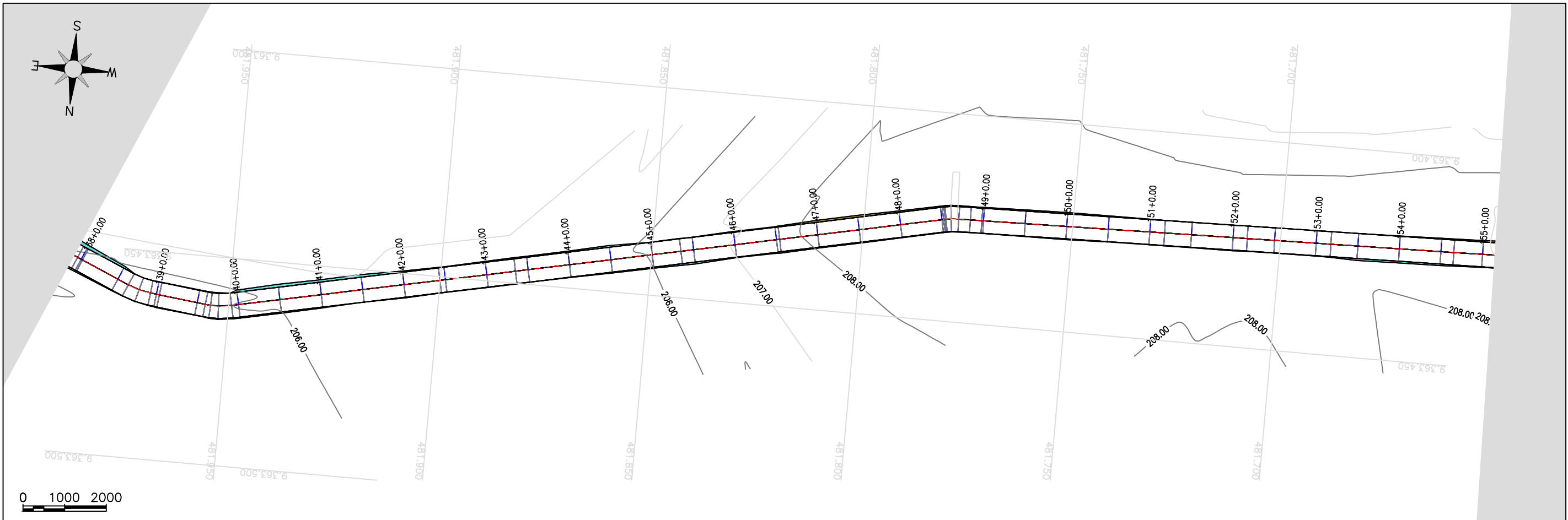
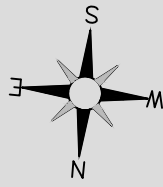

Estaca	Cota do terreno	Cota da terraplenagem	Cota vermilho
137	206,103	206,274	0,171
138	206,177	206,370	0,193
139	206,630	206,873	0,244
140	205,971	206,491	0,520
141	205,385	205,903	0,518
142	205,085	205,520	0,435
143	205,138	205,547	0,409
144	205,463	205,852	0,389
145	206,053	206,479	0,426
146	207,074	207,374	0,299
147	208,135	208,261	0,125
148	208,735	208,919	0,184
149	208,986	209,208	0,242
150	208,836	209,028	0,192
151	208,522	208,849	0,327
152	208,376	208,730	0,354
153	208,440	208,789	0,349
154	208,613	208,988	0,356
155	208,914	209,132	0,218
155	208,975	209,141	0,167

JOTA BARROS PROJETOS  
 Arthur Moreira Torquato  
 Engº Civil - CREA 53900D - CE



PREFEITURA MUNICIPAL DE MILHÃ - CE	
ADEQUAÇÃO DE ESTRADAS VICINAIS NO MUNICÍPIO DE MILHÃ / CE	
<b>CE 371 A ASSUNÇÃO - ESTAQUEAMENTO E PERFIL LONGITUDINAL</b>	
PROJETISTA:	ENG. CIVIL ARTHUR MOREIRA TORQUATO - CREA 53.900D-CE
ARQUIVO:	MILHÃ_REC ESTRADA ASSUNÇÃO_GEO_R1.DWG

PRANCHA:	9 / 20
ESCALA:	1/1000

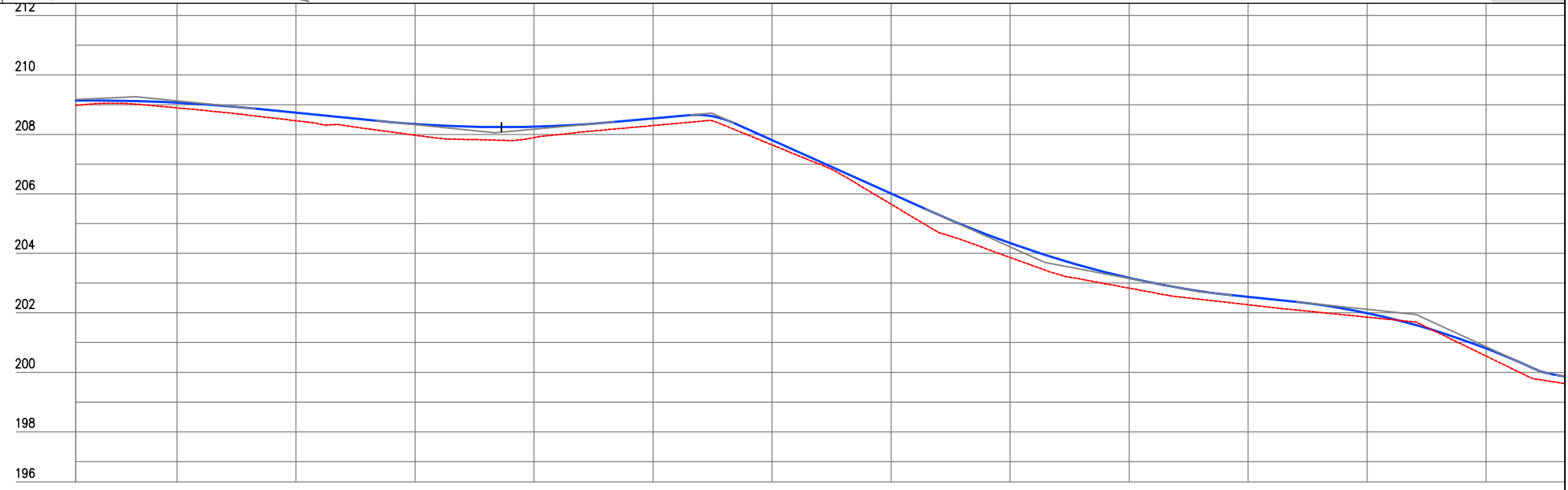
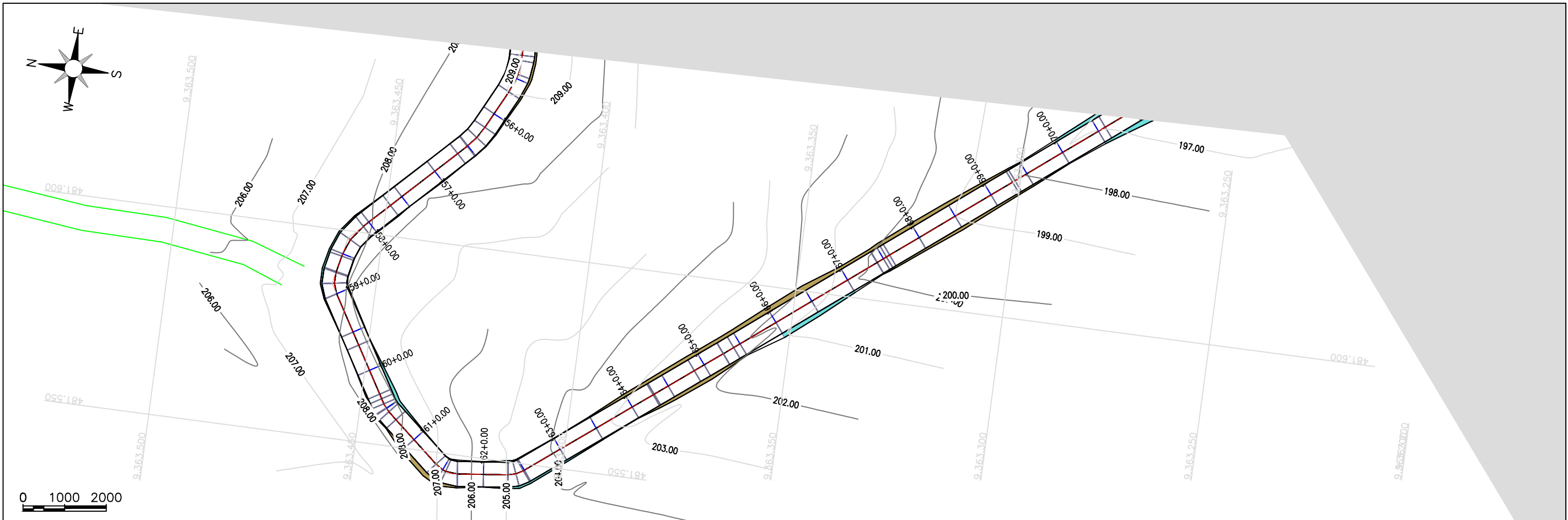
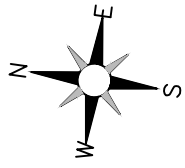

Estação	Cota do terreno	Cota da terraplenagem	Cota vermelha
155	208,975	208,141	0,167
156	208,894	208,068	0,174
157	208,469	208,729	0,289
158	207,974	208,348	0,374
159	207,883	208,262	0,369
160	208,299	208,535	0,237
161	207,648	207,804	0,156
162	206,654	206,010	0,356
163	203,864	204,345	0,481
164	202,831	203,176	0,346
165	202,272	202,536	0,264
166	201,855	201,992	0,137
167	200,546	200,801	0,255

JOTA BARROS PROJETOS
   
 Arthur Moreira Torquato
   
 Engº Civil - CREA 53900D - CE



**PREFEITURA MUNICIPAL DE MILHÃ - CE**  
**ADEQUAÇÃO DE ESTRADAS VICINAIS NO MUNICÍPIO DE MILHÃ / CE**  
**CE 371 A ASSUNÇÃO - ESTAQUEAMENTO E PERFIL LONGITUDINAL**

PROJETA: ENG. CIVIL ARTHUR MOREIRA TORQUATO - CREA 53.900D-CE  
 ARQUIVO: MILHÃ\_REC ESTRADA ASSUNÇÃO\_GEO\_R1.DWG

PRANCHA: **10 / 20**  
 ESCALA: **1/1000**

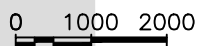
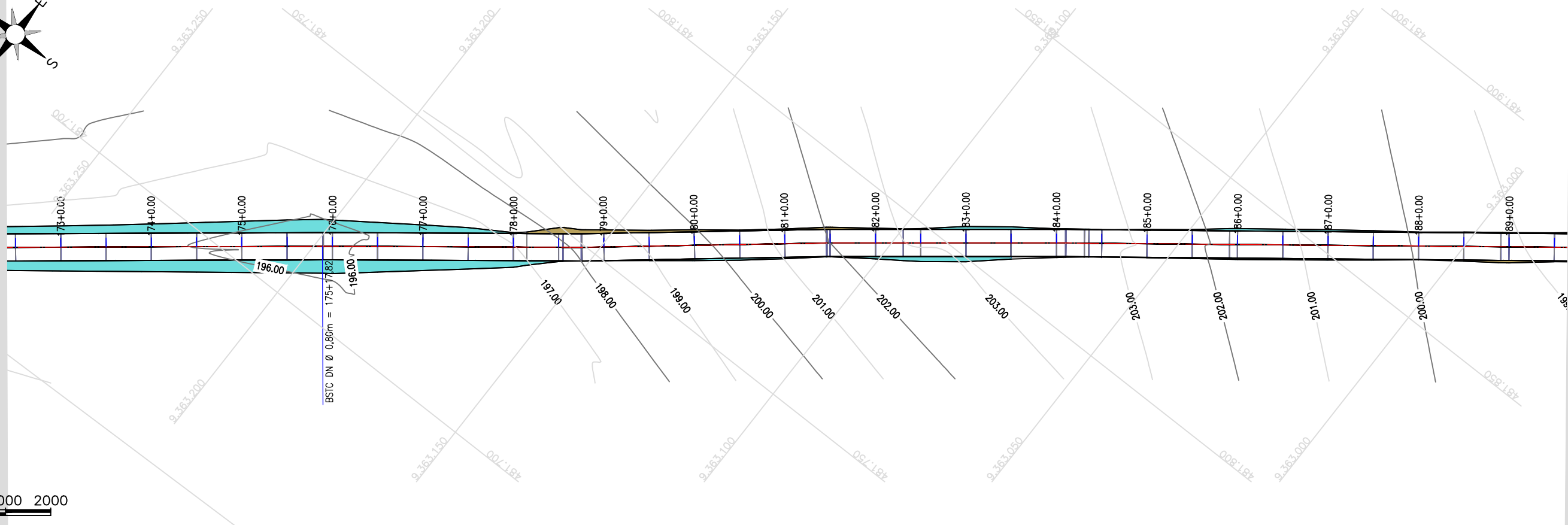
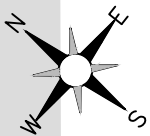

ESTRADA



Cota Vermelha	Cota da terraplenagem	Cota do terreno	Estaca
1,473	197,785	196,312	172
1,541	197,785	196,244	173
1,683	197,785	196,102	174
1,817	197,785	195,968	175
1,951	197,785	195,834	175+17,82
1,863	197,785	195,923	176
1,509	197,785	196,276	177
0,831	197,785	196,954	178
0,193	196,695	196,501	179
0,352	200,091	199,739	180
0,285	201,487	201,202	181
0,314	202,883	202,570	182
0,345	203,998	203,654	183
0,299	203,991	203,692	184
0,210	203,093	202,863	185
0,538	202,161	201,623	186
0,503	201,239	200,736	187
0,368	200,316	199,948	188
0,205	199,396	199,190	189
0,433	198,921	198,488	189

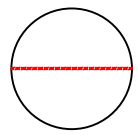

TERRENO NATURAL

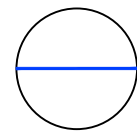

PROJETADO

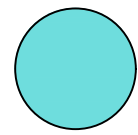

ATERRO

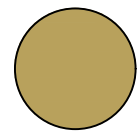

CORTE

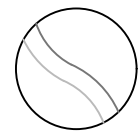

CURVAS DE NÍVEL

JOTA BARROS PROJETOS  
Arthur Moreira Torquato  
Engº Civil - CREA 53900/D - CE



PREFEITURA MUNICIPAL DE MILHÃ - CE

ADEQUAÇÃO DE ESTRADAS VICINAIS NO MUNICÍPIO DE MILHÃ / CE

CE 371 A ASSUNÇÃO - ESTAQUEAMENTO E PERFIL LONGITUDINAL

PROJETISTA: ENG. CIVIL ARTHUR MOREIRA TORQUATO - CREA 53.900D-CE

ARQUIVO: MILHÃ\_REC ESTRADA ASSUNÇÃO\_GEO\_R1.DWG

PRANCHA:

11 / 20

ESCALA:

1/1000

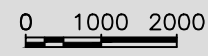
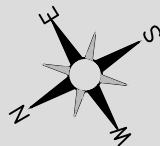

PRANCHA

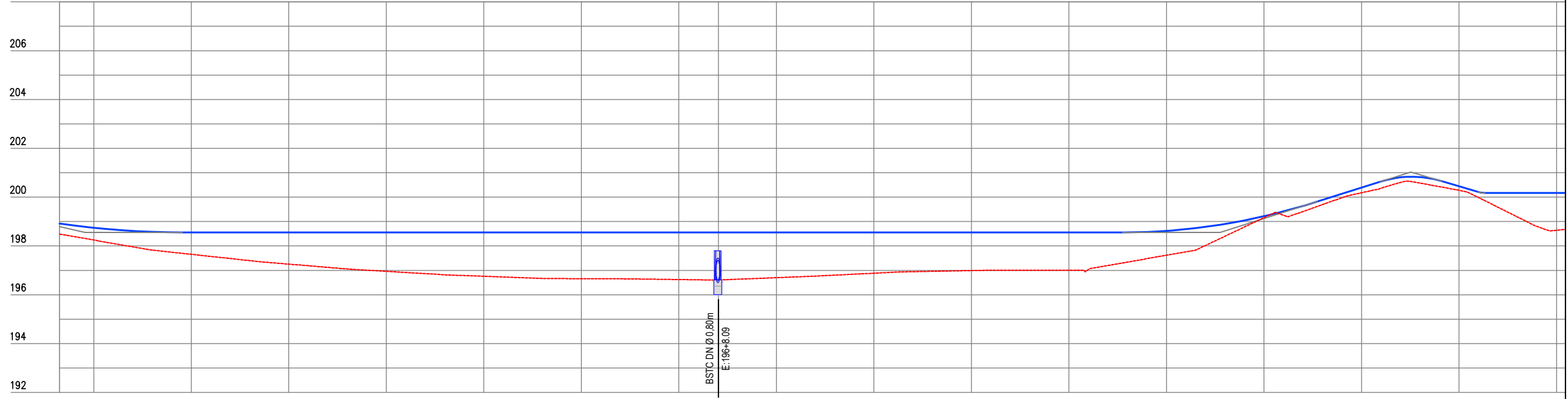
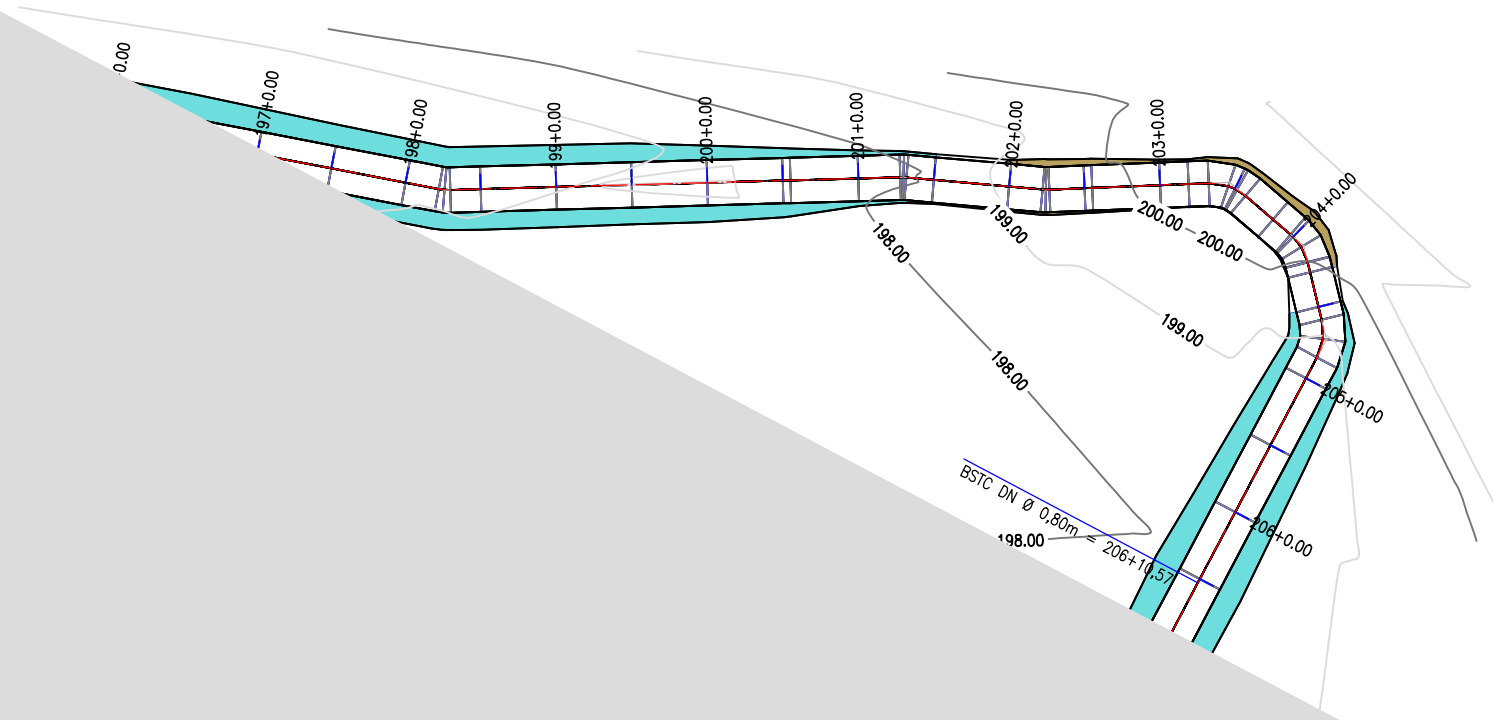

Estação	189	190	191	192	193	194	195	196	196+8.09	197	198	199	200	201	202	203	204	205
Cota do terreno	198,488	198,242	197,657	197,255	196,959	196,758	196,659	196,624	196,605	196,700	196,883	196,991	197,002	197,620	199,158	200,179	200,280	198,643
Cota da terraplenagem	198,921	198,746	198,555	198,555	198,555	198,555	198,555	198,555	198,555	198,555	198,555	198,555	198,555	198,619	199,220	200,389	200,445	200,173
Cota vermelha	0,433	0,504	0,898	1,300	1,596	1,797	1,896	1,931	1,950	1,855	1,672	1,564	1,553	1,000	0,062	0,210	0,165	1,530

TERRENO NATURAL    PROJETADO    ATERRO    CORTE    CURVAS DE NÍVEL

JOTA BARROS PROJETOS  
 Arthur Moreira Torquato  
 Engº Civil - CREA 53900/D - CE



PREFEITURA MUNICIPAL DE MILHÃ - CE  
 ADEQUAÇÃO DE ESTRADAS VICINAIS NO MUNICÍPIO DE MILHÃ / CE  
**CE 371 A ASSUNÇÃO - ESTAQUEAMENTO E PERFIL LONGITUDINAL**  
 PROJETISTA: ENG. CIVIL ARTHUR MOREIRA TORQUATO - CREA 53.900D-CE  
 ARQUIVO: MILHÃ\_REC ESTRADA ASSUNÇÃO\_GEO\_R1.DWG

PRANCHA:  
**12 / 20**  
 ESCALA:  
**1/1000**

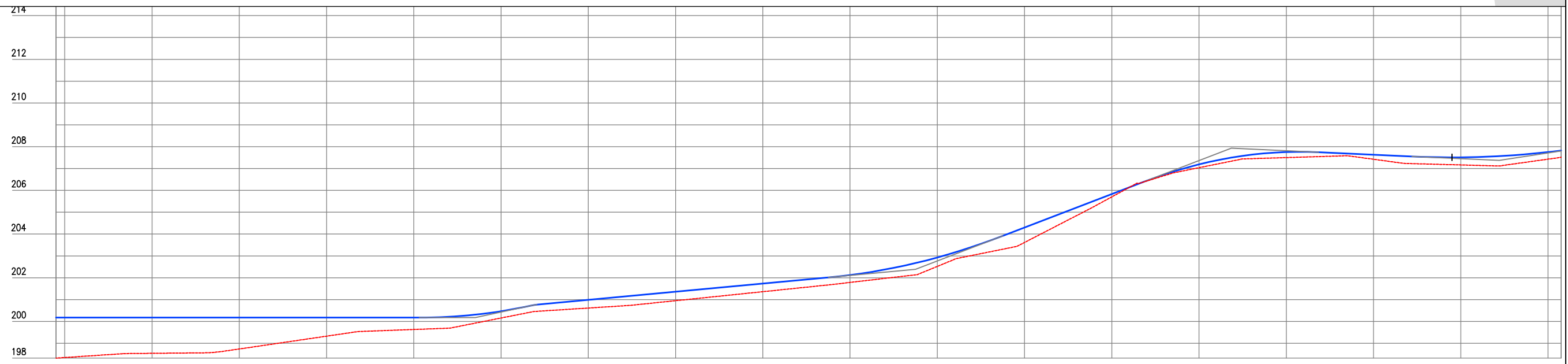
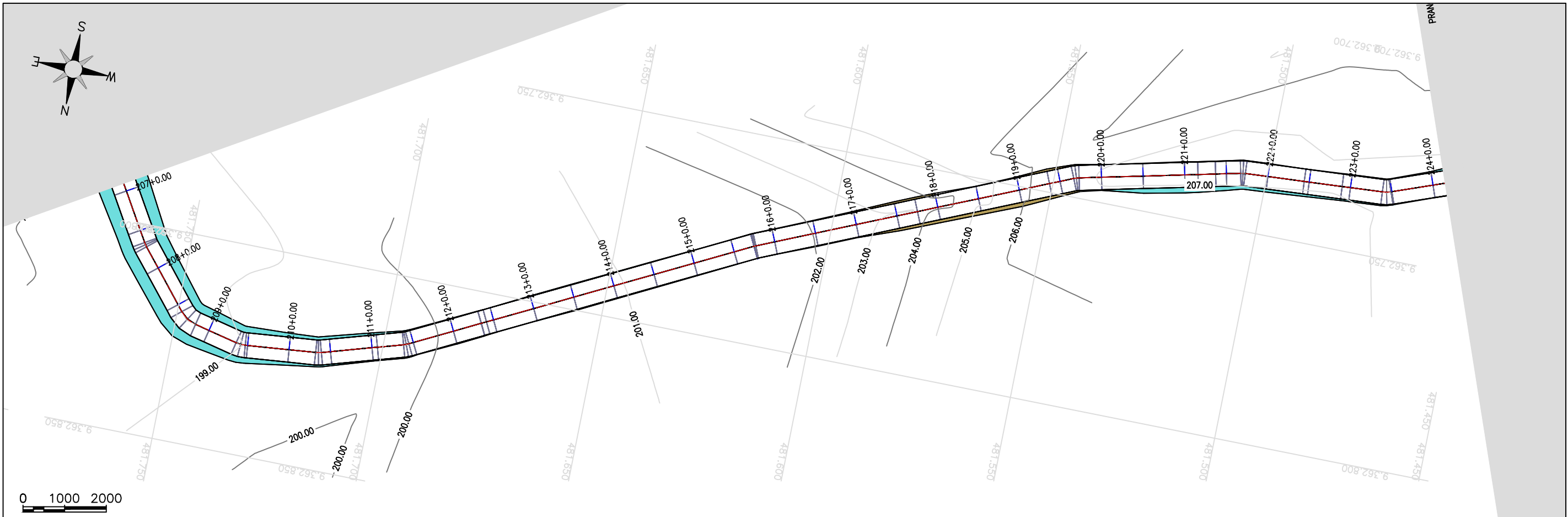
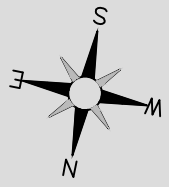

Estaca	206	207	208	209	210	211	212	213	214	215	216	217	218	219	220	221	222	223	224
Cota do terreno	196,322	196,348	196,540	198,739	199,325	199,632	200,156	200,613	200,949	201,362	201,786	202,519	203,617	205,703	207,036	207,501	207,424	207,165	207,430
Cota da terraplenagem	200,173	200,173	200,173	200,173	200,173	200,173	200,468	200,986	201,358	201,731	202,121	202,928	204,297	206,829	207,192	207,756	207,633	207,514	207,752
Cota vermelha	1,851	1,825	1,633	1,434	0,848	0,541	0,311	0,373	0,409	0,369	0,335	0,409	0,660	0,126	0,153	0,255	0,209	0,349	0,322

JOTA BARROS PROJETOS  
 Arthur Moreira Torquato  
 Engº Civil - CREA 53900/D - CE



PREFEITURA MUNICIPAL DE MILHÃ - CE		PRANCHA: <b>13 / 20</b>
ADEQUAÇÃO DE ESTRADAS VICINAIS NO MUNICÍPIO DE MILHÃ / CE		
<b>CE 371 A ASSUNÇÃO - ESTAQUEAMENTO E PERFIL LONGITUDINAL</b>		ESCALA: <b>1/1000</b>
PROJETISTA:	ENG. CIVIL ARTHUR MOREIRA TORQUATO - CREA 53.900D-CE	
ARQUIVO:	MILHÃ_REC ESTRADA ASSUNÇÃO_GEO_R1.DWG	

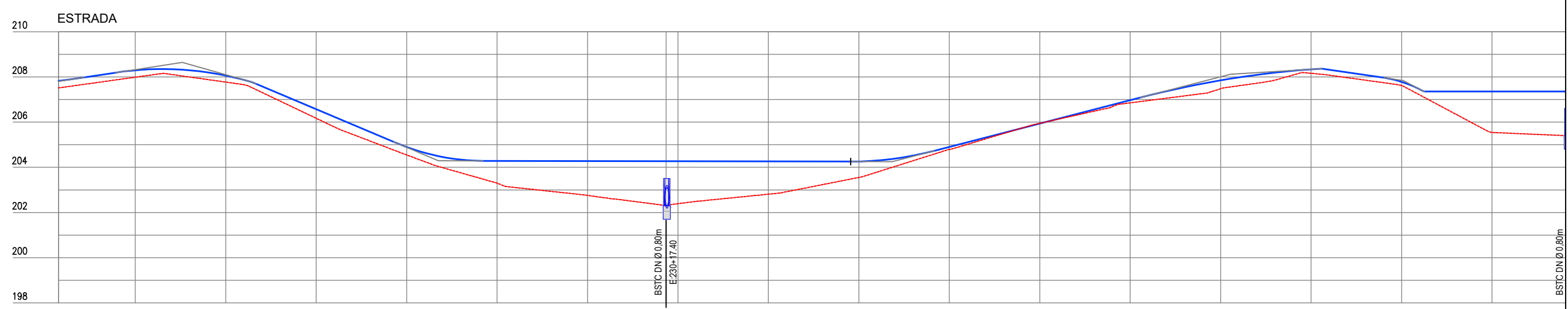
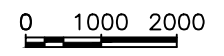
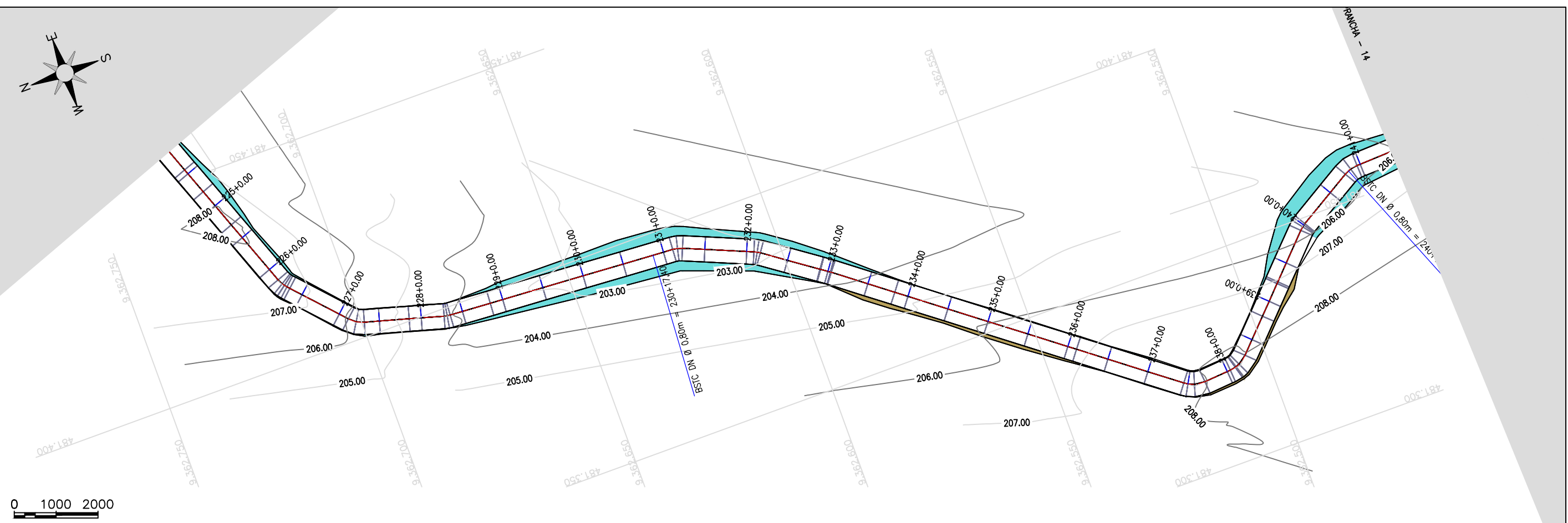
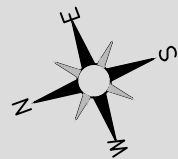

Estaca	224	225	226	227	228	229	230	231	232	233	234	235	236	237	238	239	240	
Cota do terreno	207,513	207,988	207,772	206,169	204,549	203,302	202,758	202,307	202,811	203,552	204,791	205,945	206,854	207,478	208,160	207,619	205,545	205,409
Cota da terraplenagem	207,822	208,295	208,058	206,574	204,900	204,284	204,276	204,269	204,261	204,258	204,902	205,936	206,970	207,849	208,338	207,782	207,359	207,359
Cota vermelha	0,308	0,308	0,286	0,404	0,351	0,982	1,518	1,962	1,450	0,706	0,111	-0,009	0,116	0,370	0,179	0,163	1,815	1,950

JOTA BARROS PROJETOS
   
 Arthur Moreira Torquato
   
 Engº Civil - CREA 53900/D - CE



PREFEITURA MUNICIPAL DE MILHÃ - CE		PRANCHA:
ADEQUAÇÃO DE ESTRADAS VICINAIS NO MUNICÍPIO DE MILHÃ / CE		14 / 20
CE 371 A ASSUNÇÃO - ESTAQUEAMENTO E PERFIL LONGITUDINAL		ESCALA:
PROJETISTA:	ENG. CIVIL ARTHUR MOREIRA TORQUATO - CREA 53.900D-CE	1/1000
ARQUIVO:	MILHÃ_REC ESTRADA ASSUNÇÃO_GEO_R1.DWG	

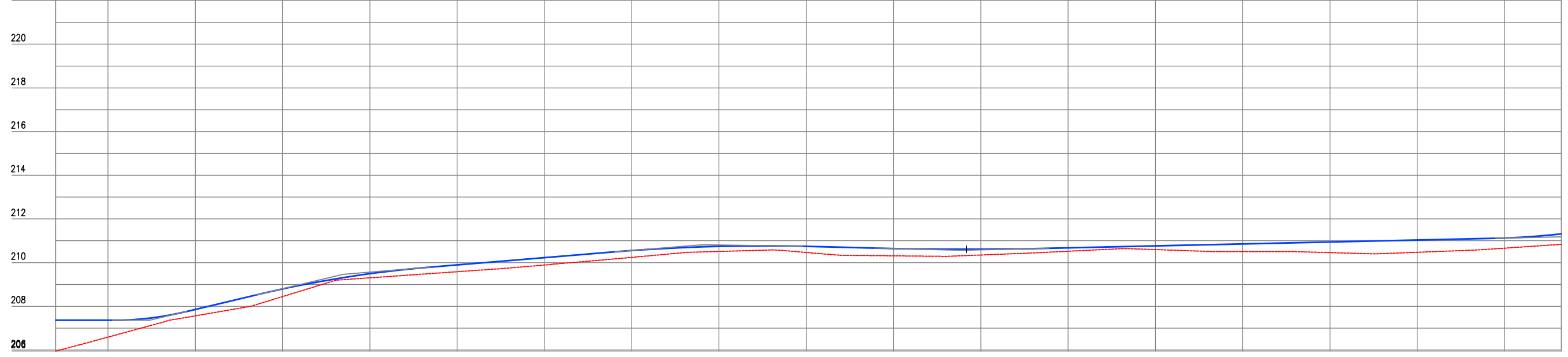
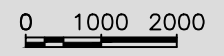
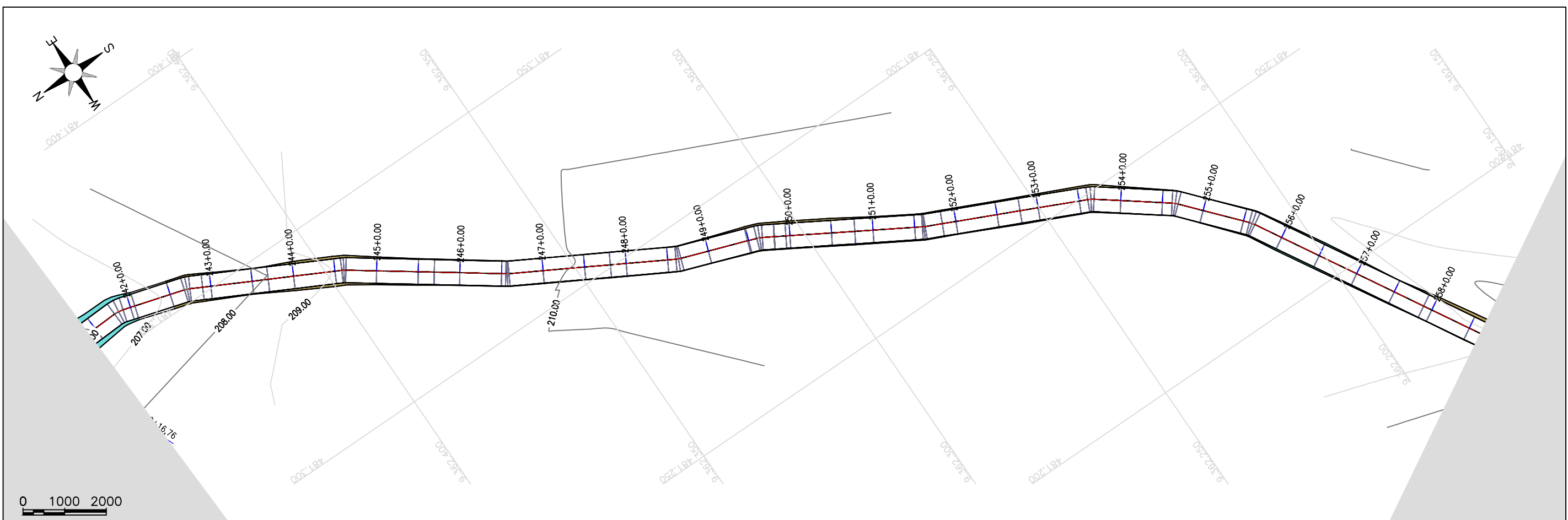
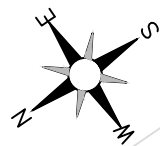

Estaca	241	242	243	244	245	246	247	248	249	250	251	252	253	254	255	256	257	258	
Cota do terreno	205,949	206,588	207,566	208,445	209,303	209,584	209,892	210,239	210,512	210,465	210,311	210,348	210,521	210,597	210,505	210,458	210,474	210,662	210,836
Cota da terraplenagem	207,359	207,359	207,857	208,793	209,494	209,897	210,226	210,552	210,745	210,742	210,644	210,612	210,673	210,763	210,853	210,943	211,033	211,126	211,316
Cota da vermelha	1,411	0,772	0,291	0,348	0,190	0,314	0,334	0,313	0,233	0,277	0,333	0,264	0,152	0,166	0,348	0,485	0,559	0,463	0,480

TERRENO NATURAL	PROJETADO	ATERRO	CORTE	CURVAS DE NÍVEL

JOTA BARROS PROJETOS  
 Arthur Moreira Torquato  
 Engº Civil - CREA 53900/D - CE



PREFEITURA MUNICIPAL DE MILHÃ - CE	
ADEQUAÇÃO DE ESTRADAS VICINAIS NO MUNICÍPIO DE MILHÃ / CE	
<b>CE 371 A ASSUNÇÃO - ESTAQUEAMENTO E PERFIL LONGITUDINAL</b>	
PROJETISTA:	ENG. CIVIL ARTHUR MOREIRA TORQUATO - CREA 53.900D-CE
ARQUIVO:	MILHÃ_REC ESTRADA ASSUNÇÃO_GEO_R1.DWG

PRANCHA:	<b>15 / 20</b>
ESCALA:	1/1000

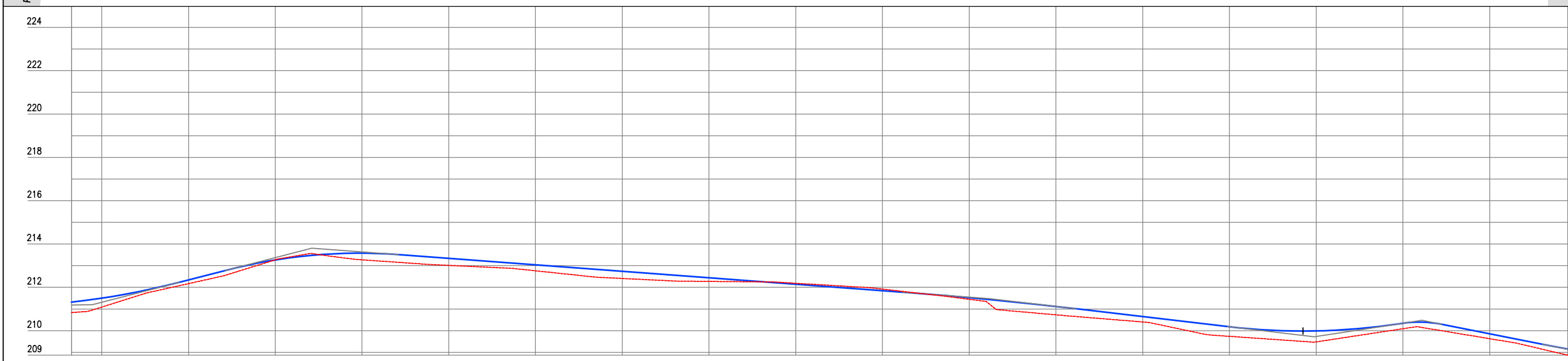
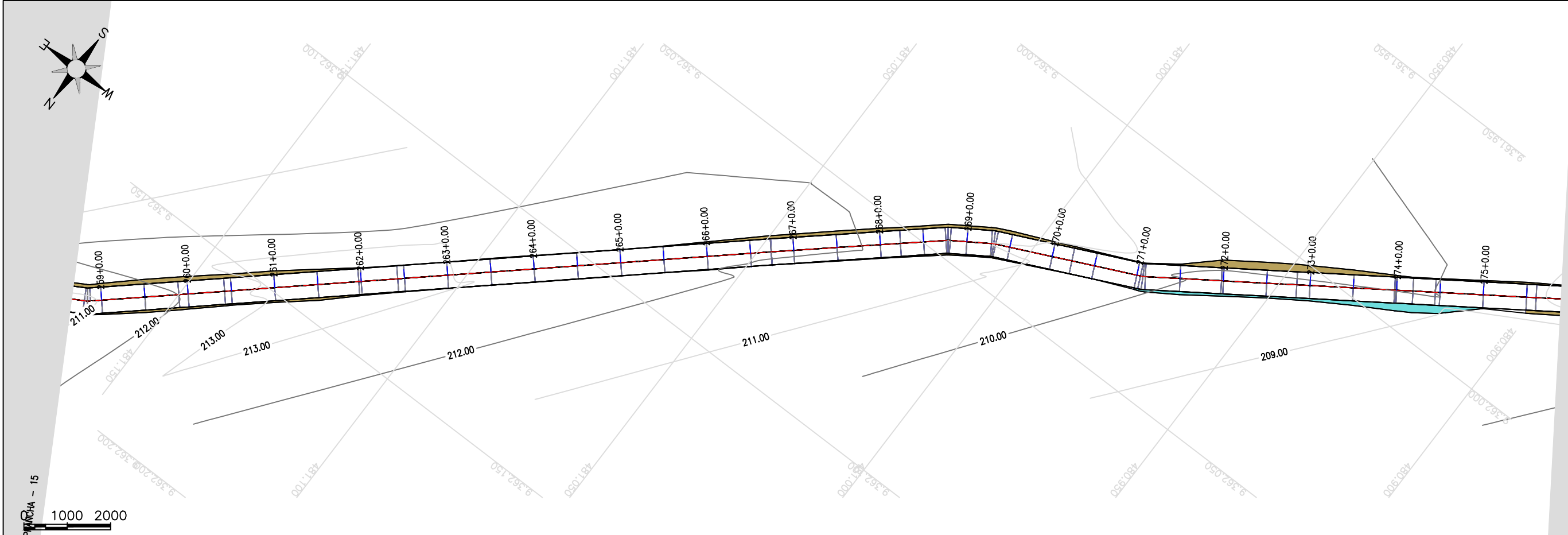

Estaca	258	259	260	261	262	263	264	265	266	267	268	269	270	271	272	273	274	275	
Cota do terreno	210,836	211,089	212,171	213,270	213,271	213,015	212,764	212,409	212,274	212,187	211,918	211,449	210,731	210,402	209,738	209,481	210,090	209,630	209,870
Cota da terraplenagem	211,316	211,501	212,344	213,263	213,577	213,338	213,040	212,742	212,444	212,146	211,848	211,524	211,117	210,648	210,178	209,990	210,342	209,854	209,151
Cota vermelha	0,480	0,412	0,173	-0,008	0,306	0,323	0,276	0,332	0,170	-0,042	-0,070	0,076	0,386	0,246	0,440	0,508	0,253	0,225	0,281

	<p>JOTA BARROS PROJETOS Arthur Moreira Torquato Engº Civil - CREA 53900/D - CE</p>	<p>PREFEITURA MUNICIPAL DE MILHÃ - CE</p> <p>ADEQUAÇÃO DE ESTRADAS VICINAIS NO MUNICÍPIO DE MILHÃ / CE</p> <p><b>CE 371 A ASSUNÇÃO - ESTAQUEAMENTO E PERFIL LONGITUDINAL</b></p> <p>PROJETISTA: ENG. CIVIL ARTHUR MOREIRA TORQUATO - CREA 53.900D-CE</p> <p>ARQUIVO: MILHÃ_REC ESTRADA ASSUNÇÃO_GEO_R1.DWG</p>	<p>PRANCHA:</p> <p><b>16 / 20</b></p> <p>ESCALA:</p> <p><b>1/1000</b></p>
--	--	--	---



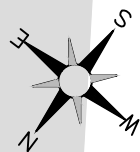

PRANCHA - 16  
0 1000 2000

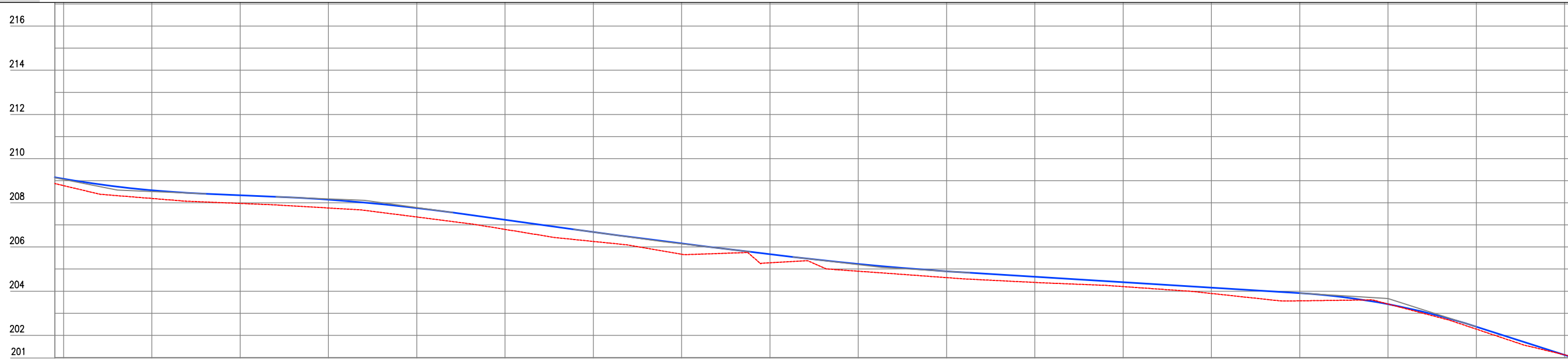
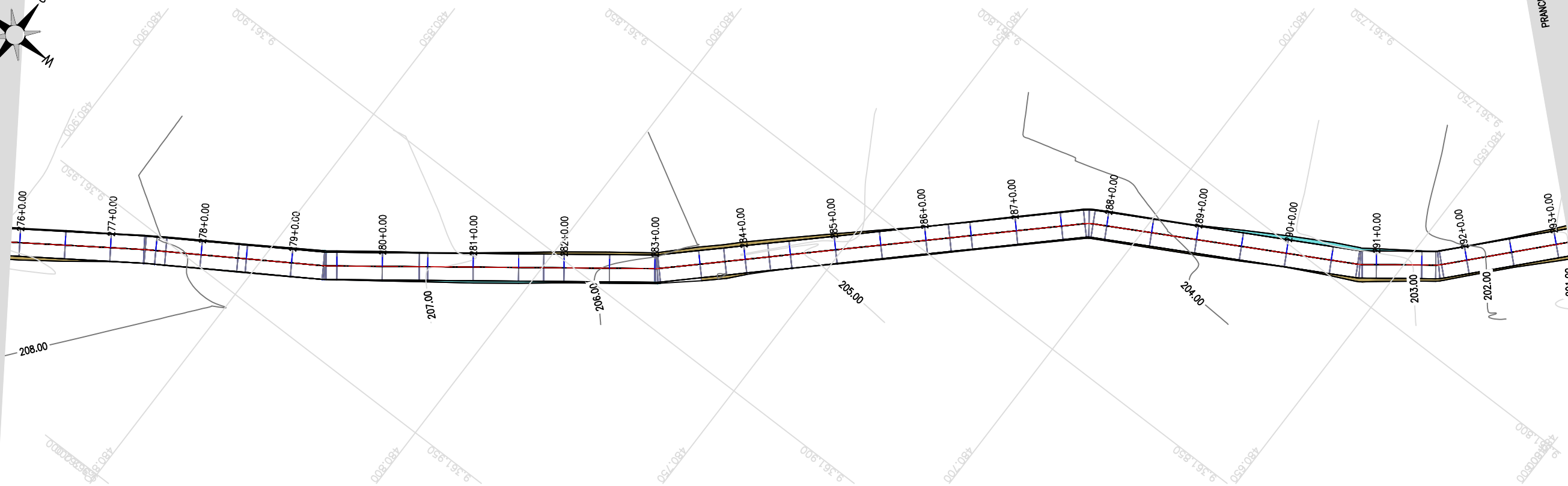

Cota vermelha	Cota da terraplenagem	Cota do terreno	Estaca
0,291	209,151	208,670	275
0,306	209,082	208,776	276
0,370	208,567	208,197	277
0,371	208,342	207,972	278
0,378	208,143	207,765	279
0,408	207,766	207,358	280
0,434	207,230	206,797	281
0,428	206,679	206,251	282
0,486	206,157	205,671	283
0,368	205,673	205,285	284
0,330	205,233	204,903	285
0,288	204,901	204,613	286
0,256	204,651	204,395	287
0,198	204,406	204,207	288
0,265	204,160	203,896	289
0,352	203,915	203,563	290
-0,008	203,411	203,419	291
0,109	202,390	202,281	292
-0,007	201,111	201,118	293
-0,054	200,919	200,973	293

JOTA BARROS PROJETOS  
 Arthur Moreira Torquato  
 Engº Civil - CREA 53900/D - CE



PREFEITURA MUNICIPAL DE MILHÃ - CE  
 ADEQUAÇÃO DE ESTRADAS VICINAIS NO MUNICÍPIO DE MILHÃ / CE  
**CE 371 A ASSUNÇÃO - ESTAQUEAMENTO E PERFIL LONGITUDINAL**  
 PROJETA: ENG. CIVIL ARTHUR MOREIRA TORQUATO - CREA 53.900D-CE  
 ARQUIVO: MILHÃ\_REC ESTRADA ASSUNÇÃO\_GEO\_R1.DWG

PRANCHA:  
**17 / 20**  
 ESCALA:  
**1/1000**

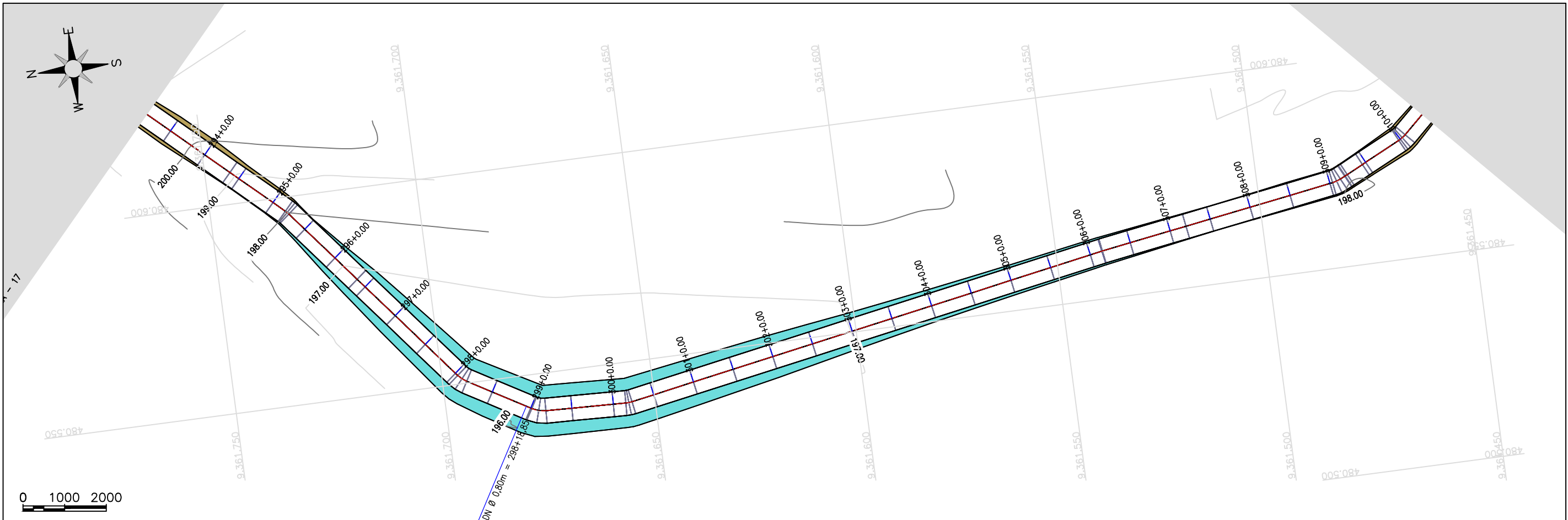

ESTRADA

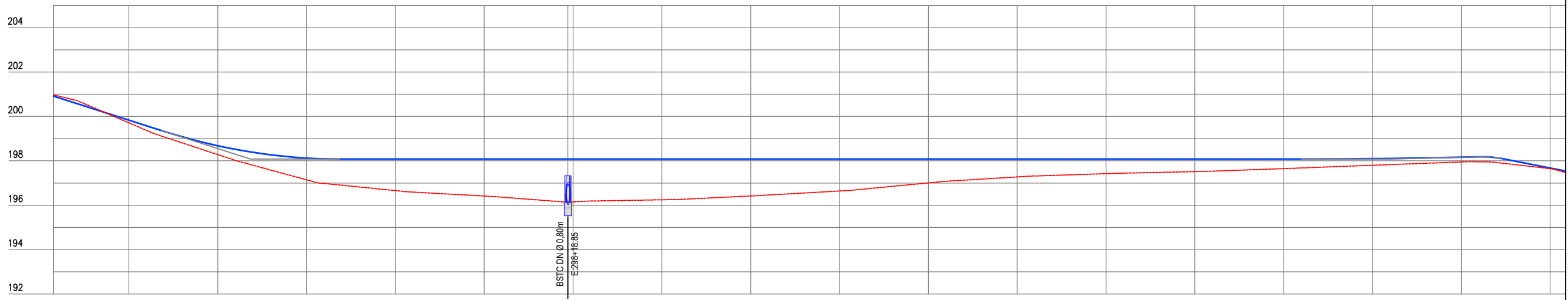

Estaca	283	294	295	296	297	298	298+18.85	300	301	302	303	304	305	306	307	308	309	310
Cota do terreno	200,973	199,710	198,290	197,144	196,658	196,415	196,138	196,245	196,418	196,642	197,005	197,275	197,421	197,514	197,649	197,800	197,949	197,645
Cota da terraplenagem	200,919	199,832	198,680	198,124	198,080	198,080	198,080	198,080	198,080	198,080	198,080	198,080	198,080	198,080	198,080	198,080	198,080	197,674
Cota vermelha	-0,054	0,121	0,400	0,980	1,422	1,665	1,950	1,835	1,662	1,438	1,075	0,805	0,659	0,566	0,431	0,297	0,216	0,029

TERRENO NATURAL    PROJETADO    ATERRO    CORTE    CURVAS DE NÍVEL

JOTA BARROS PROJETOS
   
 Arthur Moreira Torquato
   
 Engº Civil - CREA 53900/D - CE



PREFEITURA MUNICIPAL DE MILHÃ - CE

ADEQUAÇÃO DE ESTRADAS VICINAIS NO MUNICÍPIO DE MILHÃ / CE

**CE 371 A ASSUNÇÃO - ESTAQUEAMENTO E PERFIL LONGITUDINAL**

PROJETISTA:    ENG. CIVIL ARTHUR MOREIRA TORQUATO - CREA 53.900D-CE  
 ARQUIVO:        MILHÃ\_REC ESTRADA ASSUNÇÃO\_GEO\_R1.DWG

PRANCHA:

18 / 20

ESCALA:

1/1000

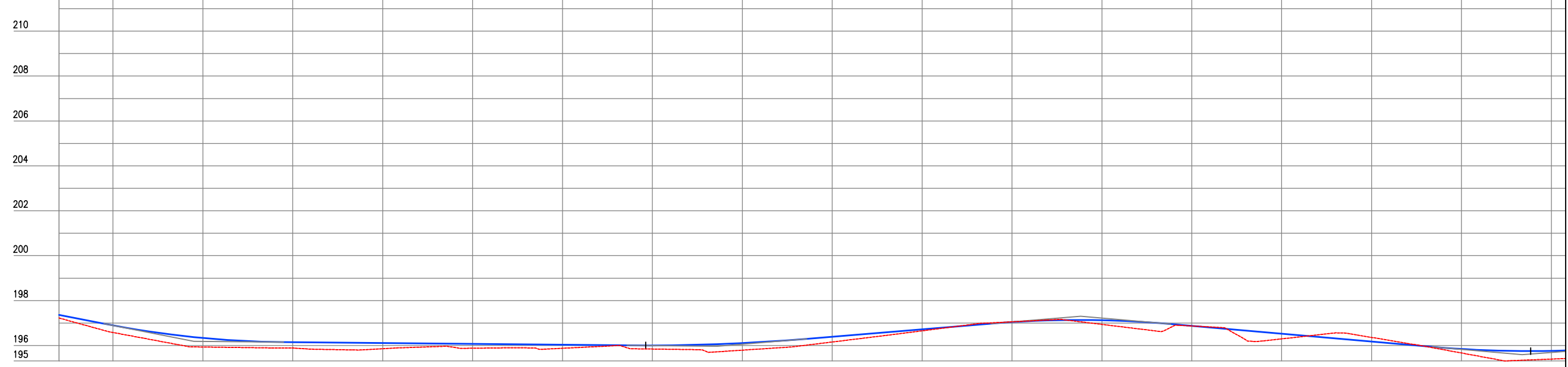
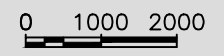
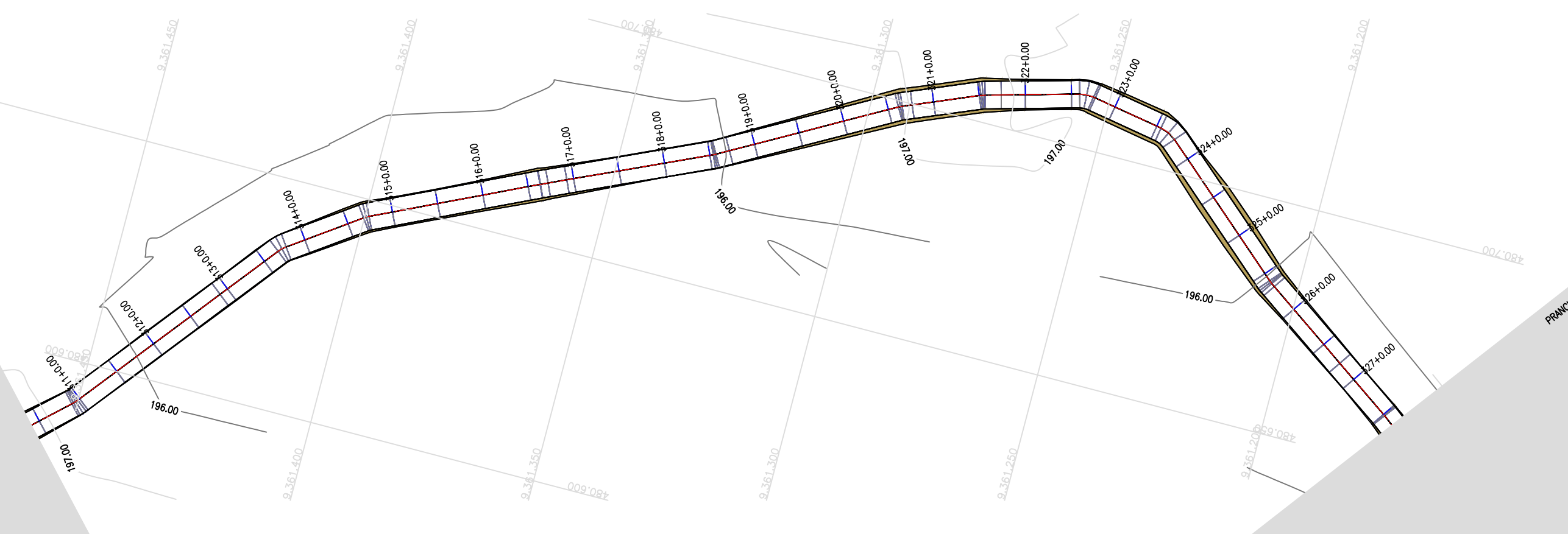
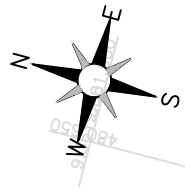

Estaca	Cota de terreno	Cota da terraplenagem	Cota vermelha
310	197,223	197,361	0,137
311	196,579	196,883	0,314
312	195,933	196,335	0,402
313	195,885	196,147	0,262
314	195,858	196,108	0,251
315	195,878	196,071	0,193
316	195,876	196,033	0,157
317	195,842	196,003	0,161
318	195,792	196,108	0,317
319	196,155	196,391	0,236
320	196,654	196,722	0,067
321	197,054	197,042	-0,011
322	196,940	197,123	0,184
323	196,868	196,874	0,005
324	196,295	196,525	0,230
325	196,360	196,177	-0,183
326	195,666	195,845	0,179
327	195,394	195,759	0,365

JOTA BARROS PROJETOS
   
 Arthur Moreira Torquato
   
 Engº Civil - CREA 53900/D - CE



PREFEITURA MUNICIPAL DE MILHÃ - CE		PRANCHA:
ADEQUAÇÃO DE ESTRADAS VICINAIS NO MUNICÍPIO DE MILHÃ / CE		
CE 371 A ASSUNÇÃO - ESTAQUEAMENTO E PERFIL LONGITUDINAL		19 / 20
PROJETISTA:	ENG. CIVIL ARTHUR MOREIRA TORQUATO - CREA 53.900D-CE	
ARQUIVO:	MILHÃ_REC ESTRADA ASSUNÇÃO_GEO_R1.DWG	
		ESCALA:
		1/1000



0 1000 2000

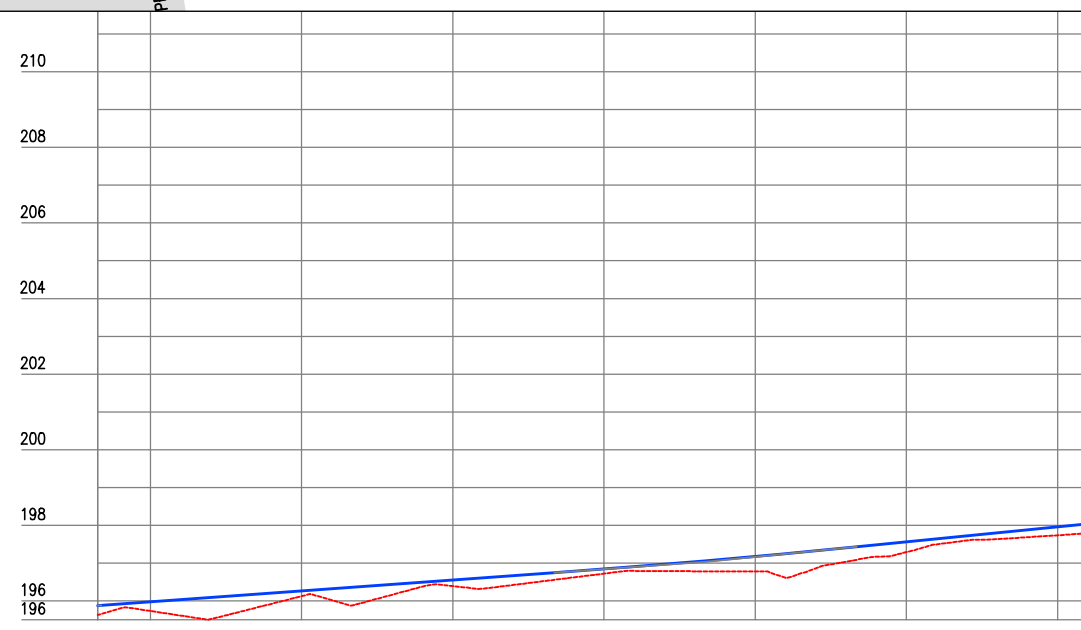
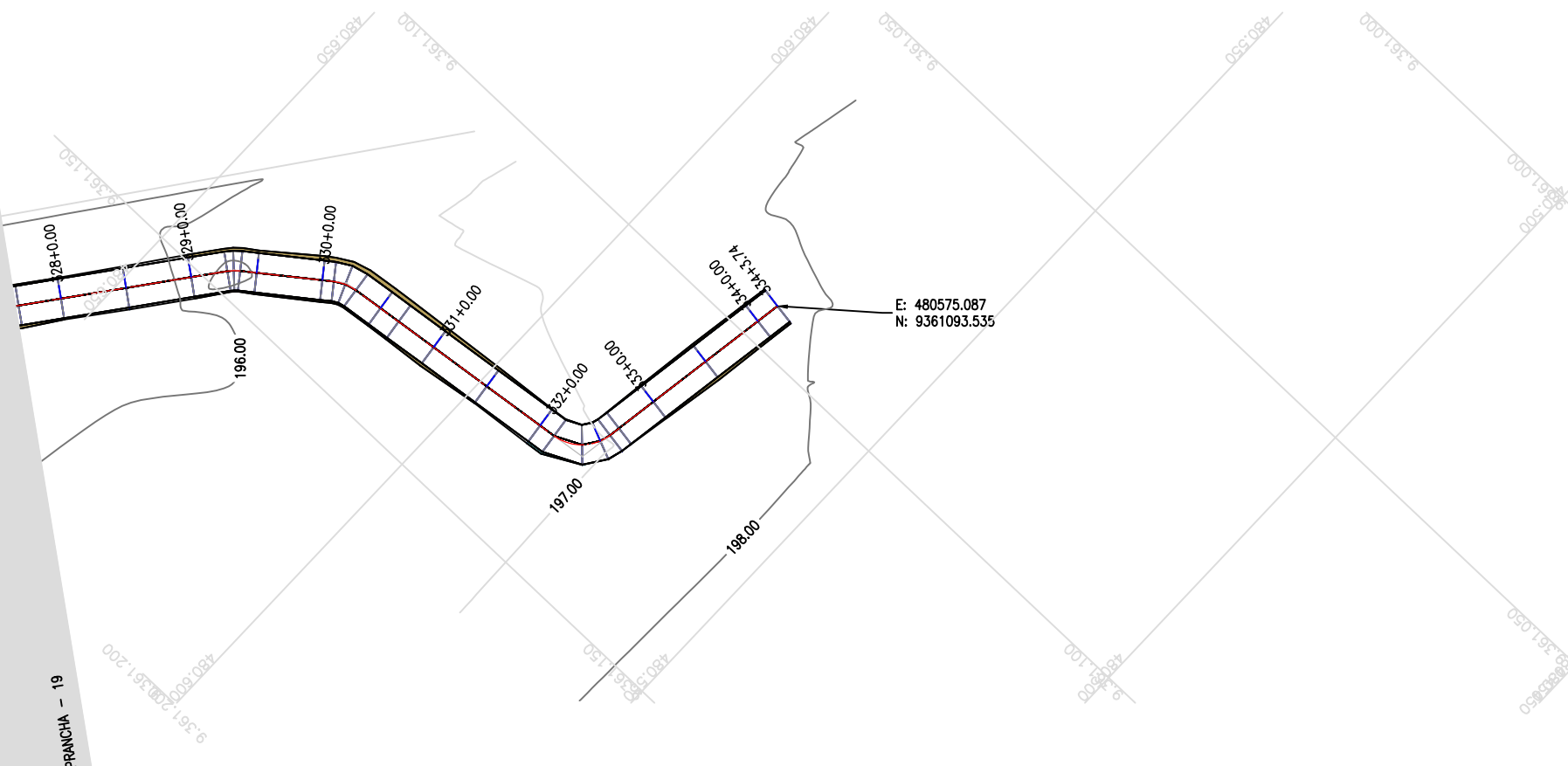

Estaca	Cota do terreno	Cota da terraplenagem	Cota vermelha
327	195,631	195,874	0,243
328	195,736	195,975	0,239
329	196,129	196,264	0,135
330	196,395	196,553	0,157
331	196,724	196,844	0,120
332	196,780	197,176	0,398
333	197,293	197,564	0,271
334	197,738	197,962	0,224
334	197,786	198,036	0,250

JOTA BARROS PROJETOS  
 Arthur Moreira Torquato  
 Engº Civil - CREA 53900/D - CE



**PREFEITURA MUNICIPAL DE MILHÃ - CE**  
**ADEQUAÇÃO DE ESTRADAS VICINAIS NO MUNICÍPIO DE MILHÃ / CE**  
**CE 371 A ASSUNÇÃO - ESTAQUEAMENTO E PERFIL LONGITUDINAL**

PROJETA: ENG. CIVIL ARTHUR MOREIRA TORQUATO - CREA 53.900D-CE  
 ARQUIVO: MILHÃ\_REC ESTRADA ASSUNÇÃO\_GEO\_R1.DWG

PRANCHA:  
**20 / 20**  
 ESCALA:  
**1/1000**