

E: 480051.192
N: 9360571.476

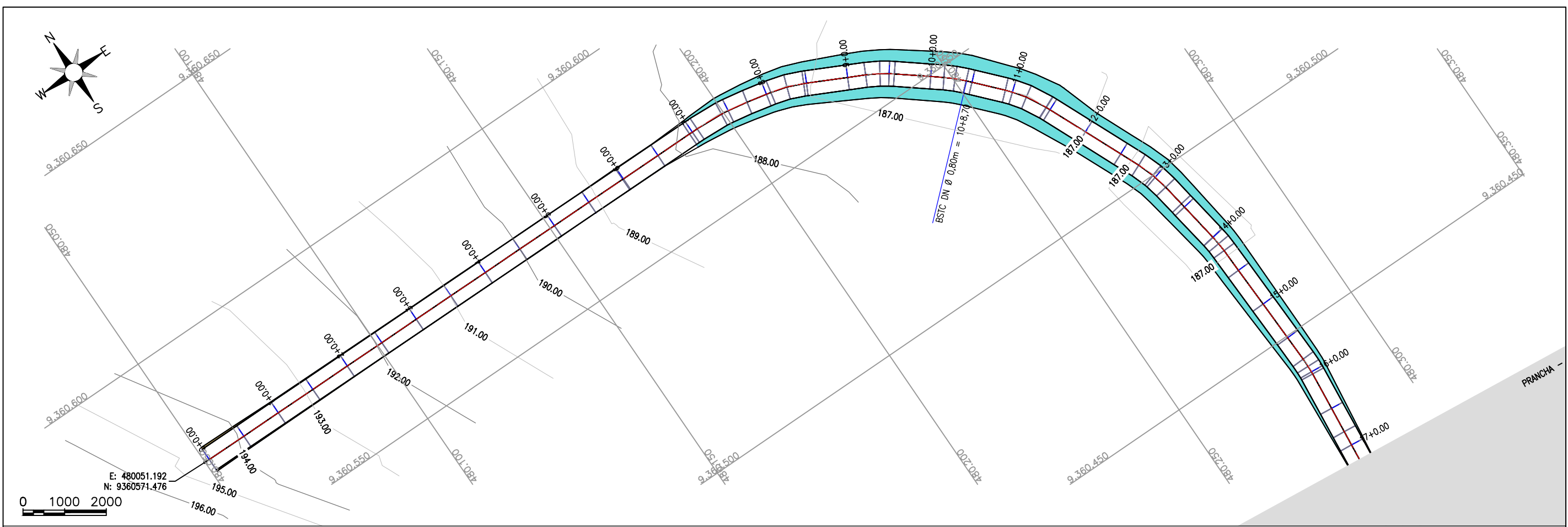

ESTRADA

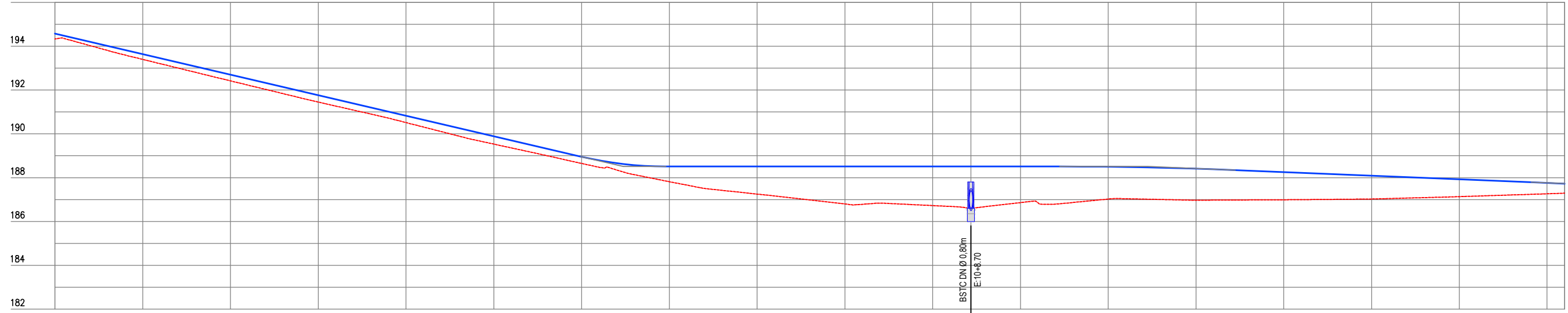

Estaca	0	1	2	3	4	5	6	7	8	9	10	10+8,70	11	12	13	14	15	16	17
Cota do terreno	194,328	193,397	192,417	191,451	190,514	189,532	188,650	187,816	187,251	186,799	186,726	186,603	186,862	187,024	186,973	186,992	187,026	187,134	187,265
Cota da terraplenagem	194,578	193,641	192,704	191,767	190,830	189,893	188,956	188,511	188,511	188,511	188,511	188,511	188,511	188,498	188,412	188,256	188,091	187,927	187,728
Cota vermelha	0,250	0,244	0,286	0,316	0,316	0,360	0,306	0,695	1,260	1,711	1,785	1,908	1,649	1,475	1,439	1,264	1,065	0,793	0,498

JOTA BARROS PROJETOS
Arthur Moreira Torquato
Engº Civil - CREA 53900/D - CE



PREFEITURA MUNICIPAL DE MILHÃ - CE	
ADEQUAÇÃO DE ESTRADAS VICINAIS NO MUNICÍPIO DE MILHÃ / CE	
EST DIV DOS MUNICÍPIOS - ESTAQUEAMENTO E PERFIL LONGITUDINAL	
PROJETISTA:	ENG. CIVIL ARTHUR MOREIRA TORQUATO - CREA 53.900D-CE
ARQUIVO:	MILHÃ_EST DIV MUNIC_GEO_R0.DWG

PRANCHA:
1 / 07
ESCALA:
1/1000

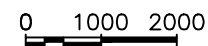
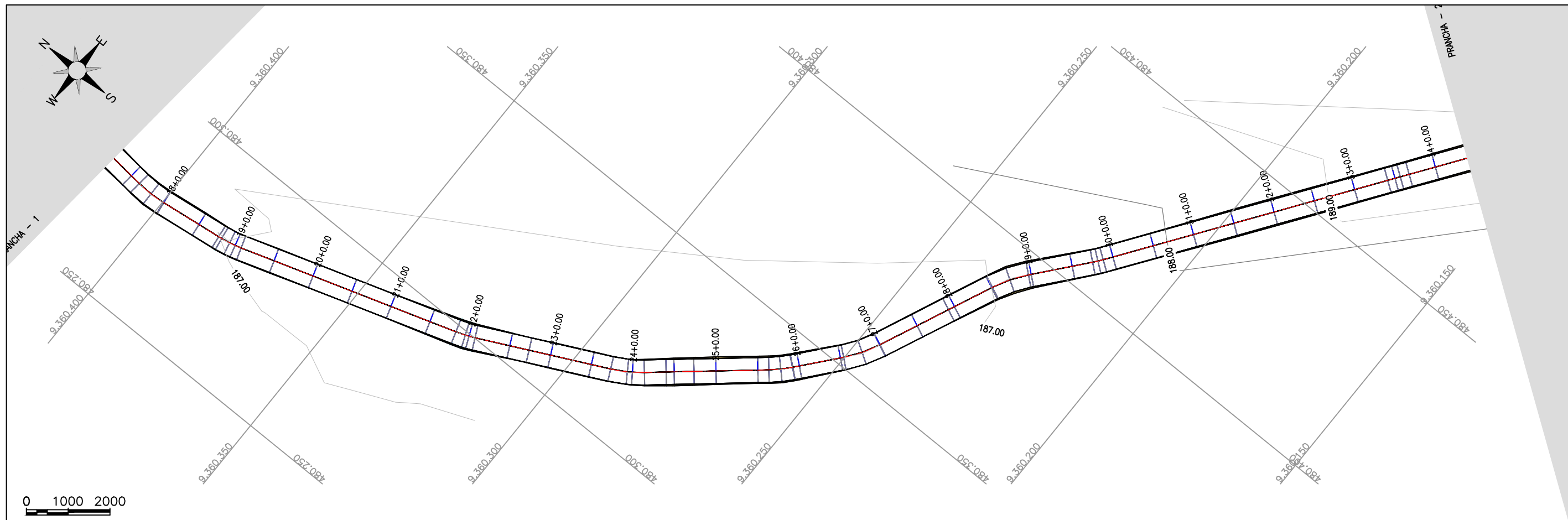

ESTRADA

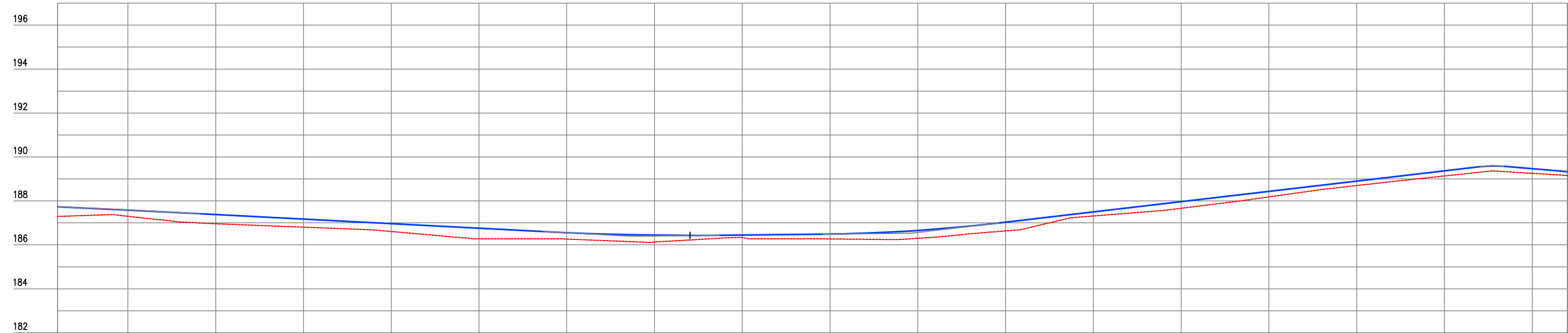

Estaca	17	18	19	20	21	22	23	24	25	26	27	28	29	30	31	32	33	34	34
Cota do terreno	187,292	187,300	186,961	186,806	186,609	186,272	186,262	186,127	186,329	186,269	186,299	186,635	187,314	187,664	188,182	188,698	189,136	189,256	189,157
Cota da terraplenagem	187,728	187,583	187,392	187,174	186,965	186,757	186,553	186,440	186,448	186,490	186,655	187,032	187,498	187,965	188,431	188,898	189,365	189,465	189,332
Cota vertical	0,436	0,283	0,421	0,368	0,357	0,485	0,291	0,313	0,119	0,221	0,356	0,397	0,184	0,301	0,249	0,200	0,228	0,210	0,174

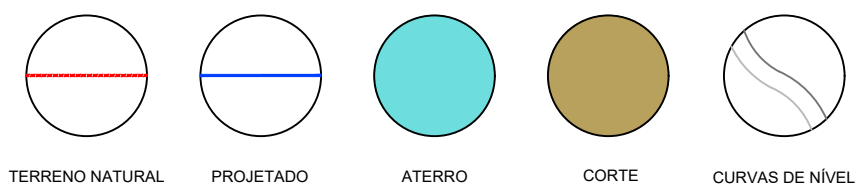

JOTA BARROS PROJETOS
 Arthur Moreira Torquato
 Engº Civil - CREA 53900/D - CE



PREFEITURA MUNICIPAL DE MILHÃ - CE	
ADEQUAÇÃO DE ESTRADAS VICINAIS NO MUNICÍPIO DE MILHÃ / CE	
EST DIV DOS MUNICÍPIOS - ESTAQUEAMENTO E PERFIL LONGITUDINAL	
PROJETISTA:	ENG. CIVIL ARTHUR MOREIRA TORQUATO - CREA 53.900D-CE
ARQUIVO:	MILHÃ_EST DIV MUNIC_GEO_R0.DWG

PRANCHA:
2 / 07
 ESCALA:
 1/1000

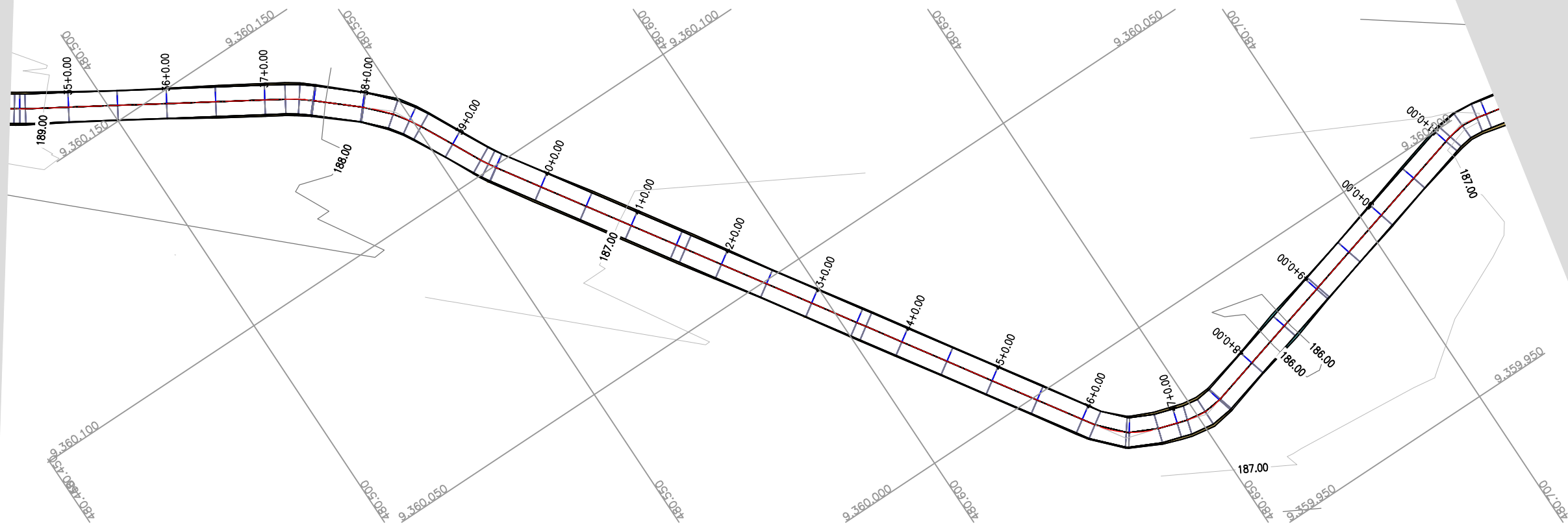

0 1000 2000
PRANCHA - 2

ESTRADA

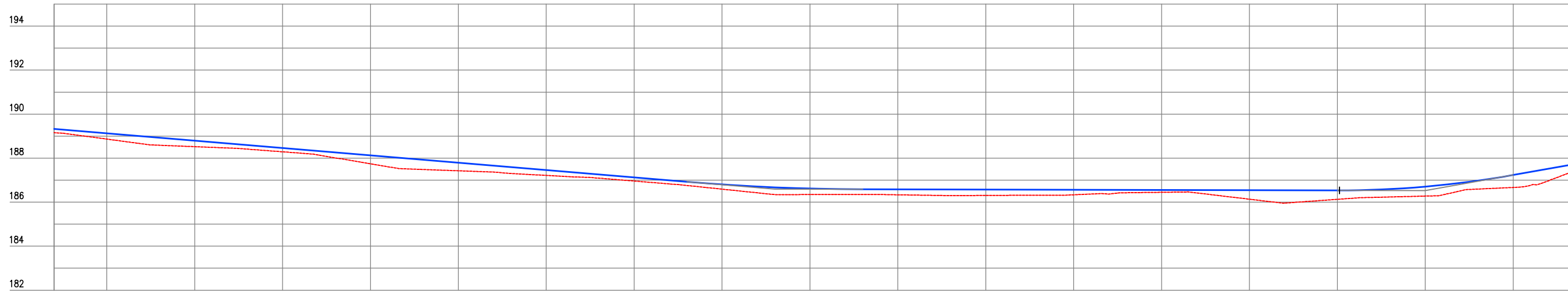

Estaca	Cota do terreno	Cota da terraplenagem	Cota vermelha
34	189,157	189,332	0,174
35	188,866	189,131	0,265
36	186,521	186,797	0,276
37	186,288	186,463	0,175
38	187,743	186,129	0,366
39	187,425	187,794	0,369
40	187,214	187,460	0,246
41	186,959	187,126	0,167
42	186,591	186,805	0,214
43	186,345	186,617	0,272
44	186,334	186,579	0,245
45	186,304	186,570	0,266
46	186,334	186,581	0,227
47	186,447	186,552	0,105
48	186,134	186,543	0,409
49	186,128	186,534	0,406
50	186,275	186,704	0,429
51	186,668	187,233	0,565
51	187,348	187,692	0,344

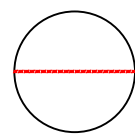

TERRENO NATURAL

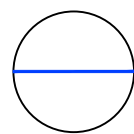

PROJETADO

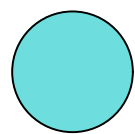

ATERRO

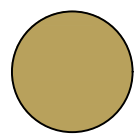

CORTE

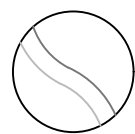

CURVAS DE NÍVEL

JOTA BARROS PROJETOS
Arthur Moreira Torquato
Engº Civil - CREA 53900/D - CE



PREFEITURA MUNICIPAL DE MILHÃ - CE

ADEQUAÇÃO DE ESTRADAS VICINAIS NO MUNICÍPIO DE MILHÃ / CE

EST DIV DOS MUNICÍPIOS - ESTAQUEAMENTO E PERFIL LONGITUDINAL

PROJETISTA: ENG. CIVIL ARTHUR MOREIRA TORQUATO - CREA 53.900D-CE

ARQUIVO: MILHÃ_EST DIV MUNIC_GEO_R0.DWG

PRANCHA:

3 / 07

ESCALA:

1/1000

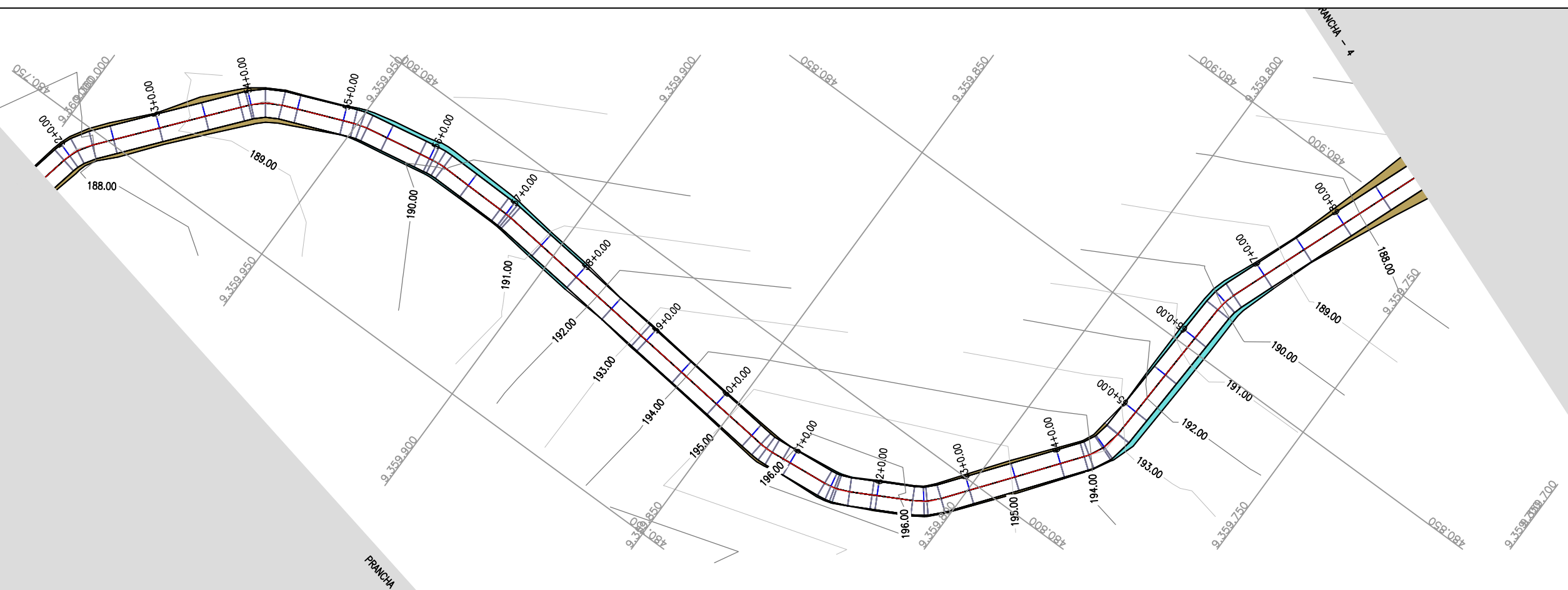
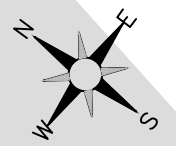

0 1000 2000

198 ESTRADA

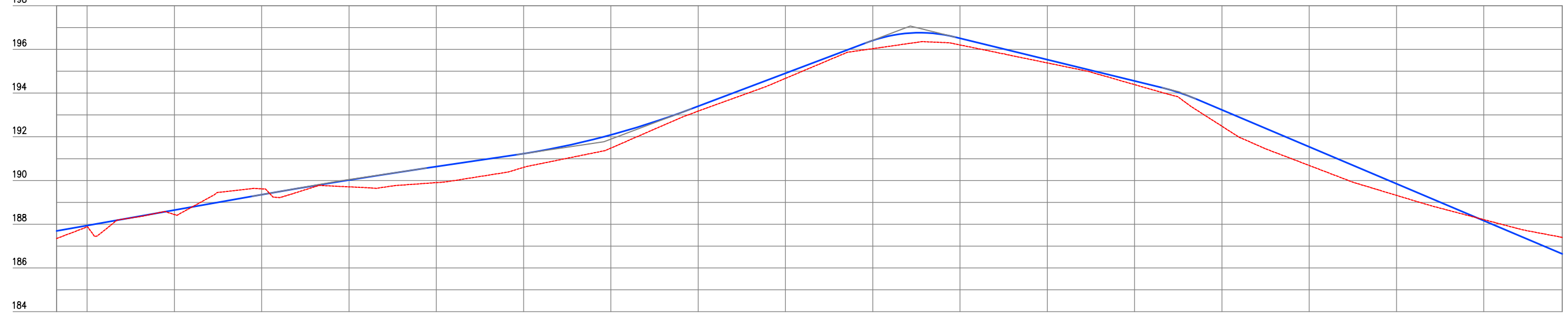

Estaca	51	52	53	54	55	56	57	58	59	60	61	62	63	64	65	66	67	68	69
Cota do terreno	187,348	187,881	188,444	189,620	189,711	189,905	190,602	191,484	193,174	194,673	196,034	196,202	195,390	194,387	192,487	190,690	189,323	188,212	187,400
Cota da terraplenagem	187,692	187,940	188,647	189,354	190,025	190,639	191,232	192,088	193,401	194,909	196,408	196,511	195,534	194,557	193,230	191,542	189,854	188,167	186,647
Cota vermelha	0,344	0,059	0,203	-0,266	0,314	0,735	0,630	0,604	0,227	0,236	0,374	0,309	0,154	0,170	0,743	0,852	0,532	-0,046	-0,752

JOTA BARROS PROJETOS
 Arthur Moreira Torquato
 Engº Civil - CREA 53900/D - CE



PREFEITURA MUNICIPAL DE MILHÃ - CE	
ADEQUAÇÃO DE ESTRADAS VICINAIS NO MUNICÍPIO DE MILHÃ / CE	
EST DIV DOS MUNICÍPIOS - ESTAQUEAMENTO E PERFIL LONGITUDINAL	
PROJETISTA:	ENG. CIVIL ARTHUR MOREIRA TORQUATO - CREA 53.900D-CE
ARQUIVO:	MILHÃ_EST DIV MUNIC_GEO_R0.DWG

PRANCHA:
4 / 07
 ESCALA:
 1/1000

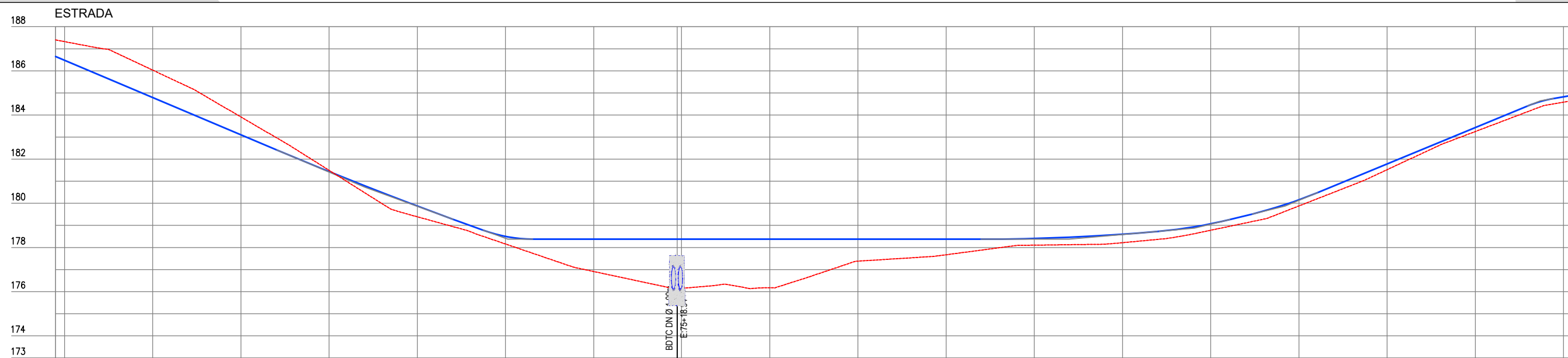
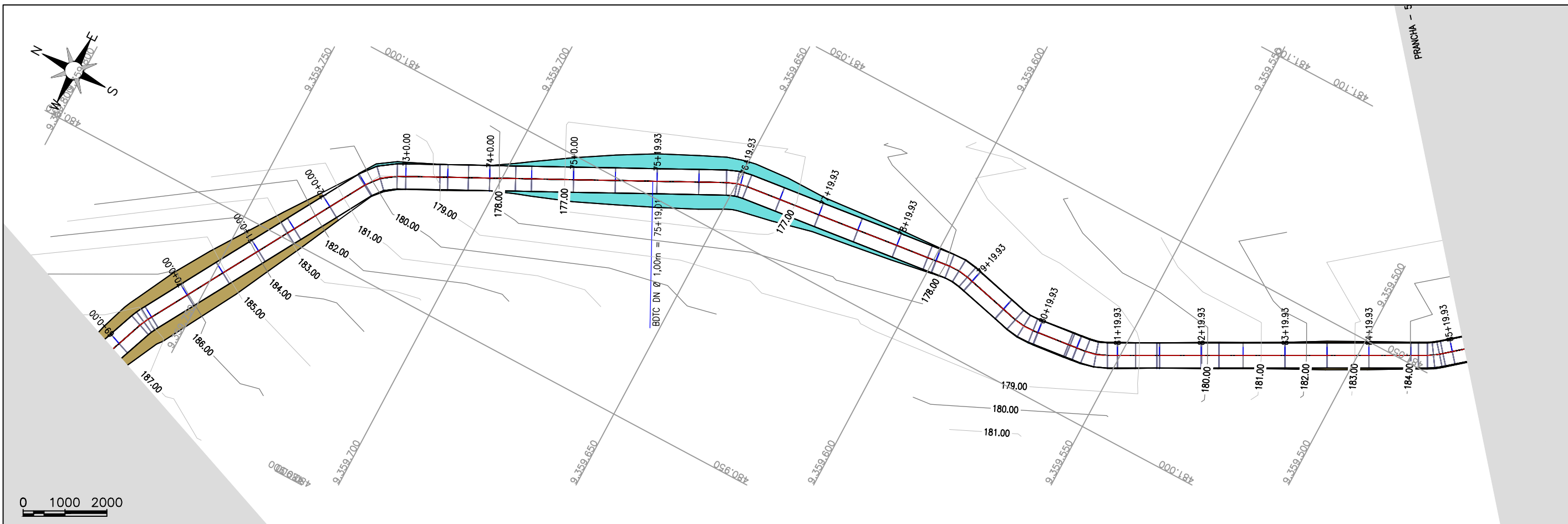

Estaca	08	09	70	71	72	73	74	75	76	77	78	79	80	81	82	83	84	85	86
Cota da terreno	187,400	187,324	186,032	183,911	181,433	179,390	178,156	176,912	176,125	176,178	177,380	177,670	178,105	178,217	178,780	179,882	181,523	183,252	184,577
Cota da terraplenagem	186,647	186,479	184,791	183,103	181,436	179,877	178,499	178,375	178,375	178,375	178,375	178,375	178,407	178,601	179,072	180,156	181,784	183,430	184,931
Cota vermelha	-0,752	-0,845	-1,241	-0,808	-0,056	0,487	0,341	1,463	2,251	2,198	0,995	0,705	0,303	0,384	0,282	0,277	0,261	0,178	0,248

JOTA BARROS PROJETOS

 Arthur Moreira Torquato

 Engº Civil - CREA 53900/D - CE



PREFEITURA MUNICIPAL DE MILHÃ - CE

 ADEQUAÇÃO DE ESTRADAS VICINAIS NO MUNICÍPIO DE MILHÃ / CE

EST DIV DOS MUNICÍPIOS - ESTAQUEAMENTO E PERFIL LONGITUDINAL

PROJETISTA:	ENG. CIVIL ARTHUR MOREIRA TORQUATO - CREA 53.900D-CE
ARQUIVO:	MILHÃ_EST DIV MUNIC_GEO_R0.DWG

PRANCHA:

5 / 07

 ESCALA:

1/1000

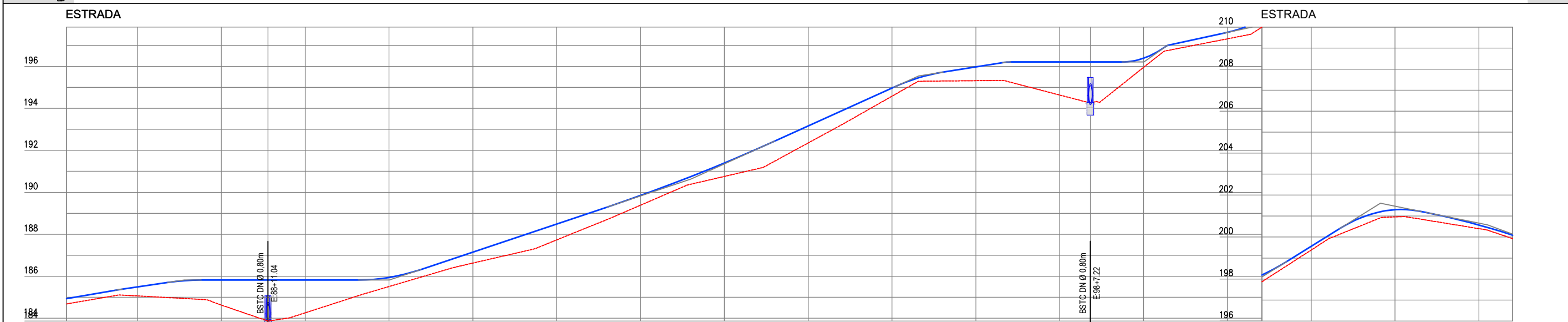
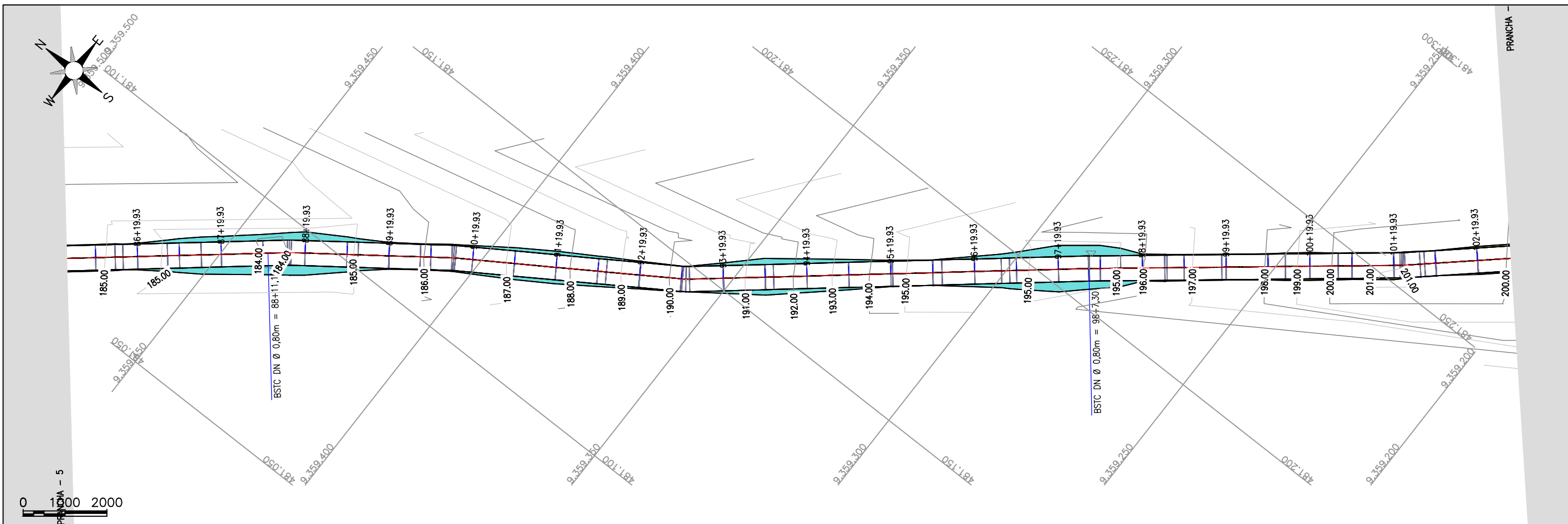

Cota vermelha	Cota da terraplenagem	Cota do terreno	Estaca
0,248	184,331	184,683	86
0,428	185,491	185,063	87
1,193	185,820	184,627	88
1,952	185,820	183,866	88+11,12
1,561	185,820	184,259	89
0,432	185,942	185,509	90
0,525	187,153	186,628	91
0,759	188,491	187,732	92
0,462	189,848	189,386	93
0,640	191,396	190,756	94
0,809	193,161	192,351	95
0,388	194,968	194,580	96
0,656	195,974	195,318	97
1,574	196,208	194,634	98
1,954	196,208	194,254	98+7,30
0,436	196,388	195,951	99
0,305	197,616	197,311	100
0,178	199,559	199,382	101
0,343	201,303	200,960	102
0,173	200,574	200,401	103
0,167	200,092	199,925	103

TERRENO NATURAL

PROJETADO

ATERRO

CORTE

CURVAS DE NÍVEL

JOTA BARROS PROJETOS
Arthur Moreira Torquato
Engº Civil - CREA 53900/D - CE

PREFEITURA MUNICIPAL DE MILHÃ - CE		PRANCHA: 6 / 07
ADEQUAÇÃO DE ESTRADAS VICINAIS NO MUNICÍPIO DE MILHÃ / CE		
EST DIV DOS MUNICÍPIOS - ESTAQUEAMENTO E PERFIL LONGITUDINAL		
PROJETISTA:	ENG. CIVIL ARTHUR MOREIRA TORQUATO - CREA 53.900D-CE	
ARQUIVO:	MILHÃ_EST DIV MUNIC_GEO_R0.DWG	
		ESCALA: 1/1000



0 1000 2000

ANCHA - 6

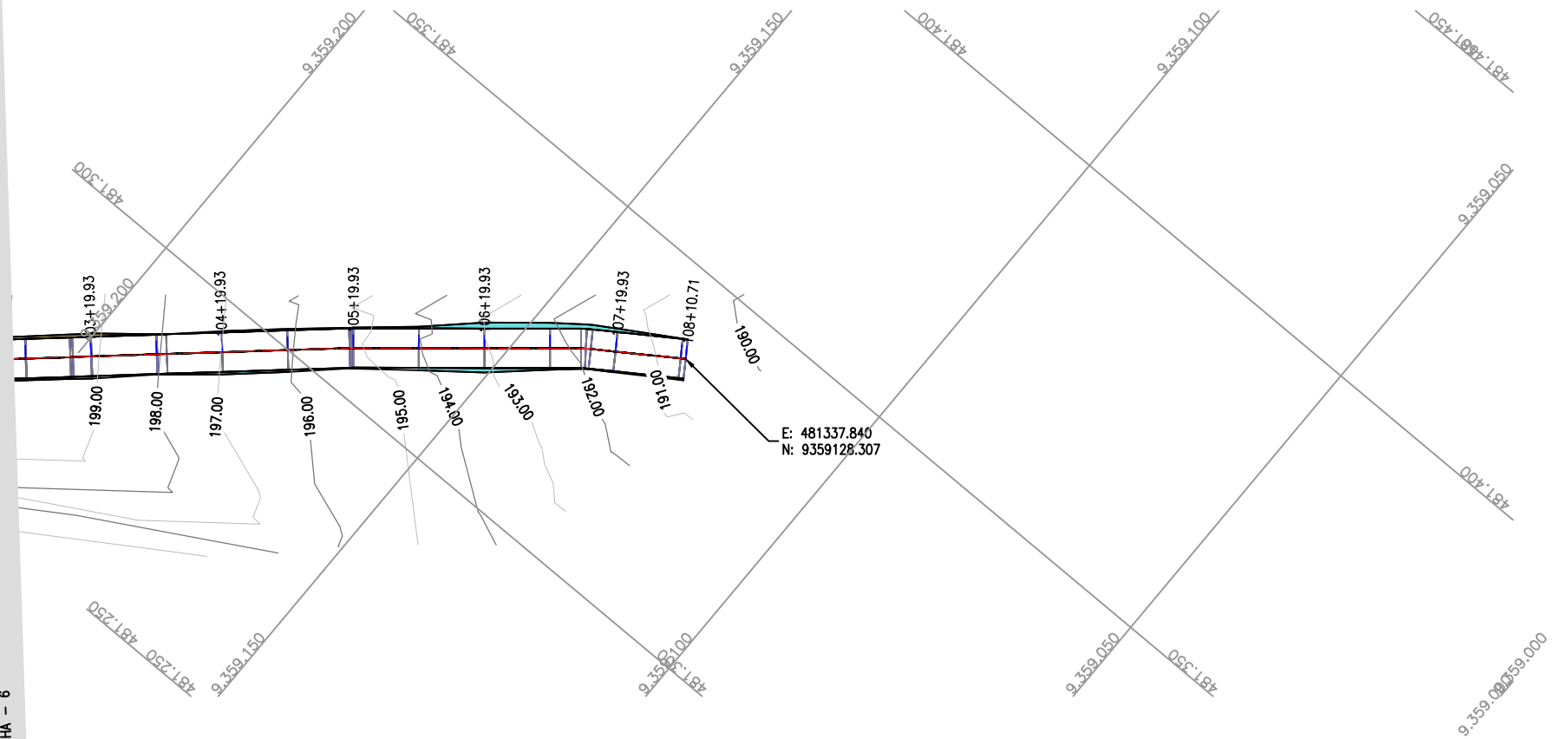

ESTRADA

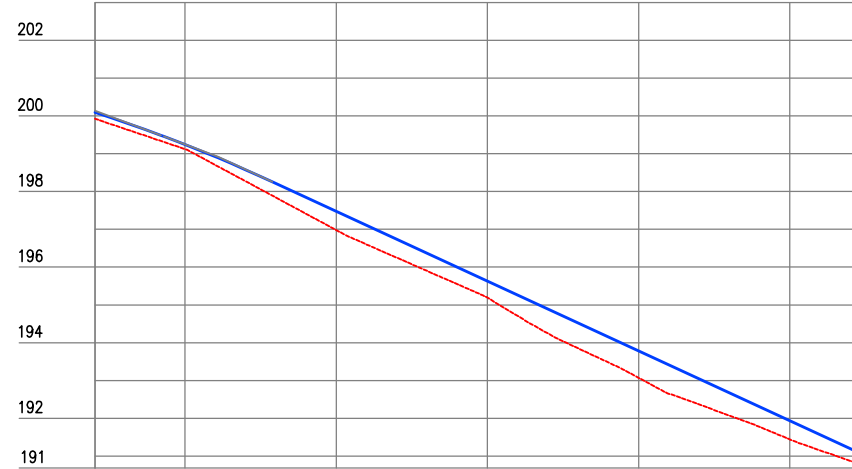

Cota vermelha	Cota da terraplenagem	Cota do terreno	Estaca
0,167	200,092	199,925	103
0,120	198,241	198,121	104
0,487	197,477	196,979	105
0,440	195,630	195,189	106
0,711	193,783	193,072	107
0,483	191,836	191,443	108
0,257	190,941	190,684	108

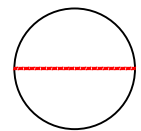

TERRENO NATURAL

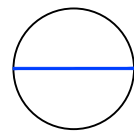

PROJETADO

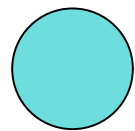

ATERRO

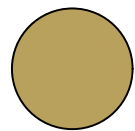

CORTE

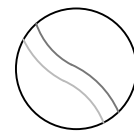

CURVAS DE NÍVEL

JOTA BARROS PROJETOS
Arthur Moreira Torquato
Engº Civil - CREA 53900/D - CE



PREFEITURA MUNICIPAL DE MILHÃ - CE

ADEQUAÇÃO DE ESTRADAS VICINAIS NO MUNICÍPIO DE MILHÃ / CE

EST DIV DOS MUNICÍPIOS - ESTAQUEAMENTO E PERFIL LONGITUDINAL

PROJETISTA: ENG. CIVIL ARTHUR MOREIRA TORQUATO - CREA 53.900D-CE

ARQUIVO: MILHÃ_EST DIV MUNIC_GEO_R0.DWG

PRANCHA:

7 / 07

ESCALA:

1/1000