

ESTRADA

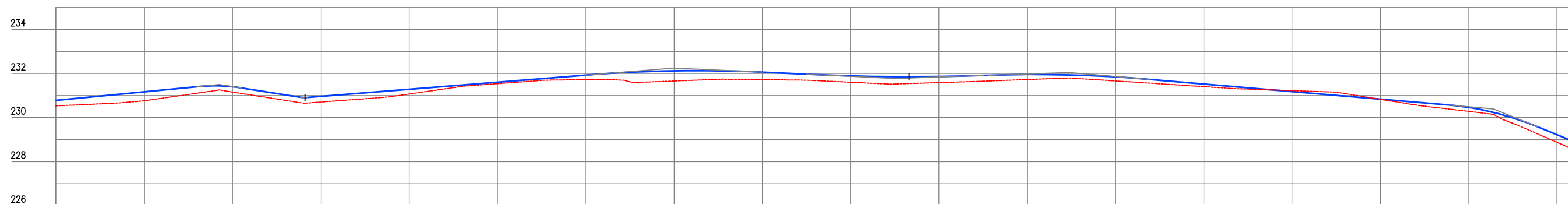

Estaca	0	1	2	3	4	5	6	7	8	9	10	11	12	13	14	15	16	17	
Cota do terreno	230,529	230,764	231,156	230,705	231,070	231,539	231,772	231,659	231,721	231,603	231,596	231,726	231,662	231,404	231,223	230,828	230,279	228,876	228,525
Cota da terraplenagem	230,779	231,170	231,397	230,960	231,282	231,605	231,927	232,122	232,060	231,890	231,684	231,955	231,846	231,522	231,178	230,835	230,459	229,218	228,891
Cota vermelha	0,250	0,406	0,239	0,254	0,213	0,066	0,206	0,463	0,339	0,288	0,277	0,230	0,184	0,117	-0,045	0,007	0,180	0,342	0,366

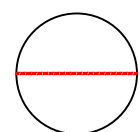

TERRENO NATURAL

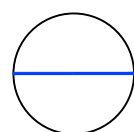

PROJETADO

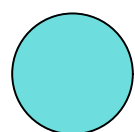

ATERRO



CORTE

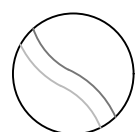

CURVAS DE NÍVEL

JOTA BARROS PROJETOS  
Arthur Moreira Torquato  
Engº Civil - CREA 53900/D - CE



PREFEITURA MUNICIPAL DE MILHÃ - CE

ADEQUAÇÃO DE ESTRADAS VICINAIS NO MUNICÍPIO DE MILHÃ / CE

BAIXA VERDE LADO E. - ESTAQUEAMENTO E PERFIL LONGITUDINAL

PROJETISTA: ENG. CIVIL ARTHUR MOREIRA TORQUATO - CREA 53.900D-CE

ARQUIVO: MILHÃ\_BAIXA VERDE LE\_GEO\_R0.DWG

PRANCHA:

1 / 19

ESCALA:

1/1000

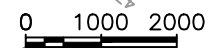
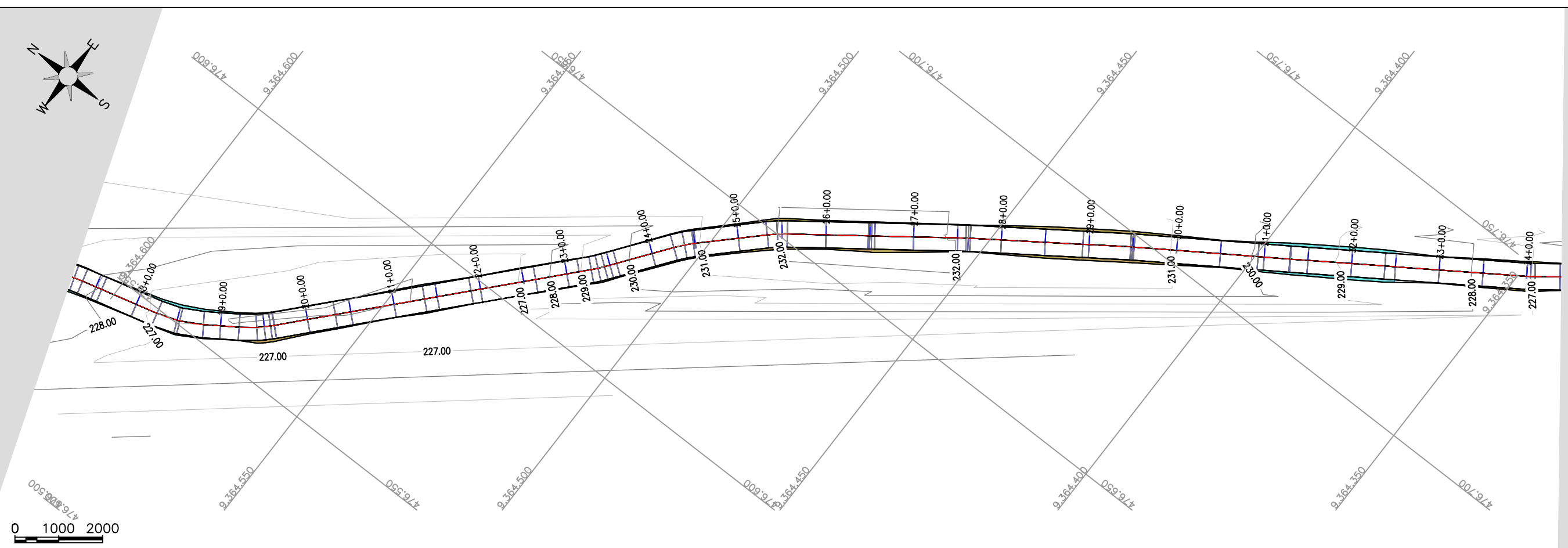
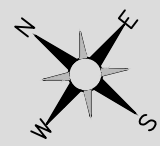

PRANCHA -

ESTRADA

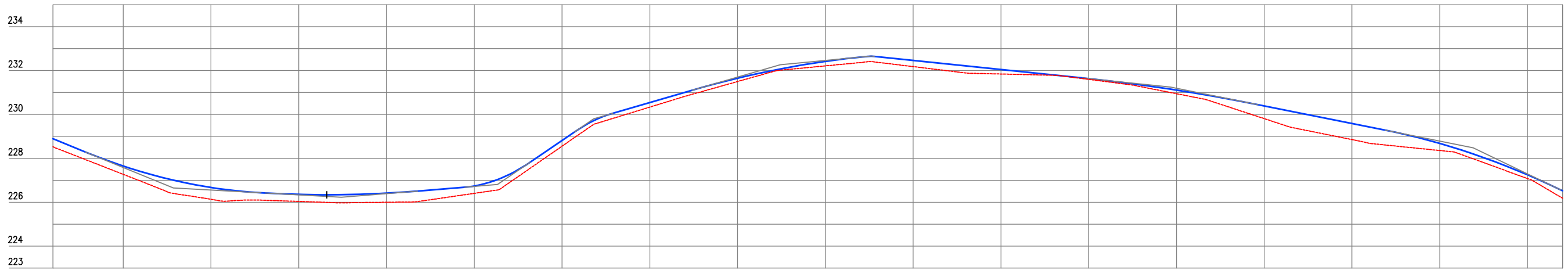

Estaca	17	18	19	20	21	22	23	24	25	26	27	28	29	30	31	32	33	34	34
Cota do terreno	226,525	227,272	226,133	226,036	225,997	226,404	226,554	230,335	231,499	232,212	232,190	231,843	231,598	230,945	229,810	228,855	226,356	227,078	226,184
Cota da terraplenagem	226,891	227,650	226,671	226,355	226,412	226,740	228,817	230,543	231,652	232,416	232,463	232,049	231,634	231,110	230,391	229,588	226,676	227,249	226,521
Cota vermelha	0,366	0,378	0,537	0,319	0,415	0,336	0,263	0,207	0,152	0,204	0,283	0,205	0,037	0,165	0,582	0,734	0,322	0,171	0,337

TERRENO NATURAL    PROJETADO    ATERRO    CORTE    CURVAS DE NÍVEL

JOTA BARROS PROJETOS  
 Arthur Moreira Torquato  
 Engº Civil - CREA 53900/D - CE



PREFEITURA MUNICIPAL DE MILHÃ - CE	
ADEQUAÇÃO DE ESTRADAS VICINAIS NO MUNICÍPIO DE MILHÃ / CE	
<b>BAIXA VERDE LADO E. - ESTAQUEAMENTO E PERFIL LONGITUDINAL</b>	
PROJETISTA:	ENG. CIVIL ARTHUR MOREIRA TORQUATO - CREA 53.900D-CE
ARQUIVO:	MILHÃ_BAIXA VERDE LE_GEO_R0.DWG

PRANCHA:  
**2 / 19**  
 ESCALA:  
 1/1000

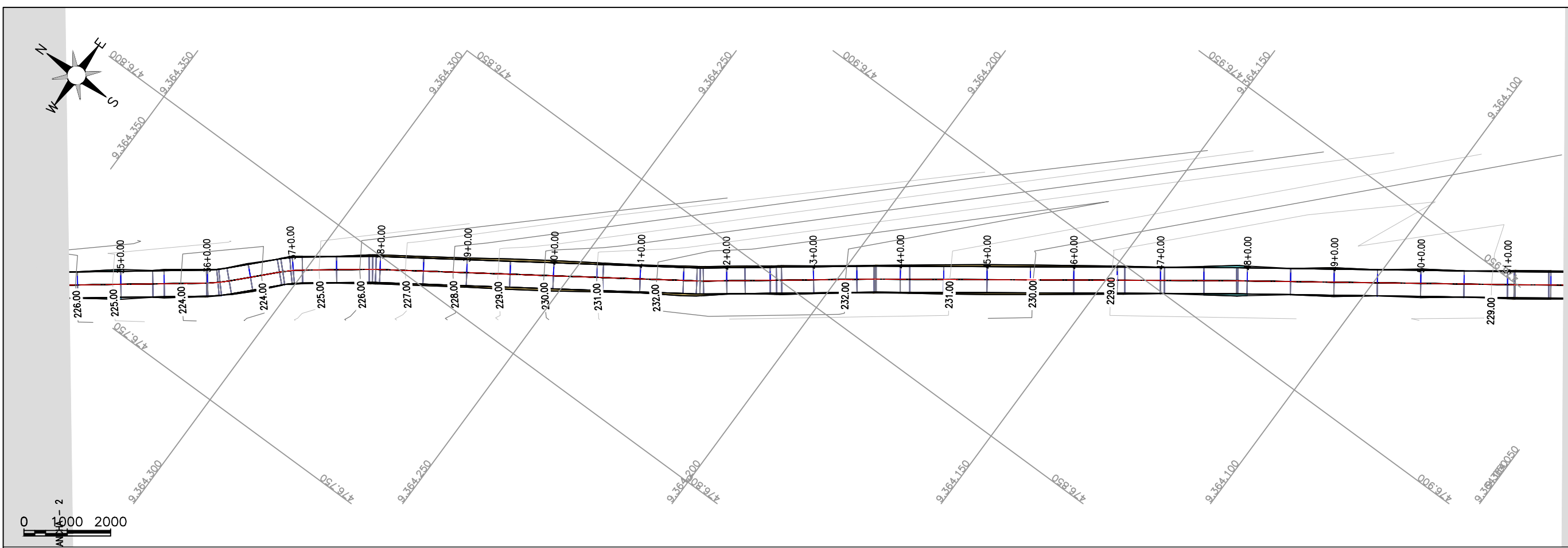

ESTRADA

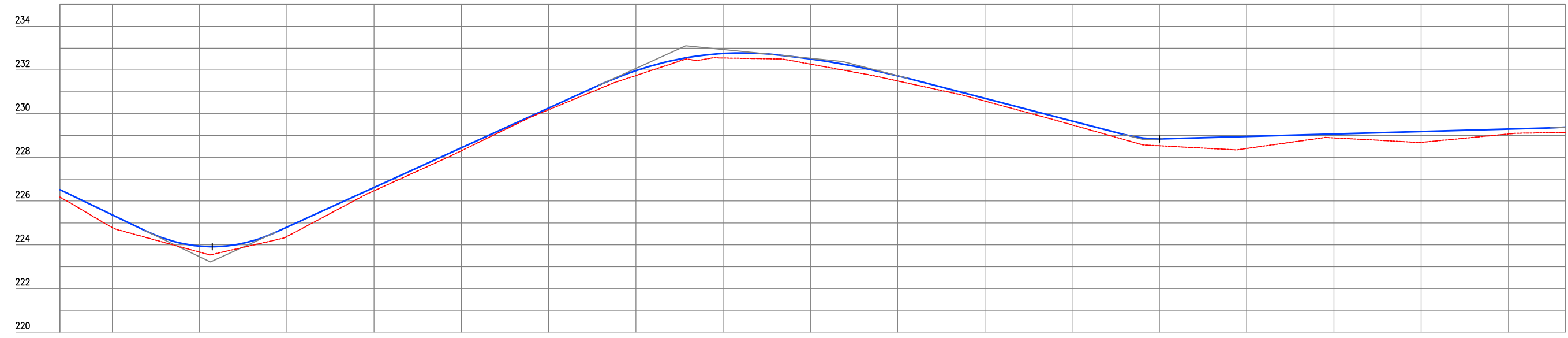

Cota Vermelha	Cota da terraplenagem	Cota do terreno	Estaca
0,337	226,521	226,184	34
0,586	225,367	224,781	35
0,276	223,938	223,662	36
0,427	224,801	224,373	37
0,147	226,618	226,471	38
0,132	228,434	228,303	39
0,072	230,251	230,180	40
0,221	231,967	231,745	41
0,207	232,755	232,549	42
0,238	232,508	232,270	43
0,236	231,734	231,488	44
0,125	230,700	230,576	45
0,179	229,664	229,485	46
0,313	228,842	228,528	47
0,547	228,952	228,406	48
0,173	229,065	228,893	49
0,493	229,179	228,686	50
0,222	229,292	229,070	51
0,247	229,386	229,139	51

JOTA BARROS PROJETOS  
 Arthur Moreira Torquato  
 Engº Civil - CREA 53900/D - CE



PREFEITURA MUNICIPAL DE MILHÃ - CE	
ADEQUAÇÃO DE ESTRADAS VICINAIS NO MUNICÍPIO DE MILHÃ / CE	
<b>BAIXA VERDE LADO E. - ESTAQUEAMENTO E PERFIL LONGITUDINAL</b>	
PROJETISTA:	ENG. CIVIL ARTHUR MOREIRA TORQUATO - CREA 53.900D-CE
ARQUIVO:	MILHÃ_BAIXA VERDE LE_GEO_R0.DWG

PRANCHA:	3 / 19
ESCALA:	1/1000

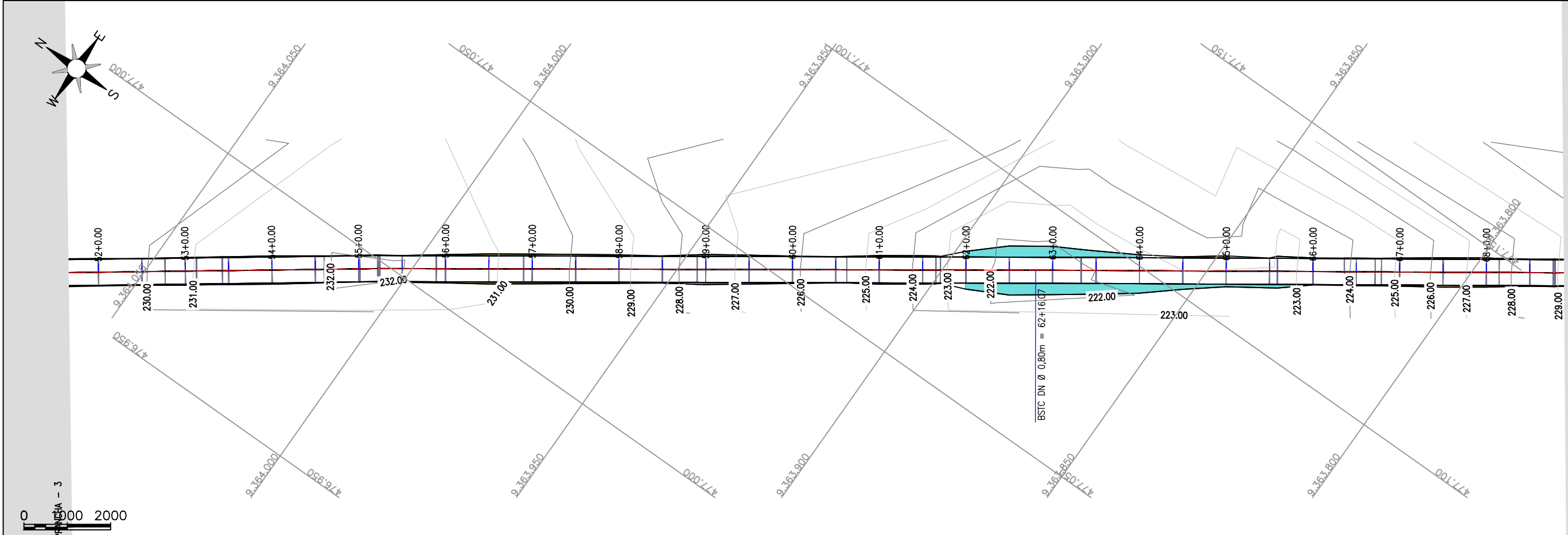

ESTRADA

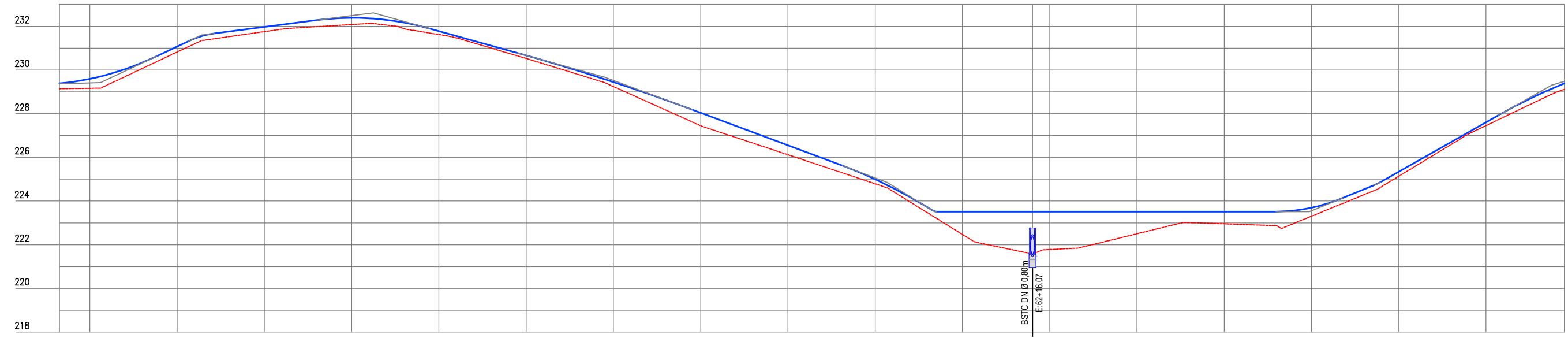

Cota Vermelha	Cota da terraplenagem	Cota do terreno	Estaca
0,247	229,386	229,139	51
0,431	229,592	229,161	52
0,250	231,070	230,820	53
0,213	231,969	231,756	54
0,307	232,386	232,079	55
0,157	231,779	231,622	56
0,141	230,669	230,528	57
0,204	229,447	229,243	58
0,589	228,036	227,447	59
0,428	226,549	226,121	60
0,204	224,994	224,790	61
1,045	223,516	222,471	62
1,950	223,516	221,566	62+16,07
1,734	223,516	221,782	63
1,014	223,516	222,502	64
0,559	223,516	222,957	65
0,389	223,693	223,304	66
0,210	225,342	225,133	67
0,149	227,601	227,452	68
0,274	229,385	229,111	68

JOTA BARROS PROJETOS  
 Arthur Moreira Torquato  
 Engº Civil - CREA 53900/D - CE



PREFEITURA MUNICIPAL DE MILHÃ - CE  
 ADEQUAÇÃO DE ESTRADAS VICINAIS NO MUNICÍPIO DE MILHÃ / CE  
**BAIXA VERDE LADO E. - ESTAQUEAMENTO E PERFIL LONGITUDINAL**  
 PROJETISTA: ENG. CIVIL ARTHUR MOREIRA TORQUATO - CREA 53.900D-CE  
 ARQUIVO: MILHÃ\_BAIXA VERDE LE\_GEO\_R0.DWG

PRANCHA:  
**4 / 19**  
 ESCALA:  
**1/1000**

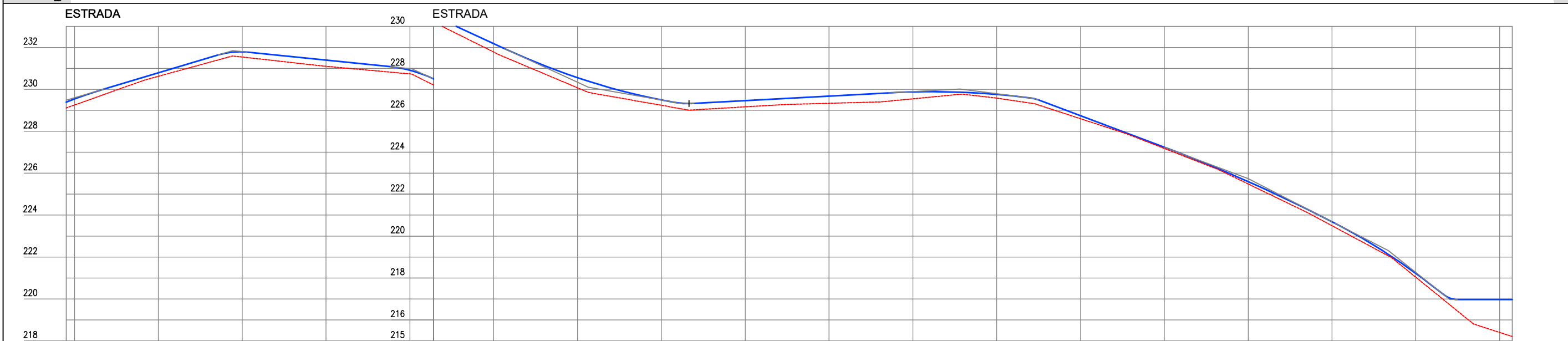
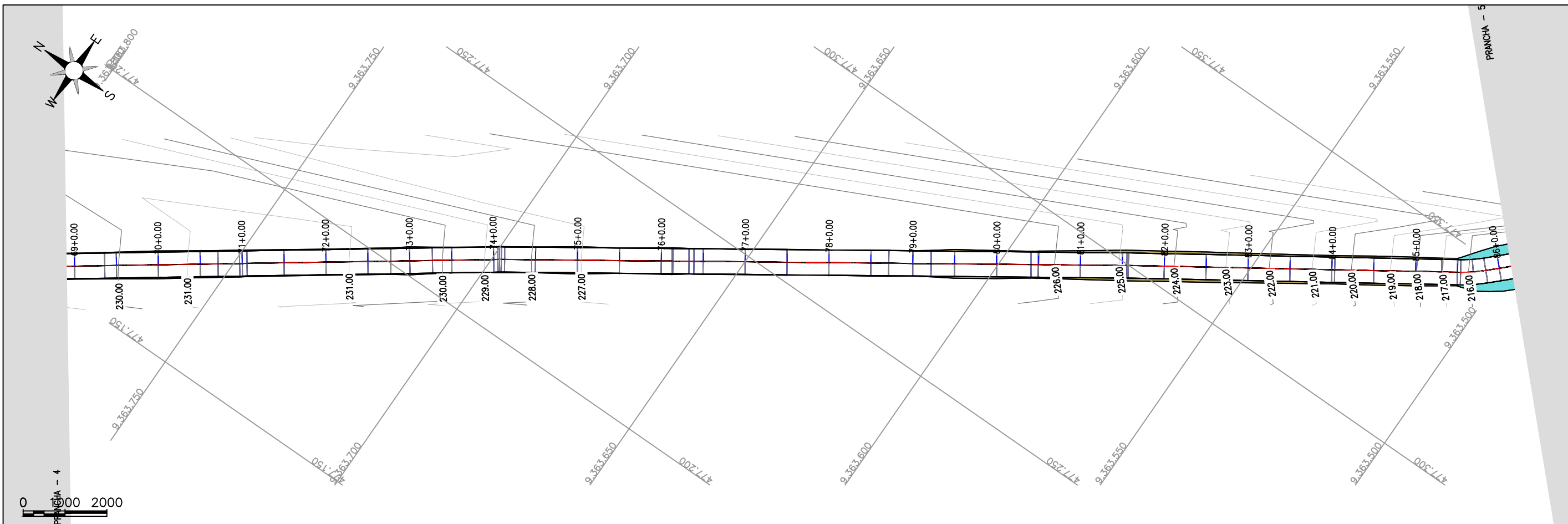

Estaca	08	09	70	71	72	73	74	75	76	77	78	79	80	81	82	83	84	85	86
Cota da terreno	229,111	229,253	230,622	231,541	231,099	230,736	228,780	227,073	226,239	226,164	226,333	226,548	226,580	225,597	224,180	222,486	220,494	218,035	215,403
Cota da terraplenagem	229,385	229,540	230,788	231,788	231,391	230,912	229,179	227,556	226,494	226,462	226,678	226,876	226,756	225,741	224,239	222,599	220,684	218,218	215,970
Cota vermelha	0,274	0,287	0,166	0,247	0,292	0,176	0,400	0,483	0,255	0,288	0,344	0,328	0,176	0,144	0,059	0,113	0,180	0,183	1,567

TERRENO NATURAL

PROJETADO

ATERRO

CORTE

CURVAS DE NÍVEL

JOTA BARROS PROJETOS  
 Arthur Moreira Torquato  
 Engº Civil - CREA 53900/D - CE

PREFEITURA MUNICIPAL DE MILHÃ - CE

ADEQUAÇÃO DE ESTRADAS VICINAIS NO MUNICÍPIO DE MILHÃ / CE

**BAIXA VERDE LADO E. - ESTAQUEAMENTO E PERFIL LONGITUDINAL**

PROJETISTA: ENG. CIVIL ARTHUR MOREIRA TORQUATO - CREA 53.900D-CE

ARQUIVO: MILHÃ\_BAIXA VERDE LE\_GEO\_R0.DWG

PRANCHA:

**5 / 19**

ESCALA:

**1/1000**

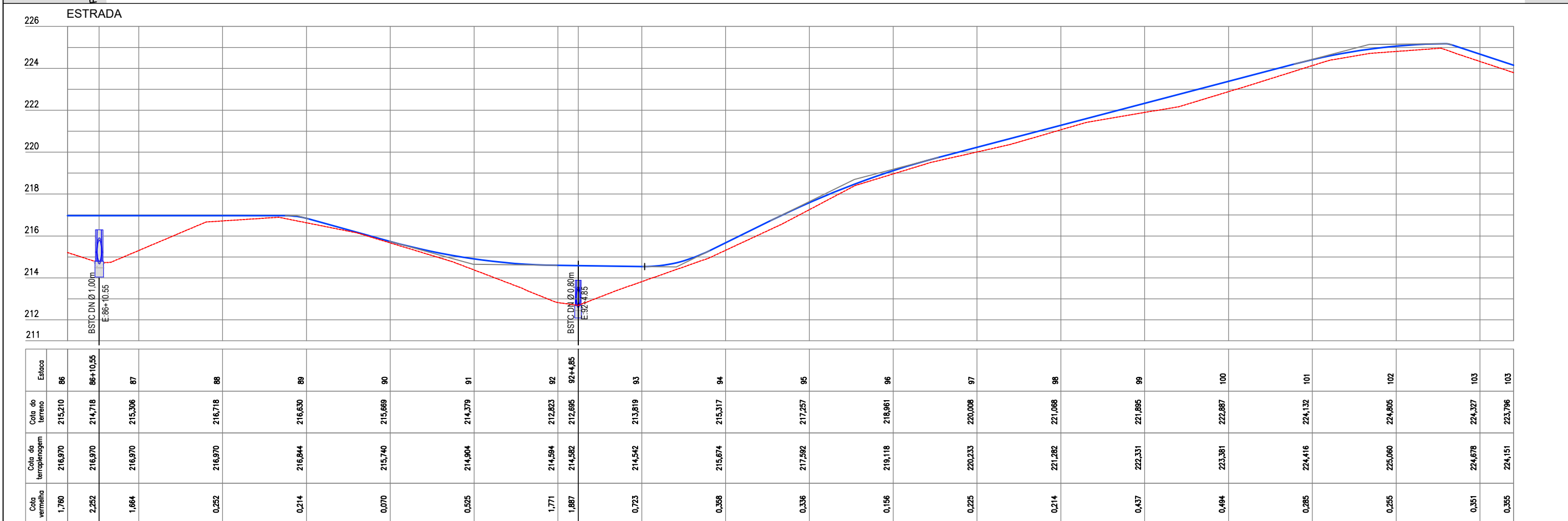
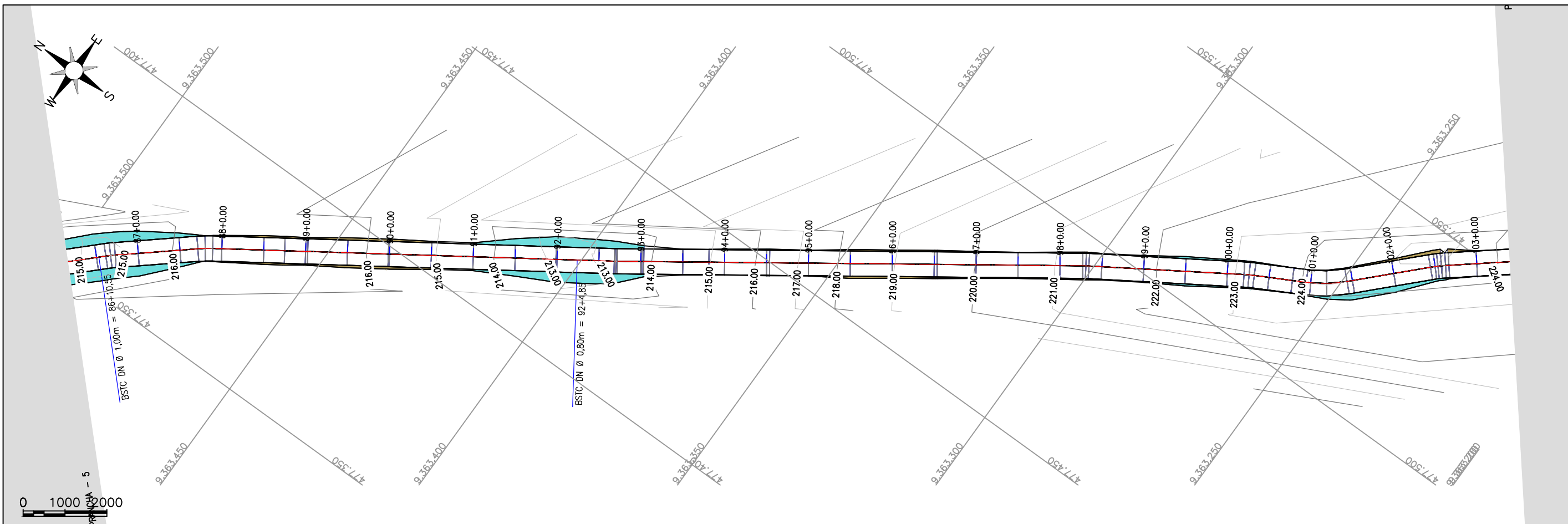

<p>TERRENO NATURAL    PROJETADO    ATERRO    CORTE    CURVAS DE NÍVEL</p>	<p>JOTA BARROS PROJETOS Arthur Moreira Torquato Engº Civil - CREA 53900/D - CE</p>	PREFEITURA MUNICIPAL DE MILHÃ - CE		PRANCHA:
		ADEQUAÇÃO DE ESTRADAS VICINAIS NO MUNICÍPIO DE MILHÃ / CE		<b>6 / 19</b>
		<b>BAIXA VERDE LADO E. - ESTAQUEAMENTO E PERFIL LONGITUDINAL</b>		ESCALA:
PROJETISTA:	ENG. CIVIL ARTHUR MOREIRA TORQUATO - CREA 53.900D-CE	ARQUIVO:	MILHÃ_BAIXA VERDE LE_GEO_R0.DWG	<b>1/1000</b>

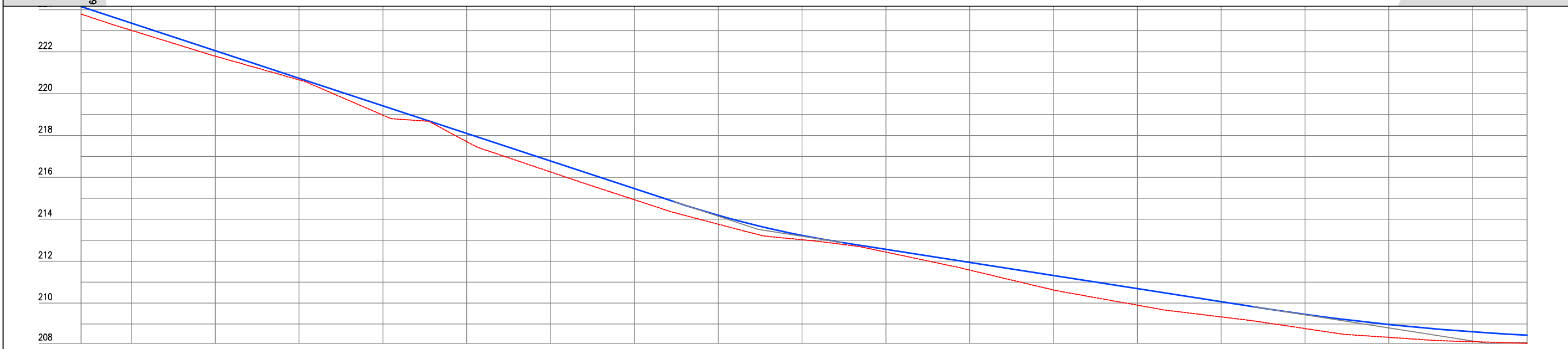
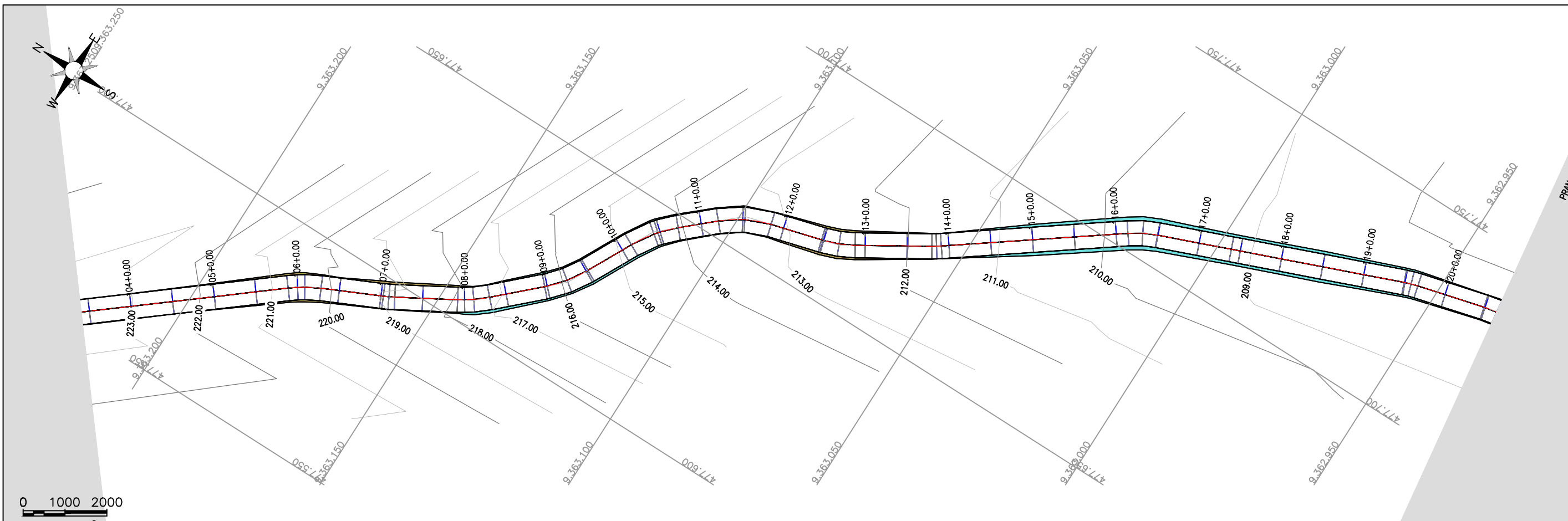

Estação	03	04	05	06	07	08	09	10	11	12	13	14	15	16	17	18	19	20	
Cota do terreno	223,796	223,020	221,790	220,655	219,411	217,705	216,259	214,935	213,765	213,023	212,433	211,574	210,622	209,900	209,339	208,782	208,362	208,156	208,076
Cota da terraplenagem	224,151	223,361	222,045	220,728	219,411	218,095	216,778	215,461	214,192	213,230	212,566	211,940	211,314	210,688	210,062	209,460	208,978	208,626	208,466
Cota vermelha	0,355	0,342	0,255	0,073	0,440	0,389	0,519	0,527	0,427	0,207	0,133	0,366	0,692	0,788	0,724	0,678	0,617	0,470	0,390

JOTA BARROS PROJETOS  
 Arthur Moreira Torquato  
 Engº Civil - CREA 53900D - CE



PREFEITURA MUNICIPAL DE MILHÃ - CE		PRANCHA:
ADEQUAÇÃO DE ESTRADAS VICINAIS NO MUNICÍPIO DE MILHÃ / CE		7 / 19
<b>BAIXA VERDE LADO E. - ESTAQUEAMENTO E PERFIL LONGITUDINAL</b>		ESCALA:
PROJETISTA:	ENG. CIVIL ARTHUR MOREIRA TORQUATO - CREA 53.900D-CE	1/1000
ARQUIVO:	MILHÃ_BAIXA VERDE LE_GEO_R0.DWG	

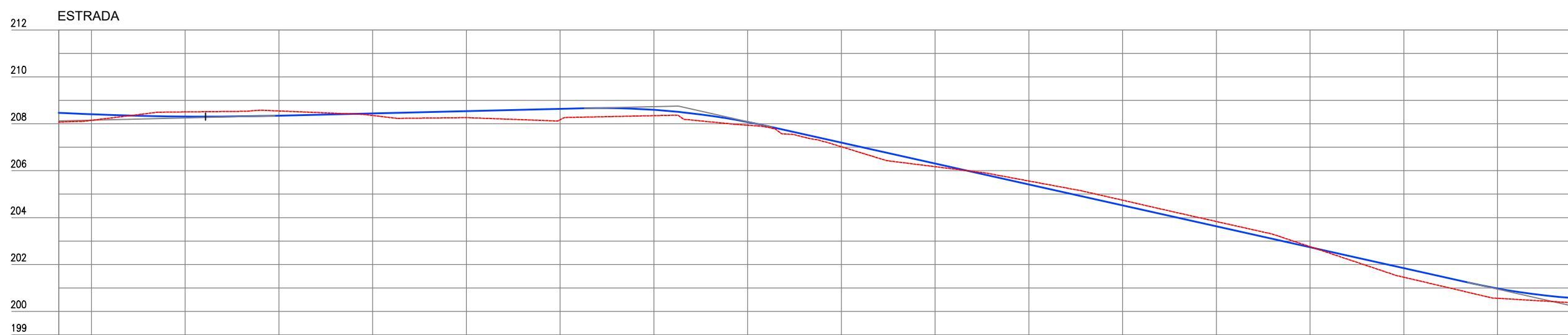
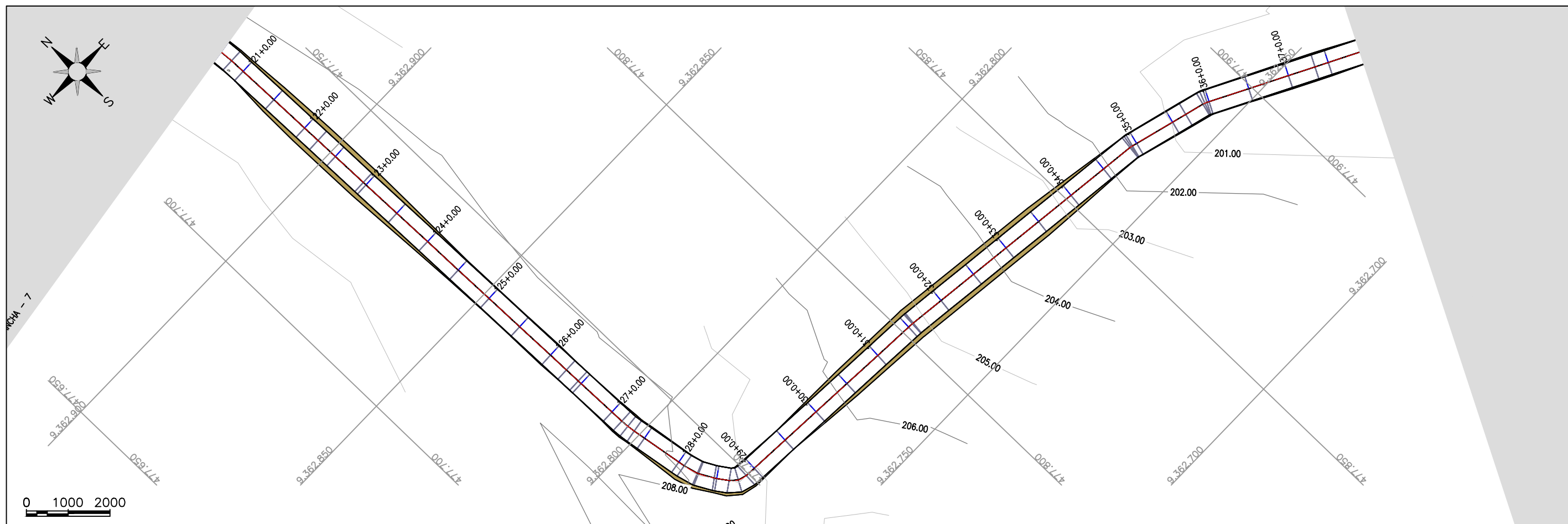

Estaca	120	121	122	123	124	125	126	127	128	129	130	131	132	133	134	135	136
Cota do terreno	208,076	208,147	208,506	208,546	208,352	208,282	208,172	208,346	207,940	207,020	206,171	205,580	204,741	203,833	202,780	201,456	200,558
Cota da terraplenagem	208,466	208,403	208,310	208,346	208,442	208,538	208,633	208,594	208,077	207,200	206,307	205,414	204,521	203,628	202,735	201,841	200,976
Cota vermelha	0,390	0,256	-0,196	-0,200	0,090	0,275	0,461	0,248	0,137	0,180	0,136	-0,146	-0,221	-0,206	-0,026	0,366	0,418

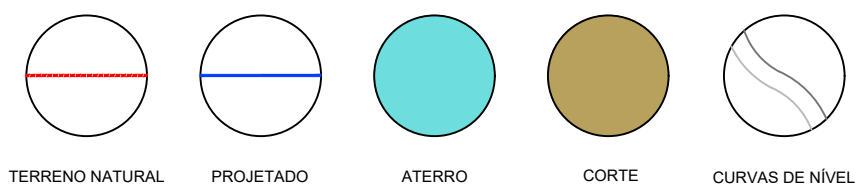

  
 JOTA BARROS PROJETOS  
 Arthur Moreira Torquato  
 Engº Civil - CREA 53900/D - CE



PREFEITURA MUNICIPAL DE MILHÃ - CE		PRANCHA:
ADEQUAÇÃO DE ESTRADAS VICINAIS NO MUNICÍPIO DE MILHÃ / CE		8 / 19
BAIXA VERDE LADO E. - ESTAQUEAMENTO E PERFIL LONGITUDINAL		ESCALA:
PROJETISTA:	ENG. CIVIL ARTHUR MOREIRA TORQUATO - CREA 53.900D-CE	1/1000
ARQUIVO:	MILHÃ_BAIXA VERDE LE_GEO_R0.DWG	



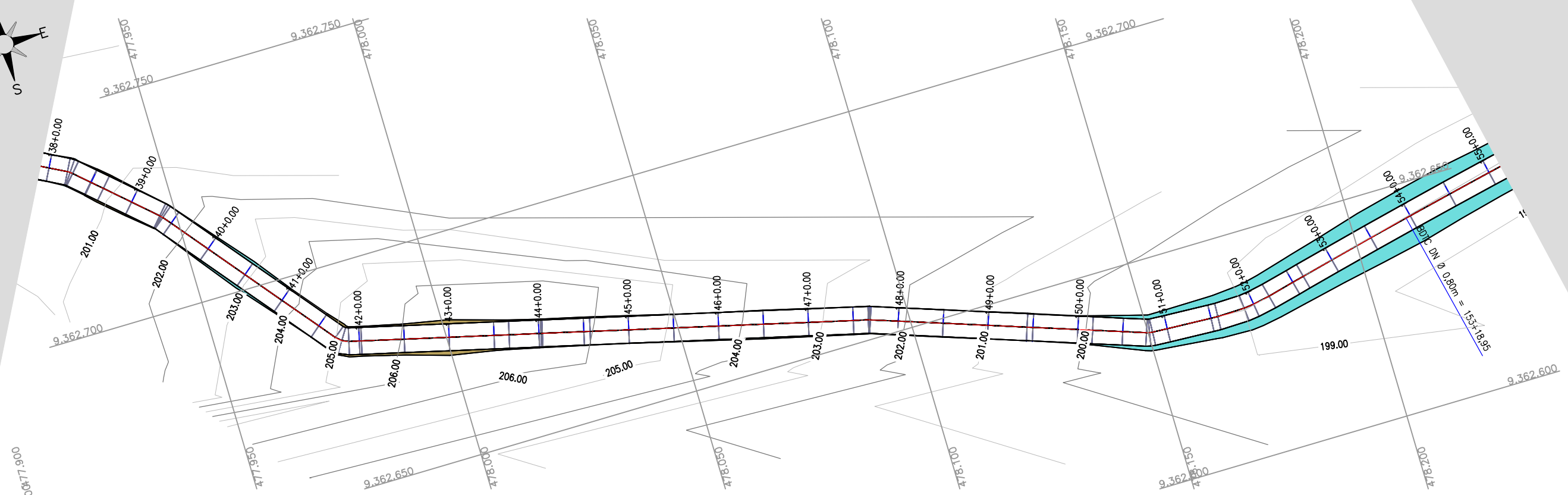
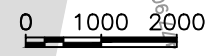
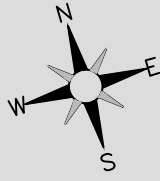

**ESTRADA**



Cota Vermelha	Cota da terraplenagem	Cota do terreno	Estaca
0.290	200.583	200.292	137
0.328	200.616	200.288	138
0.226	201.472	201.246	139
0.484	202.842	202.359	140
0.508	204.213	203.704	141
0.188	205.583	205.394	142
-0.149	206.555	206.704	143
0.250	206.695	206.445	144
0.309	206.821	205.512	145
0.389	204.695	204.306	146
0.406	203.570	203.164	147
0.353	202.444	202.091	148
0.341	201.319	200.977	149
0.388	200.440	200.052	150
0.943	200.420	199.477	151
1.453	200.420	198.967	152
1.712	200.420	198.707	153
1.931	200.420	198.483	154
1.764	200.420	198.656	155
1.743	200.420	198.677	155

JOTA BARROS PROJETOS
   
 Arthur Moreira Torquato
   
 Engº Civil - CREA 53900/D - CE



**PREFEITURA MUNICIPAL DE MILHÃ - CE**  
**ADEQUAÇÃO DE ESTRADAS VICINAIS NO MUNICÍPIO DE MILHÃ / CE**  
**BAIXA VERDE LADO E. - ESTAQUEAMENTO E PERFIL LONGITUDINAL**

PROJETA: ENG. CIVIL ARTHUR MOREIRA TORQUATO - CREA 53.900D-CE  
 ARQUIVO: MILHÃ\_BAIXA VERDE LE\_GEO\_R0.DWG

PRANCHA:  
**9 / 19**  
 ESCALA:  
**1/1000**

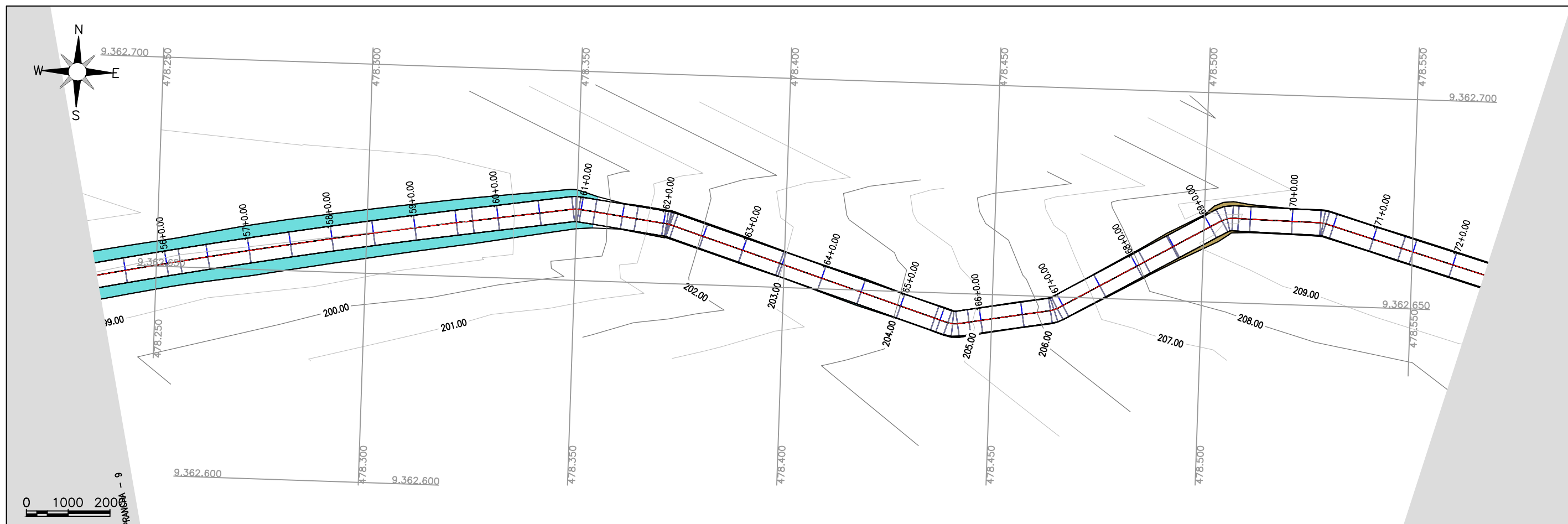

ESTRADA



Estaca	Cota do terreno	Cota da terraplenagem	Cota vermelha
155	196,677	200,420	1,743
156+00,00 156+03,00	196,769 196,784	200,420	1,651 1,636
157	196,587	200,420	1,832
158	196,655	200,420	1,785
159	196,774	200,420	1,646
160	196,943	200,420	1,477
161	199,345	200,420	1,074
162	201,411	201,608	0,197
163	202,601	202,831	0,230
164	203,250	203,674	0,424
165	204,040	204,427	0,367
166	205,133	205,403	0,289
167	206,442	206,783	0,341
168	207,952	208,163	0,212
169	208,795	209,052	0,257
170	209,365	209,672	0,307
171	209,711	210,001	0,290
172	209,833	210,084	0,251
172	209,861	210,109	0,247

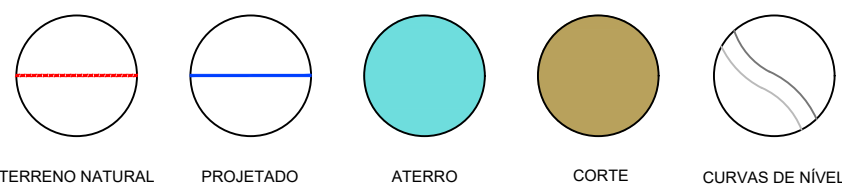

JOTA BARROS PROJETOS  
Arthur Moreira Torquato  
Engº Civil - CREA 53900/D - CE



PREFEITURA MUNICIPAL DE MILHÃ - CE  
ADEQUAÇÃO DE ESTRADAS VICINAIS NO MUNICÍPIO DE MILHÃ / CE  
**BAIXA VERDE LADO E. - ESTAQUEAMENTO E PERFIL LONGITUDINAL**  
PROJETISTA: ENG. CIVIL ARTHUR MOREIRA TORQUATO - CREA 53.900D-CE  
ARQUIVO: MILHÃ\_BAIXA VERDE LE\_GEO\_R0.DWG

PRANCHA:  
**10 / 19**  
ESCALA:  
1/1000

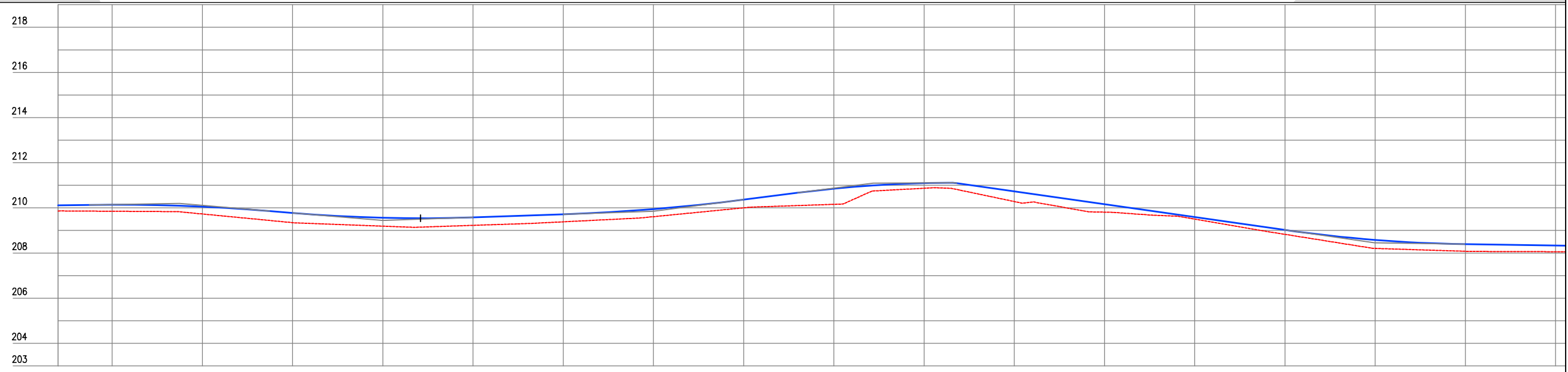
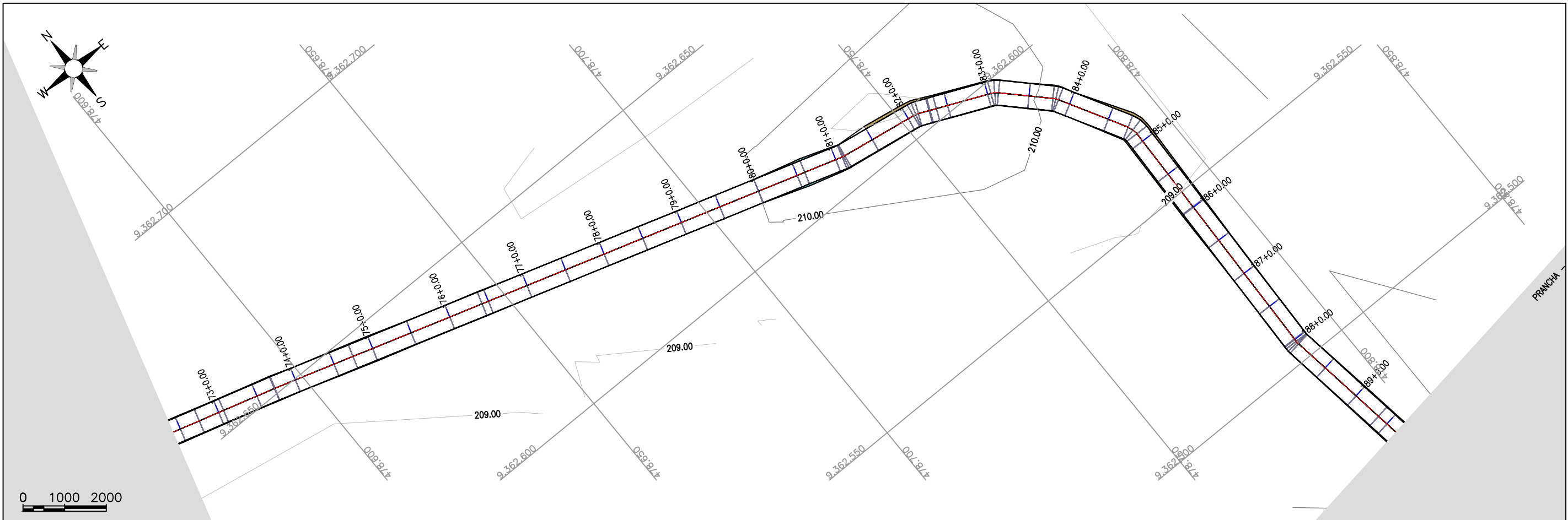

Estaca	172	173	174	175	176	177	178	179	180	181	182	183	184	185	186	187	188	189
Cota do terreno	209,861	209,851	209,730	209,345	209,190	209,225	209,383	209,610	210,002	210,156	210,870	210,280	209,811	209,505	208,828	208,204	208,077	208,058
Cota da terraplenagem	210,109	210,140	210,054	209,776	209,560	209,580	209,716	209,947	210,363	210,849	211,098	210,729	210,160	209,591	209,022	208,581	208,393	208,330
Cota vermelha	0,247	0,290	0,324	0,431	0,370	0,354	0,334	0,336	0,361	0,693	0,227	0,449	0,349	0,086	0,194	0,377	0,316	0,272

JOTA BARROS PROJETOS  
 Arthur Moreira Torquato  
 Engº Civil - CREA 53900/D - CE



PREFEITURA MUNICIPAL DE MILHÃ - CE		PRANCHA: <b>11 / 19</b>
ADEQUAÇÃO DE ESTRADAS VICINAIS NO MUNICÍPIO DE MILHÃ / CE		
<b>BAIXA VERDE LADO E. - ESTAQUEAMENTO E PERFIL LONGITUDINAL</b>		ESCALA: <b>1/1000</b>
PROJETISTA:	ENG. CIVIL ARTHUR MOREIRA TORQUATO - CREA 53.900D-CE	
ARQUIVO:	MILHÃ_BAIXA VERDE LE_GEO_R0.DWG	

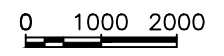
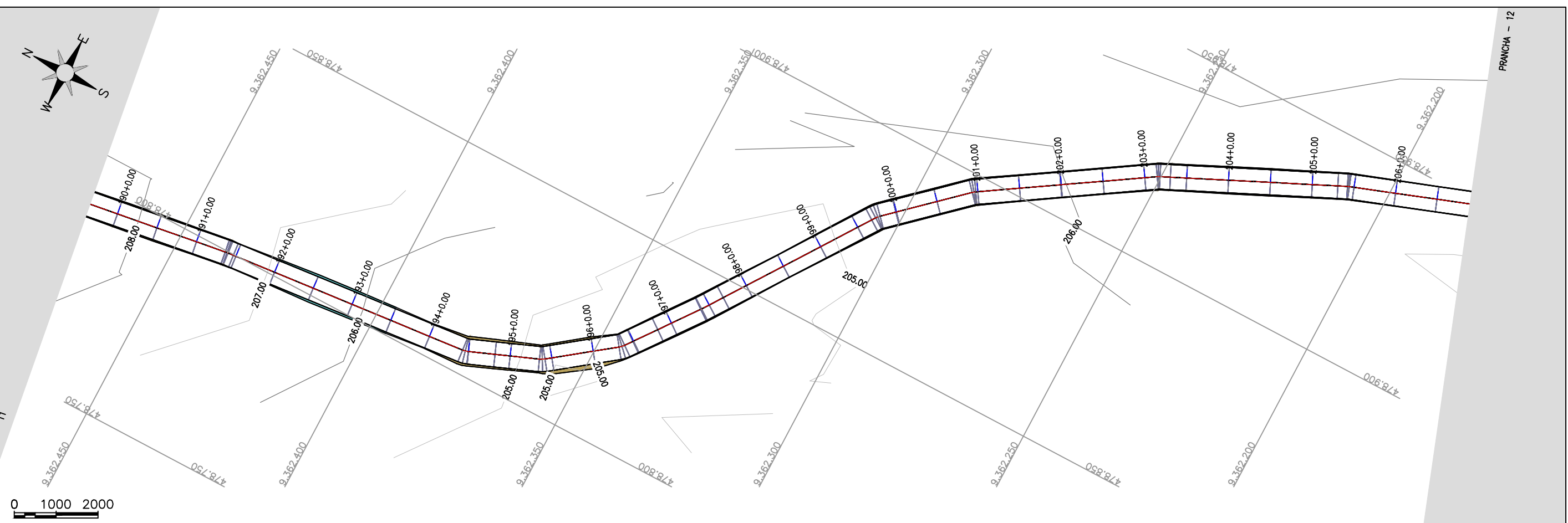
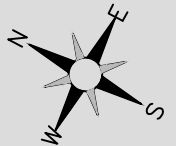

PRANCHA - 12

**ESTRADA**

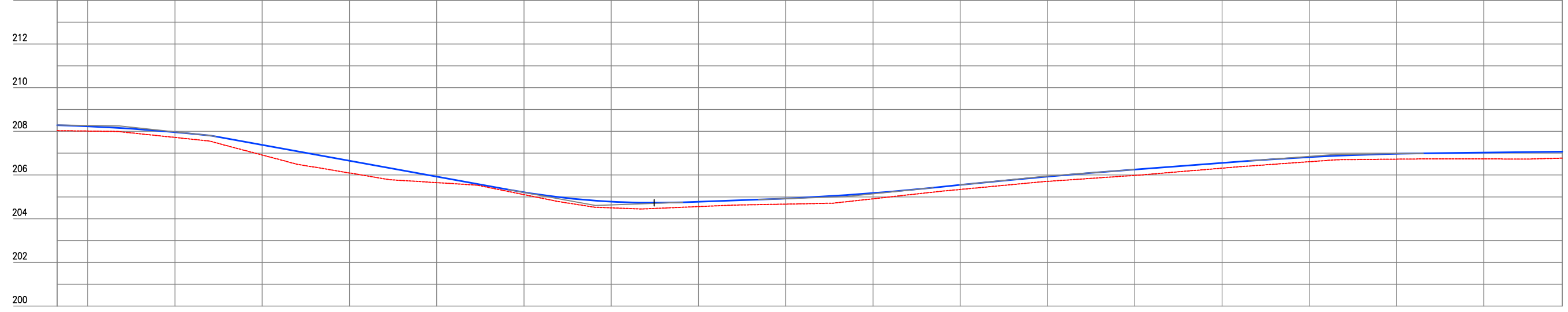

Estaca	189	190	191	192	193	194	195	196	197	198	199	200	201	202	203	204	205	206	206
Cota do terreno	208,032	208,014	207,721	206,916	206,095	205,653	205,104	204,498	204,557	204,669	204,913	205,340	205,711	205,984	206,315	206,610	206,727	206,738	206,773
Cota da terraplenagem	208,282	208,231	207,964	207,378	206,653	205,929	205,211	204,782	204,778	204,926	205,175	205,550	205,929	206,254	206,553	206,821	206,972	207,028	207,073
Cota vermelha	0,249	0,217	0,243	0,462	0,558	0,276	0,108	0,284	0,221	0,257	0,262	0,210	0,219	0,270	0,238	0,211	0,244	0,289	0,300

TERRENO NATURAL	PROJETADO	ATERRO	CORTE	CURVAS DE NÍVEL

JOTA BARROS PROJETOS  
 Arthur Moreira Torquato  
 Engº Civil - CREA 53900/D - CE



PREFEITURA MUNICIPAL DE MILHÃ - CE

ADEQUAÇÃO DE ESTRADAS VICINAIS NO MUNICÍPIO DE MILHÃ / CE

**BAIXA VERDE LADO E. - ESTAQUEAMENTO E PERFIL LONGITUDINAL**

PROJETISTA: ENG. CIVIL ARTHUR MOREIRA TORQUATO - CREA 53.900D-CE

ARQUIVO: MILHÃ\_BAIXA VERDE LE\_GEO\_R0.DWG

PRANCHA:

**12 / 19**

ESCALA:

**1/1000**



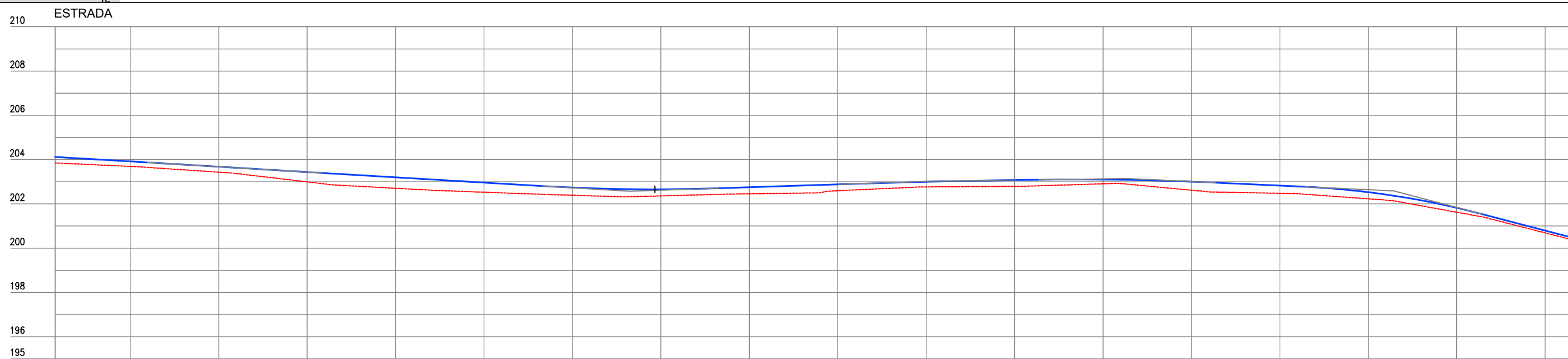
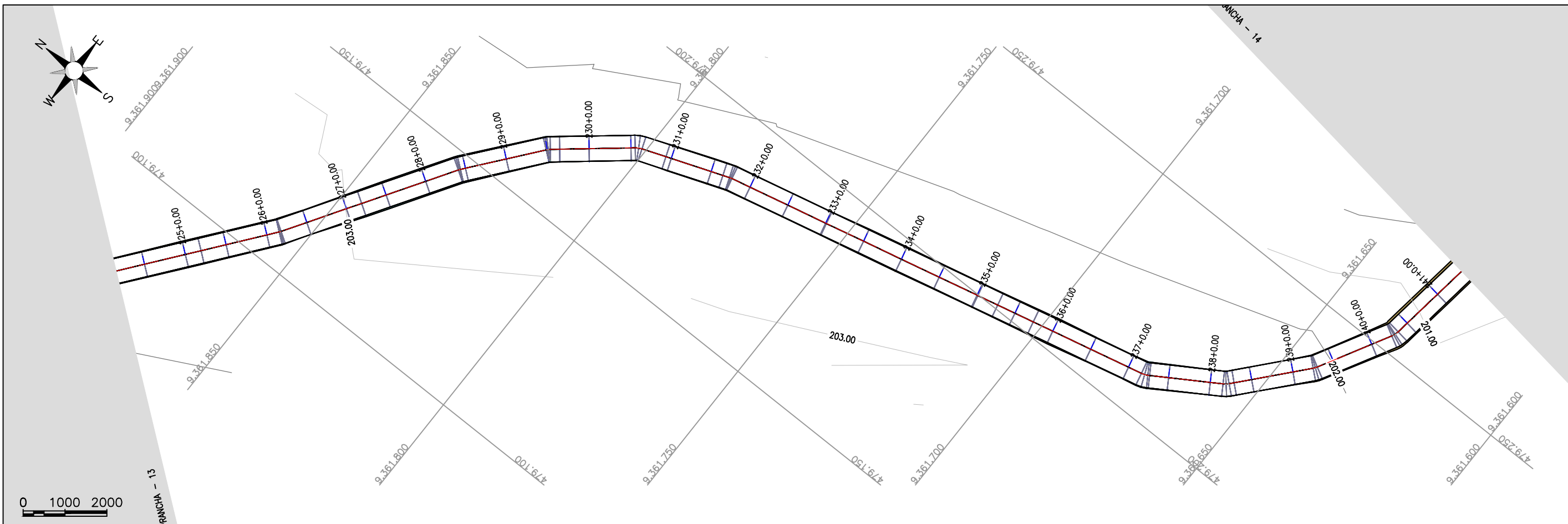

Estaca	224	225	226	227	228	229	230	231	232	233	234	235	236	237	238	239	240	241	241
Cota do terreno	203,849	203,693	203,432	202,994	202,704	202,527	202,390	202,360	202,455	202,594	202,767	202,790	202,907	202,618	202,478	202,229	201,624	200,690	200,272
Cota da terraplenagem	204,121	203,918	203,679	203,440	203,202	202,963	202,737	202,656	202,750	202,883	202,997	203,074	203,099	203,007	202,825	202,530	201,822	200,794	200,376
Cota vermelha	0,273	0,225	0,247	0,446	0,497	0,436	0,347	0,286	0,285	0,289	0,230	0,284	0,192	0,389	0,347	0,301	0,199	0,104	0,104

JOTA BARROS PROJETOS
   
 Arthur Moreira Torquato
   
 Engº Civil - CREA 53900/D - CE



PREFEITURA MUNICIPAL DE MILHÃ - CE		PRANCHA:
ADEQUAÇÃO DE ESTRADAS VICINAIS NO MUNICÍPIO DE MILHÃ / CE		14 / 19
BAIXA VERDE LADO E. - ESTAQUEAMENTO E PERFIL LONGITUDINAL		ESCALA:
PROJETISTA:	ENG. CIVIL ARTHUR MOREIRA TORQUATO - CREA 53.900D-CE	1/1000
ARQUIVO:	MILHÃ_BAIXA VERDE LE_GEO_R0.DWG	

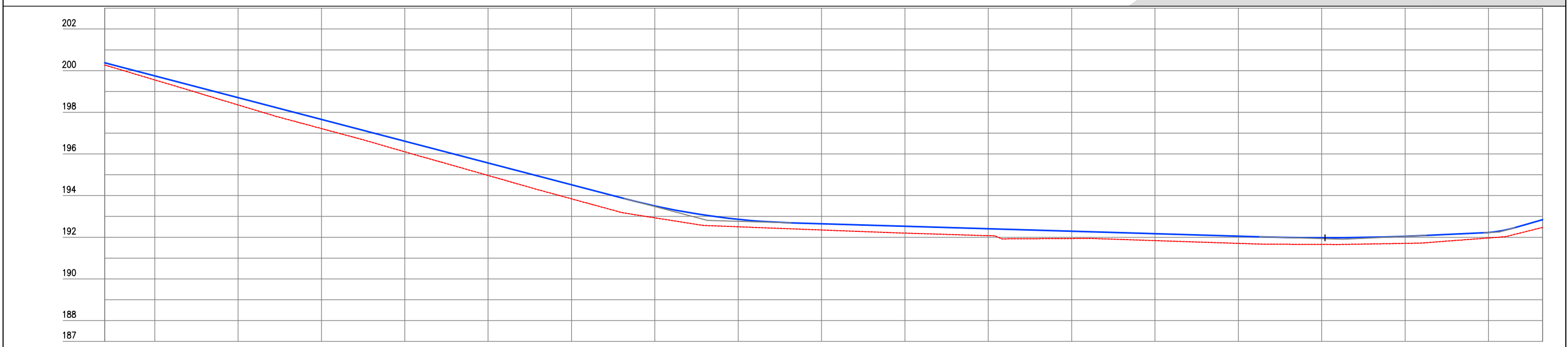
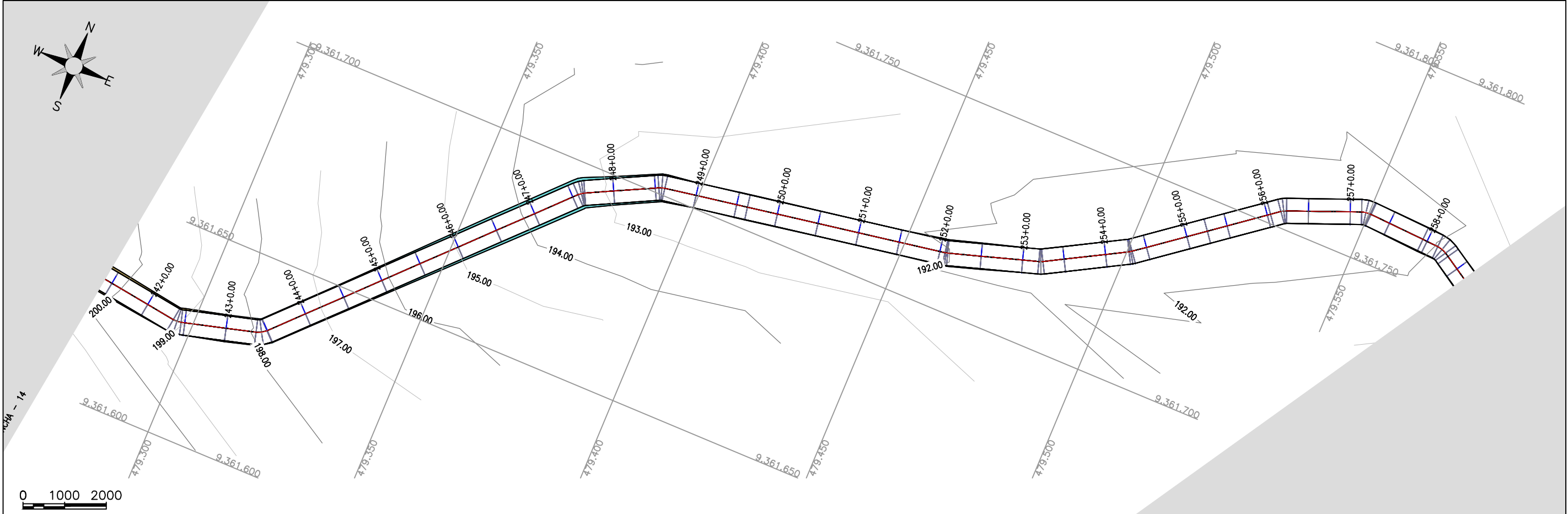
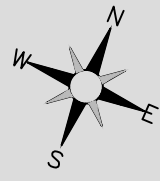

Estaca	Cota do terreno	Cota da terraplenagem	Cota vermelha
241	200,272	200,376	0,104
242	199,556	199,749	0,193
243	198,355	198,703	0,348
244	197,220	197,657	0,437
245	196,103	196,611	0,508
246	194,967	195,565	0,599
247	193,845	194,520	0,675
248	192,933	193,505	0,572
249	192,503	192,861	0,358
250	192,349	192,649	0,301
251	192,199	192,530	0,332
252	192,075	192,411	0,336
253	191,940	192,292	0,352
254	191,839	192,175	0,334
255	191,706	192,054	0,347
256	191,655	191,977	0,321
257	191,706	192,047	0,341
258	191,965	192,230	0,264
258	192,471	192,842	0,371

JOTA BARROS PROJETOS  
 Arthur Moreira Torquato  
 Engº Civil - CREA 53900/D - CE



PREFEITURA MUNICIPAL DE MILHÃ - CE		PRANCHA:
ADEQUAÇÃO DE ESTRADAS VICINAIS NO MUNICÍPIO DE MILHÃ / CE		
<b>BAIXA VERDE LADO E. - ESTAQUEAMENTO E PERFIL LONGITUDINAL</b>		ESCALA:
PROJETISTA:	ENG. CIVIL ARTHUR MOREIRA TORQUATO - CREA 53.900D-CE	1/1000
ARQUIVO:	MILHÃ_BAIXA VERDE LE_GEO_R0.DWG	

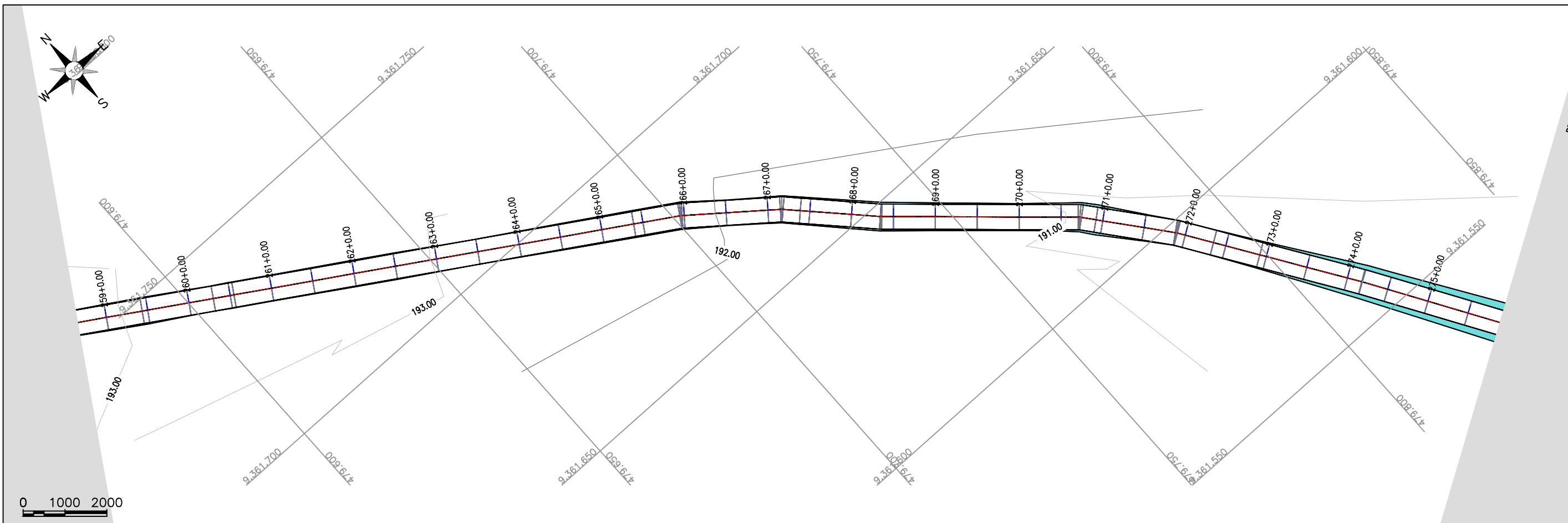

ESTRADA

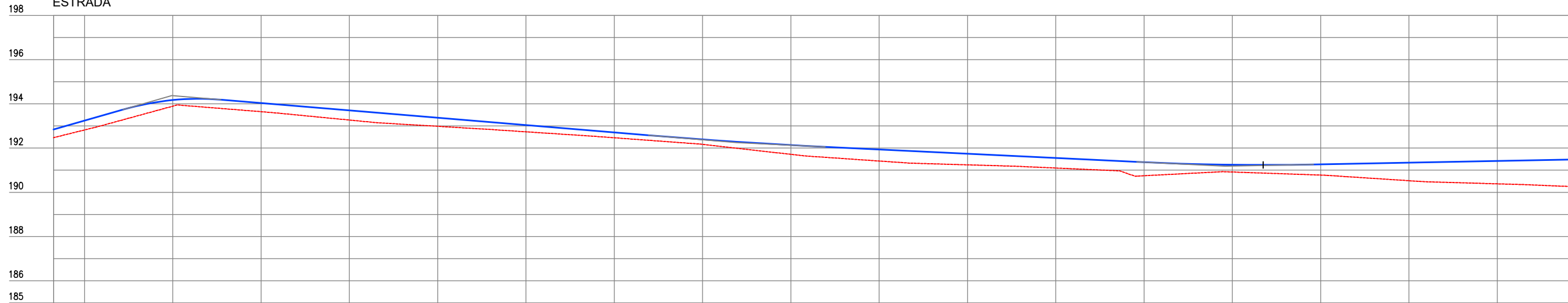

Estaca	258	259	260	261	262	263	264	265	266	267	268	269	270	271	272	273	274	275	275
Cota do terreno	192,471	192,819	193,895	193,646	193,287	192,984	192,735	192,466	192,166	191,717	191,414	191,242	191,098	190,749	190,918	190,779	190,524	190,383	190,249
Cota da terraplenagem	192,842	193,242	194,171	194,036	193,704	193,373	193,041	192,710	192,391	192,137	191,938	191,745	191,552	191,359	191,245	191,285	191,342	191,419	191,489
Cota vermelha	0,371	0,423	0,275	0,390	0,437	0,389	0,306	0,244	0,225	0,420	0,524	0,503	0,454	0,611	0,327	0,485	0,818	1,036	1,239

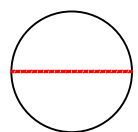

TERRENO NATURAL

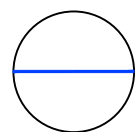

PROJETADO

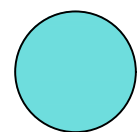

ATERRO

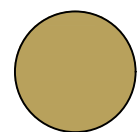

CORTE

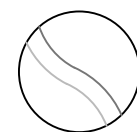

CURVAS DE NÍVEL

JOTA BARROS PROJETOS  
Arthur Moreira Torquato  
Engº Civil - CREA 53900/D - CE



PREFEITURA MUNICIPAL DE MILHÃ - CE

ADEQUAÇÃO DE ESTRADAS VICINAIS NO MUNICÍPIO DE MILHÃ / CE

BAIXA VERDE LADO E. - ESTAQUEAMENTO E PERFIL LONGITUDINAL

PROJETISTA: ENG. CIVIL ARTHUR MOREIRA TORQUATO - CREA 53.900D-CE

ARQUIVO: MILHÃ\_BAIXA VERDE LE\_GEO\_R0.DWG

PRANCHA:

16 / 19

ESCALA:

1/1000



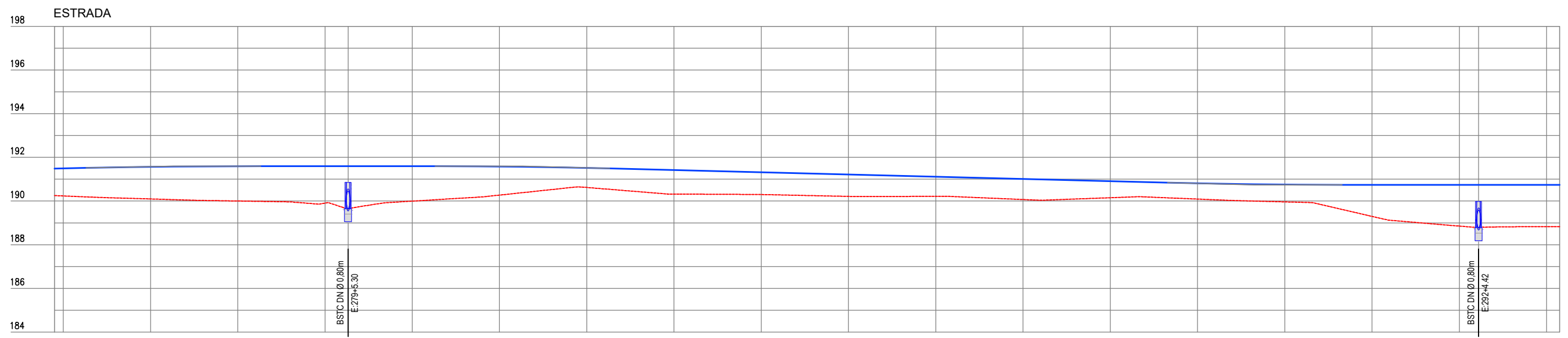
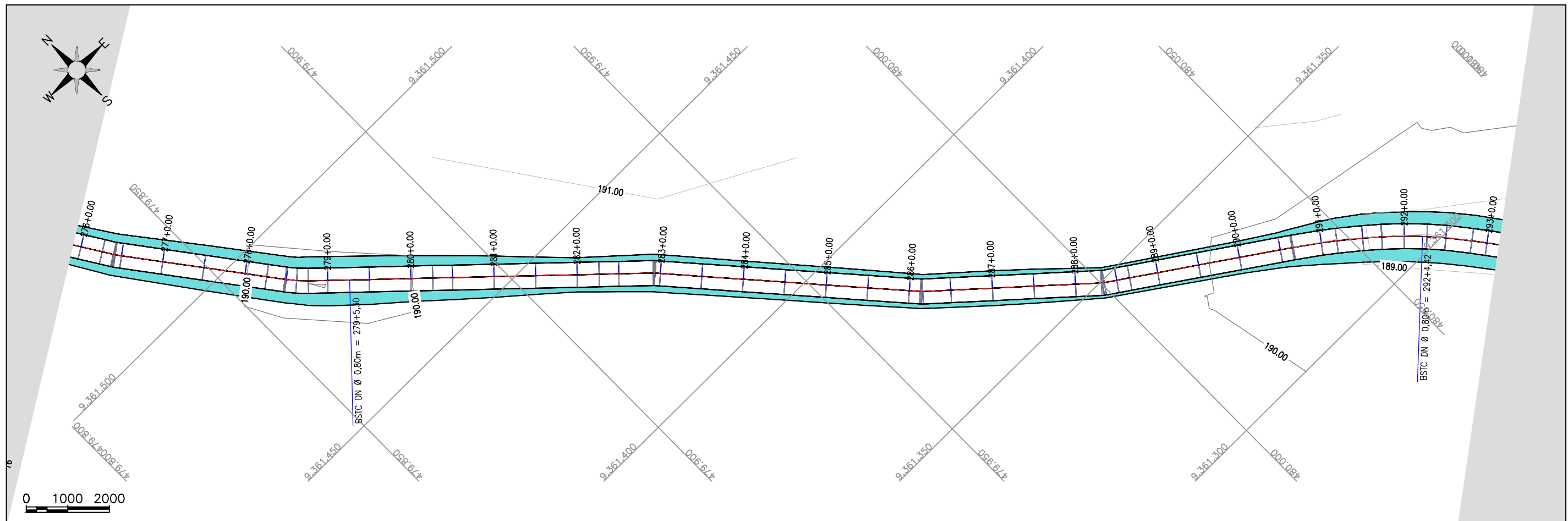

Cota vermelha	Cota da terraplenagem	Cota do terreno	Estaca
1,239	191,489	190,249	275
1,263	191,496	190,233	276
1,468	191,563	190,095	277
1,581	191,582	190,002	278
1,689	191,594	189,905	279
1,940	191,594	189,653	279+5,30
1,589	191,594	189,995	280
1,308	191,580	190,272	281
0,896	191,517	190,621	282
1,086	191,417	190,320	283
1,017	191,315	190,298	284
1,002	191,214	190,212	285
0,899	191,112	190,213	286
0,941	191,010	190,088	287
0,757	190,908	190,151	288
0,720	190,810	190,090	289
0,790	190,751	189,961	290
1,442	190,740	189,298	291
1,887	190,740	188,853	292
1,957	190,740	188,783	292+4,42
1,916	190,740	188,824	293
1,917	190,740	188,823	293

JOTA BARROS PROJETOS
   
 Arthur Moreira Torquato
   
 Engº Civil - CREA 53900/D - CE



**PREFEITURA MUNICIPAL DE MILHÃ - CE**  
**ADEQUAÇÃO DE ESTRADAS VICINAIS NO MUNICÍPIO DE MILHÃ / CE**  
**BAIXA VERDE LADO E. - ESTAQUEAMENTO E PERFIL LONGITUDINAL**

PROJETA: ENG. CIVIL ARTHUR MOREIRA TORQUATO - CREA 53.900D-CE  
 ARQUIVO: MILHÃ\_BAIXA VERDE LE\_GEO\_R0.DWG

PRANCHA:  
**17 / 19**  
 ESCALA:  
**1/1000**

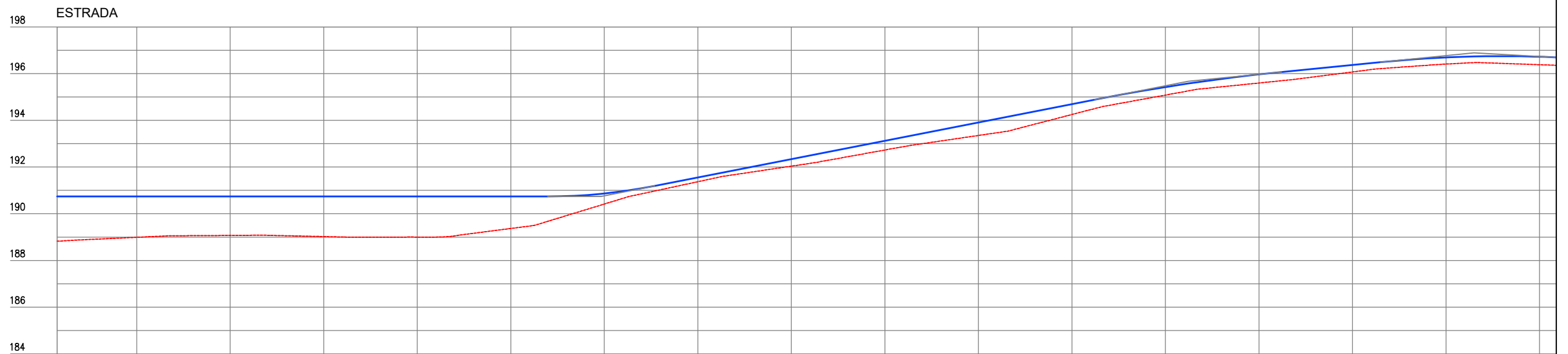
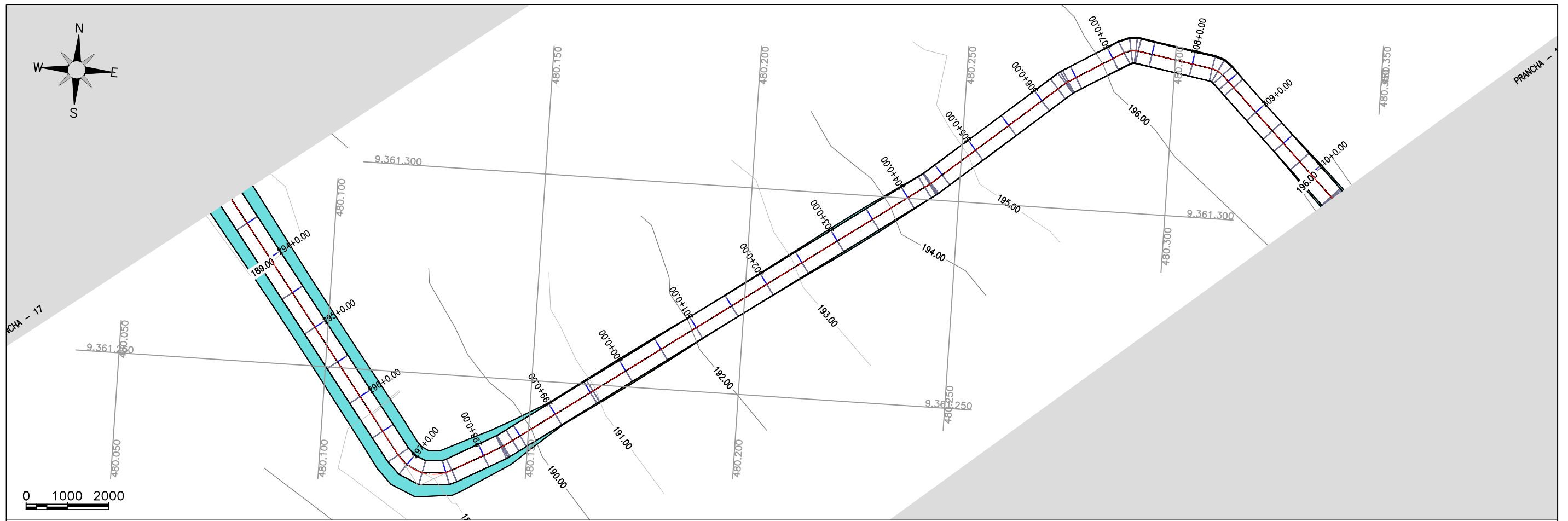

Estaca	293	294	295	296	297	298	299	300	301	302	303	304	305	306	307	308	309
Cota do terreno	188,823	188,991	188,071	188,022	188,998	188,368	190,415	191,371	192,037	192,728	193,350	194,248	195,079	195,596	196,069	196,408	196,379
Cota da terraplenagem	190,740	190,740	190,740	190,740	190,740	190,740	190,866	191,552	192,338	193,123	193,908	194,693	195,423	195,964	196,388	196,691	196,721
Cota vermelha	1,917	1,749	1,689	1,718	1,741	1,371	0,451	0,182	0,301	0,385	0,558	0,446	0,344	0,368	0,299	0,283	0,341

JOTA BARROS PROJETOS  
 Arthur Moreira Torquato  
 Engº Civil - CREA 53900/D - CE



PREFEITURA MUNICIPAL DE MILHÃ - CE		PRANCHA:
ADEQUAÇÃO DE ESTRADAS VICINAIS NO MUNICÍPIO DE MILHÃ / CE		18 / 19
<b>BAIXA VERDE LADO E. - ESTAQUEAMENTO E PERFIL LONGITUDINAL</b>		ESCALA:
PROJETISTA:	ENG. CIVIL ARTHUR MOREIRA TORQUATO - CREA 53.900D-CE	1/1000
ARQUIVO:	MILHÃ_BAIXA VERDE LE_GEO_R0.DWG	



0 1000 2000

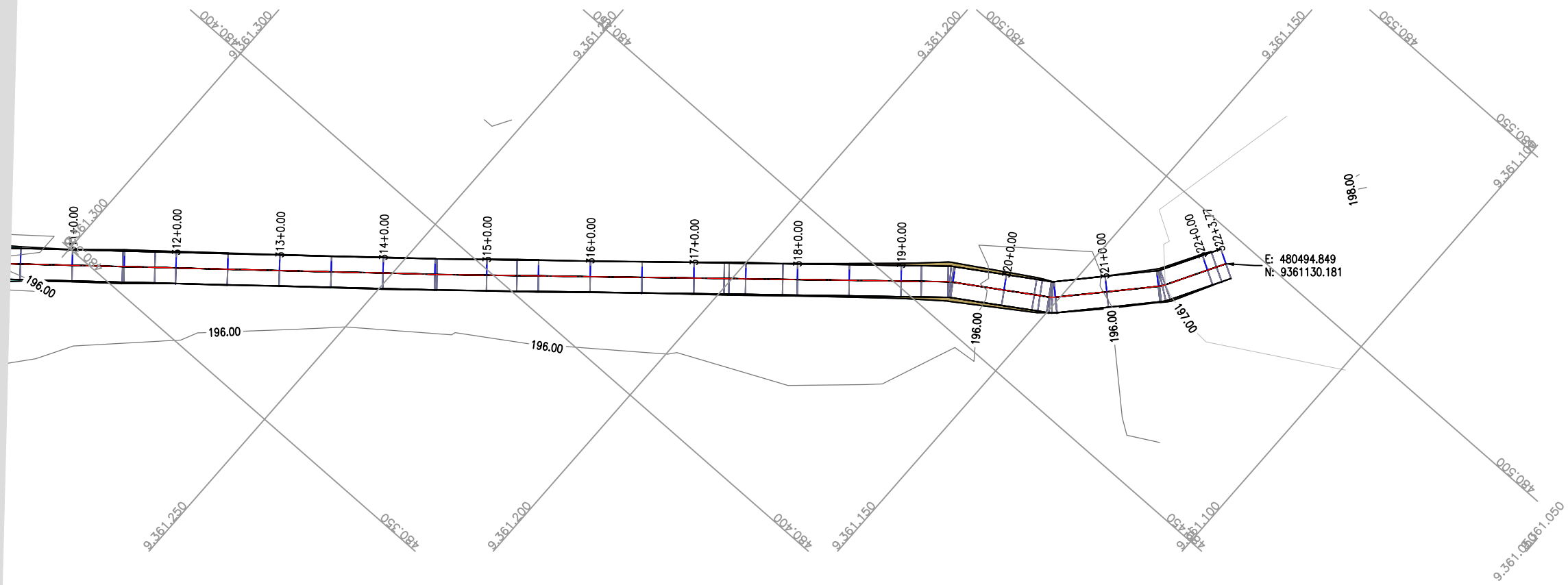

202 ESTRADA

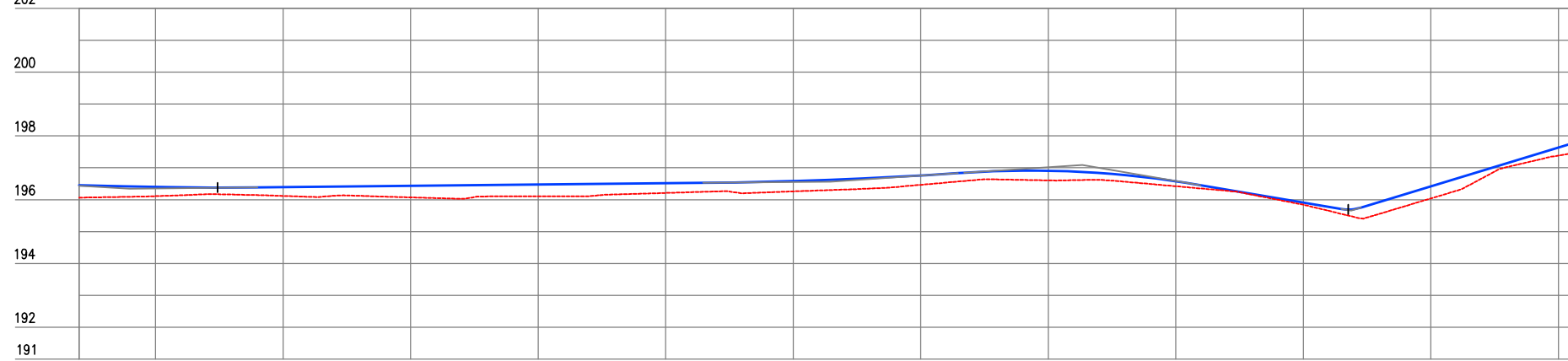

Cota da vermelha	Cota da terraplenagem	Cota do terreno	Estaca
0,392	196,456	196,064	310
0,285	196,396	196,111	311
0,277	196,395	196,118	312
0,364	196,435	196,072	313
0,370	196,475	196,105	314
0,304	196,515	196,211	315
0,323	196,583	196,260	316
0,292	196,758	196,466	317
0,302	196,906	196,605	318
0,159	196,590	196,422	319
0,068	195,911	195,842	320
0,379	196,419	196,039	321
0,254	197,637	197,384	322
		197,500	322

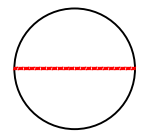

TERRENO NATURAL

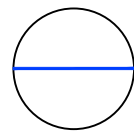

PROJETADO

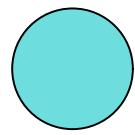

ATERRO



CORTE

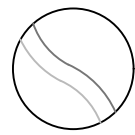

CURVAS DE NÍVEL

JOTA BARROS PROJETOS  
Arthur Moreira Torquato  
Engº Civil - CREA 53900/D - CE



PREFEITURA MUNICIPAL DE MILHÃ - CE

ADEQUAÇÃO DE ESTRADAS VICINAIS NO MUNICÍPIO DE MILHÃ / CE

BAIXA VERDE LADO E. - ESTAQUEAMENTO E PERFIL LONGITUDINAL

PROJETISTA: ENG. CIVIL ARTHUR MOREIRA TORQUATO - CREA 53.900D-CE

ARQUIVO: MILHÃ\_BAIXA VERDE LE\_GEO\_R0.DWG

PRANCHA:

19 / 19

ESCALA:

1/1000