

238 ESTRADA

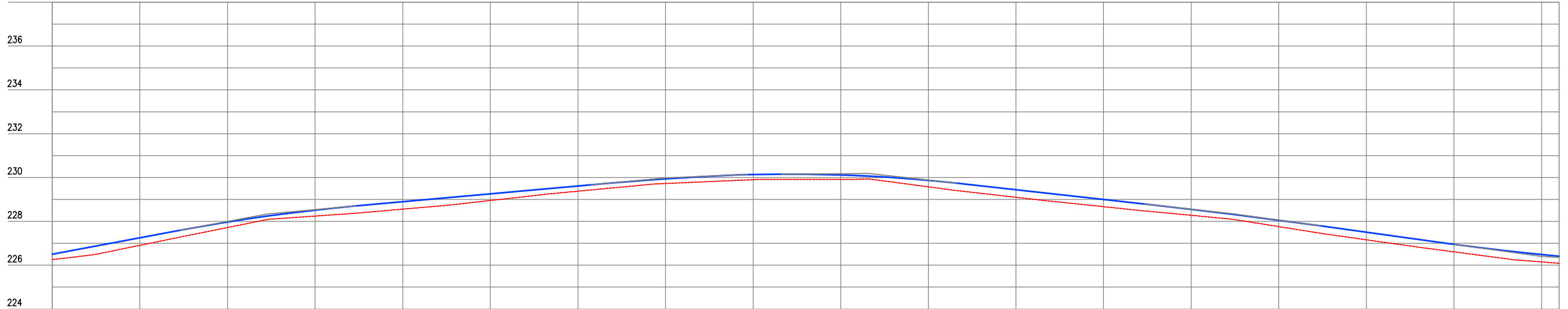

| Estaca | 0 | 1 | 2 | 3 | 4 | 5 | 6 | 7 | 8 | 9 | 10 | 11 | 12 | 13 | 14 | 15 | 16 | 17 | |
|-----------------------|---------|---------|---------|---------|---------|---------|---------|---------|---------|---------|---------|---------|---------|---------|---------|---------|---------|---------|---------|
| Cota do terreno | 226,256 | 226,908 | 227,719 | 228,242 | 228,558 | 228,953 | 229,378 | 229,728 | 229,903 | 229,917 | 229,578 | 229,101 | 228,672 | 228,277 | 227,762 | 227,160 | 226,610 | 226,151 | 226,089 |
| Cota da terraplenagem | 226,506 | 227,252 | 227,970 | 228,515 | 228,896 | 229,257 | 229,618 | 229,939 | 230,138 | 230,120 | 229,873 | 229,443 | 229,000 | 228,550 | 228,051 | 227,505 | 226,953 | 226,486 | 226,413 |
| Cota vermelha | 0,250 | 0,344 | 0,250 | 0,273 | 0,338 | 0,304 | 0,240 | 0,211 | 0,235 | 0,202 | 0,296 | 0,342 | 0,329 | 0,273 | 0,289 | 0,345 | 0,343 | 0,335 | 0,325 |

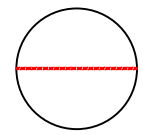

TERRENO NATURAL

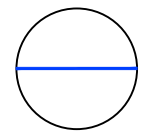

PROJETADO

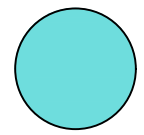

ATERRO

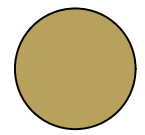

CORTE

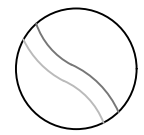

CURVAS DE NÍVEL

JOTA BARROS PROJETOS
Arthur Moreira Torquato
Engº Civil - CREA 53900/D - CE



PREFEITURA MUNICIPAL DE MILHÃ - CE

ADEQUAÇÃO DE ESTRADAS VICINAIS NO MUNICÍPIO DE MILHÃ / CE

BAIXA VERDE LADO D. - ESTAQUEAMENTO E PERFIL LONGITUDINAL

PROJETISTA: ENG. CIVIL ARTHUR MOREIRA TORQUATO - CREA 53.900D-CE

ARQUIVO: MILHÃ_BAIXA VERDE_LD_GEO_R0.DWG

PRANCHA:

1 / 12

ESCALA:

1/1000

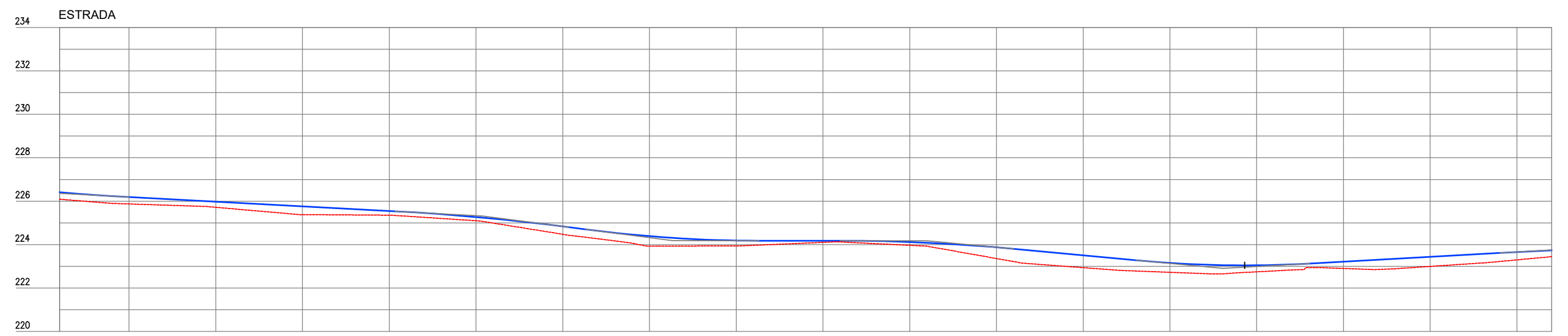
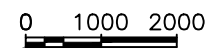
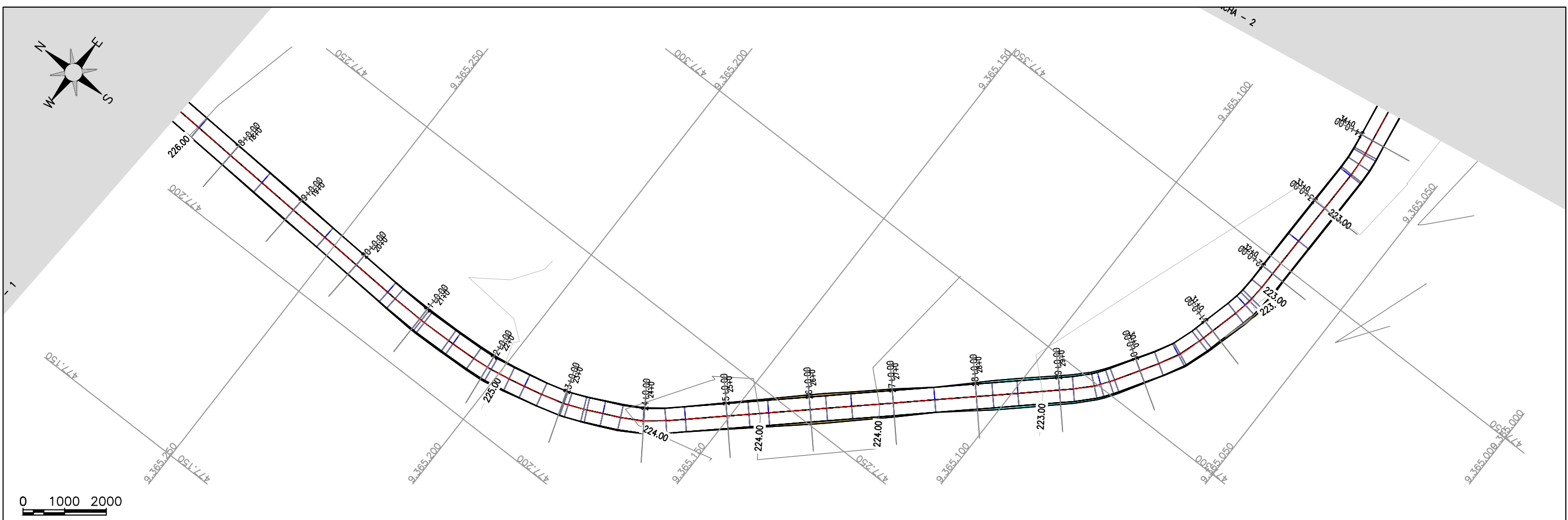

| Estaca | 17 | 18 | 19 | 20 | 21 | 22 | 23 | 24 | 25 | 26 | 27 | 28 | 29 | 30 | 31 | 32 | 33 | 34 | 34 |
|-----------------------|---------|---------|---------|---------|---------|---------|---------|---------|---------|---------|---------|---------|---------|---------|---------|---------|---------|---------|---------|
| Cota do terreno | 225,089 | 225,873 | 225,718 | 225,392 | 225,355 | 225,099 | 224,476 | 223,931 | 223,942 | 224,104 | 223,967 | 223,359 | 222,939 | 222,795 | 222,747 | 222,903 | 222,996 | 223,297 | 223,446 |
| Cota da terraplenagem | 225,413 | 225,189 | 225,976 | 225,763 | 225,550 | 225,271 | 224,838 | 224,389 | 224,190 | 224,180 | 224,119 | 223,676 | 223,506 | 223,155 | 223,047 | 223,215 | 223,438 | 223,661 | 223,737 |
| Cota vertical | 0,325 | 0,316 | 0,258 | 0,381 | 0,195 | 0,172 | 0,362 | 0,457 | 0,246 | 0,076 | 0,152 | 0,517 | 0,567 | 0,430 | 0,300 | 0,312 | 0,443 | 0,363 | 0,292 |

JOTA BARROS PROJETOS
 Arthur Moreira Torquato
 Engº Civil - CREA 53900/D - CE



PREFEITURA MUNICIPAL DE MILHÃ - CE
ADEQUAÇÃO DE ESTRADAS VICINAIS NO MUNICÍPIO DE MILHÃ / CE
BAIXA VERDE LADO D. - ESTAQUEAMENTO E PERFIL LONGITUDINAL
 PROJETA: ENG. CIVIL ARTHUR MOREIRA TORQUATO - CREA 53.900D-CE
 ARQUIVO: MILHÃ_BAIXA VERDE LD_GEO_R0.DWG

PRANCHA:
2 / 12
 ESCALA:
1/1000

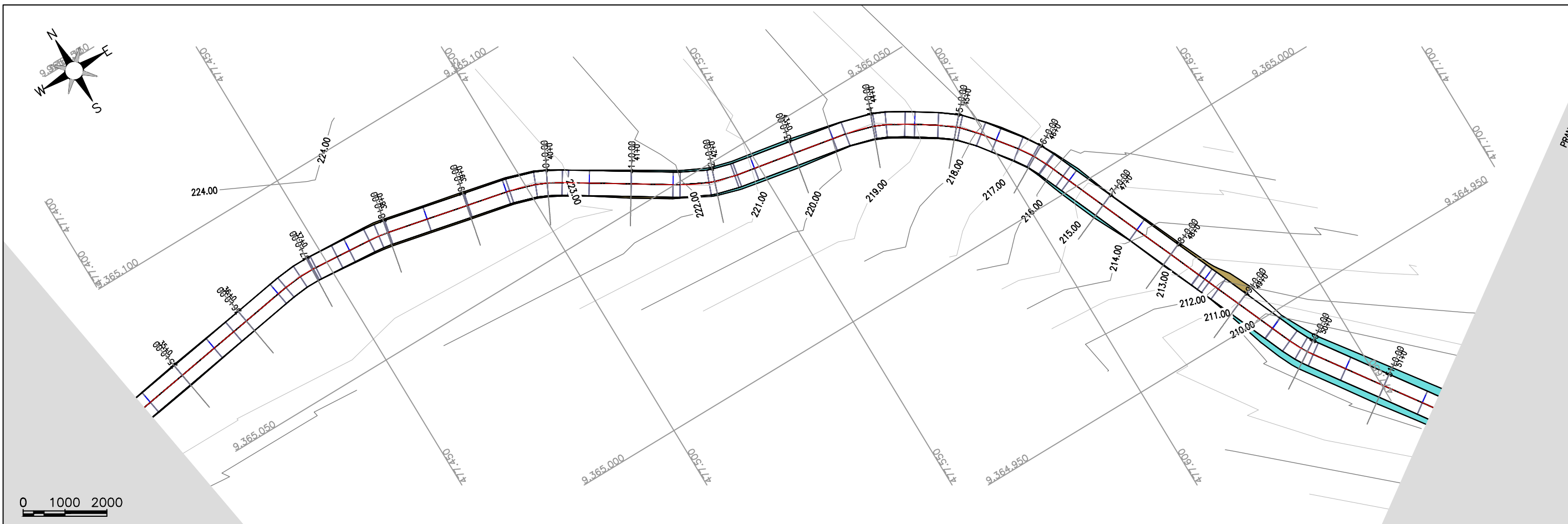
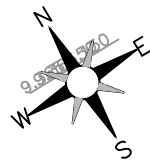

0 1000 2000



| Estaca | Cota do terreno | Cota da terraplenagem | Cota vermelha |
|--------|-----------------|-----------------------|---------------|
| 34 | 223,446 | 223,737 | 0,292 |
| 35 | 223,589 | 223,628 | 0,238 |
| 36 | 223,585 | 223,916 | 0,330 |
| 37 | 223,651 | 223,978 | 0,327 |
| 38 | 223,795 | 223,945 | 0,151 |
| 39 | 223,562 | 223,717 | 0,155 |
| 40 | 223,157 | 223,389 | 0,232 |
| 41 | 222,603 | 222,947 | 0,344 |
| 42 | 221,562 | 222,119 | 0,557 |
| 43 | 220,366 | 221,003 | 0,637 |
| 44 | 219,621 | 219,975 | 0,254 |
| 45 | 218,423 | 218,624 | 0,201 |
| 46 | 216,642 | 217,029 | 0,387 |
| 47 | 214,371 | 215,232 | 0,862 |
| 48 | 213,461 | 213,564 | 0,102 |
| 49 | 210,937 | 211,369 | 0,432 |
| 50 | 209,528 | 210,882 | 1,354 |
| 51 | 209,540 | 210,882 | 1,341 |
| 51 | 209,615 | 210,882 | 1,266 |

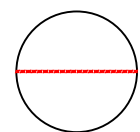

TERRENO NATURAL

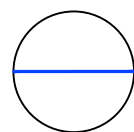

PROJETADO

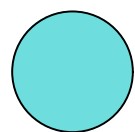

ATERRO



CORTE

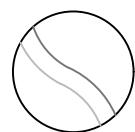

CURVAS DE NÍVEL

JOTA BARROS PROJETOS
Arthur Moreira Torquato
Engº Civil - CREA 53900/D - CE



PREFEITURA MUNICIPAL DE MILHÃ - CE

ADEQUAÇÃO DE ESTRADAS VICINAIS NO MUNICÍPIO DE MILHÃ / CE

BAIXA VERDE LADO D. - ESTAQUEAMENTO E PERFIL LONGITUDINAL

PROJETISTA: ENG. CIVIL ARTHUR MOREIRA TORQUATO - CREA 53.900D-CE

ARQUIVO: MILHÃ_BAIXA VERDE LD_GEO_R0.DWG

PRANCHA:

3 / 12

ESCALA:

1/1000

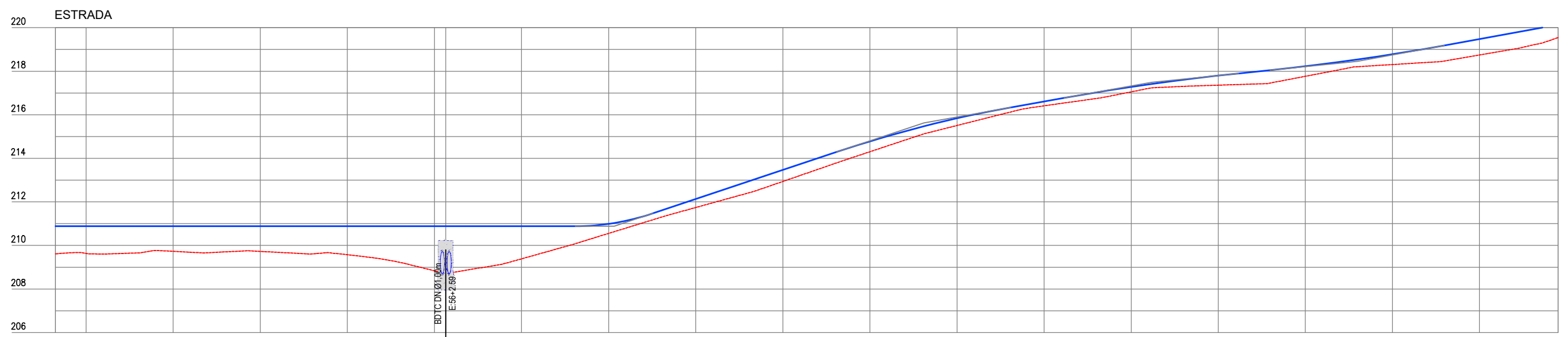
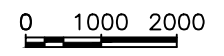
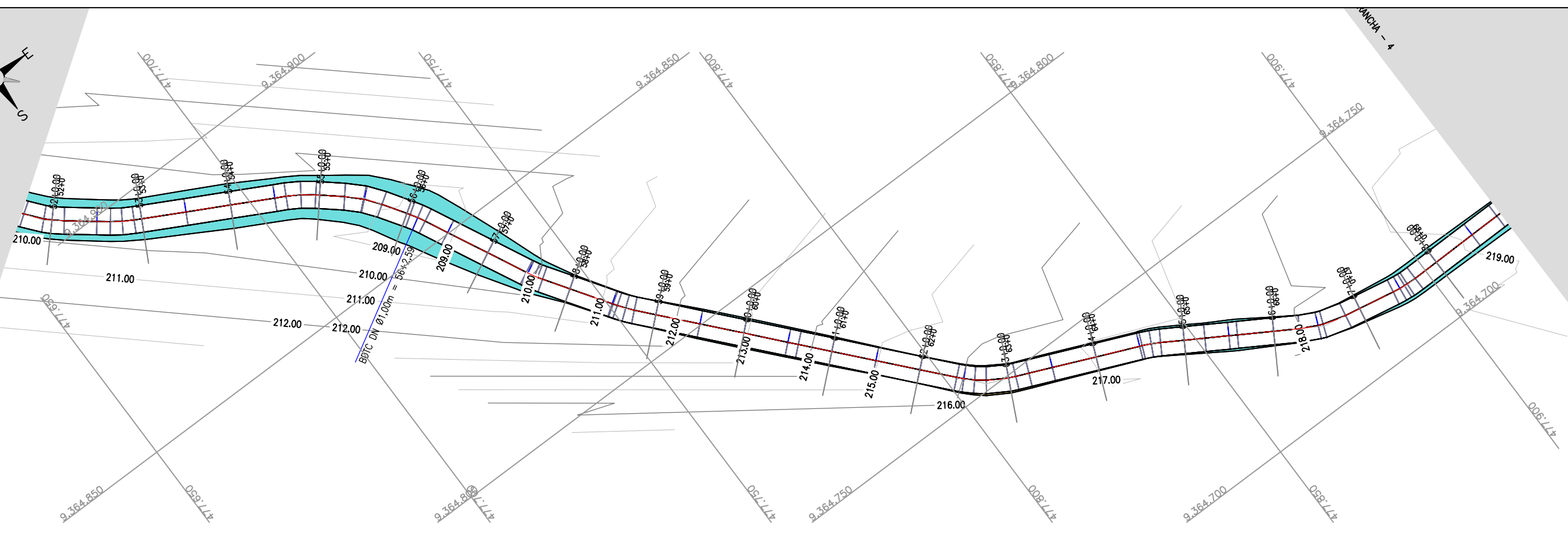

| Estaca | Cota do terreno | Cota da terraplenagem | Cota vermelha |
|---------|-----------------|-----------------------|---------------|
| 51 | 209,615 | 210,882 | 1,266 |
| 52 | 209,637 | 210,882 | 1,245 |
| 53 | 209,731 | 210,882 | 1,151 |
| 54 | 209,728 | 210,882 | 1,154 |
| 55 | 209,577 | 210,882 | 1,305 |
| 56 | 209,837 | 210,882 | 2,045 |
| 56+2,59 | 208,710 | 210,882 | 2,172 |
| 57 | 209,385 | 210,882 | 1,497 |
| 58 | 210,554 | 210,991 | 0,437 |
| 59 | 211,743 | 212,132 | 0,389 |
| 60 | 212,938 | 213,466 | 0,528 |
| 61 | 214,303 | 214,778 | 0,474 |
| 62 | 215,509 | 215,838 | 0,330 |
| 63 | 216,413 | 216,610 | 0,198 |
| 64 | 217,052 | 217,278 | 0,226 |
| 65 | 217,359 | 217,799 | 0,440 |
| 66 | 217,768 | 218,226 | 0,458 |
| 67 | 218,306 | 218,779 | 0,472 |
| 68 | 218,746 | 219,477 | 0,728 |
| 68 | 219,547 | 220,129 | 0,582 |

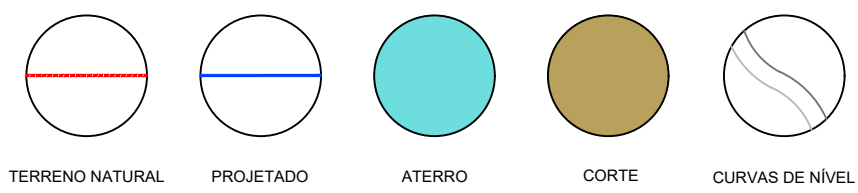

JOTA BARROS PROJETOS
 Arthur Moreira Torquato
 Engº Civil - CREA 53900/D - CE



PREFEITURA MUNICIPAL DE MILHÃ - CE
 ADEQUAÇÃO DE ESTRADAS VICINAIS NO MUNICÍPIO DE MILHÃ / CE
BAIXA VERDE LADO D. - ESTAQUEAMENTO E PERFIL LONGITUDINAL
 PROJETA: ENG. CIVIL ARTHUR MOREIRA TORQUATO - CREA 53.900D-CE
 ARQUIVO: MILHÃ_BAIXA VERDE LD_GEO_R0.DWG

PRANCHA:
4 / 12
 ESCALA:
 1/1000

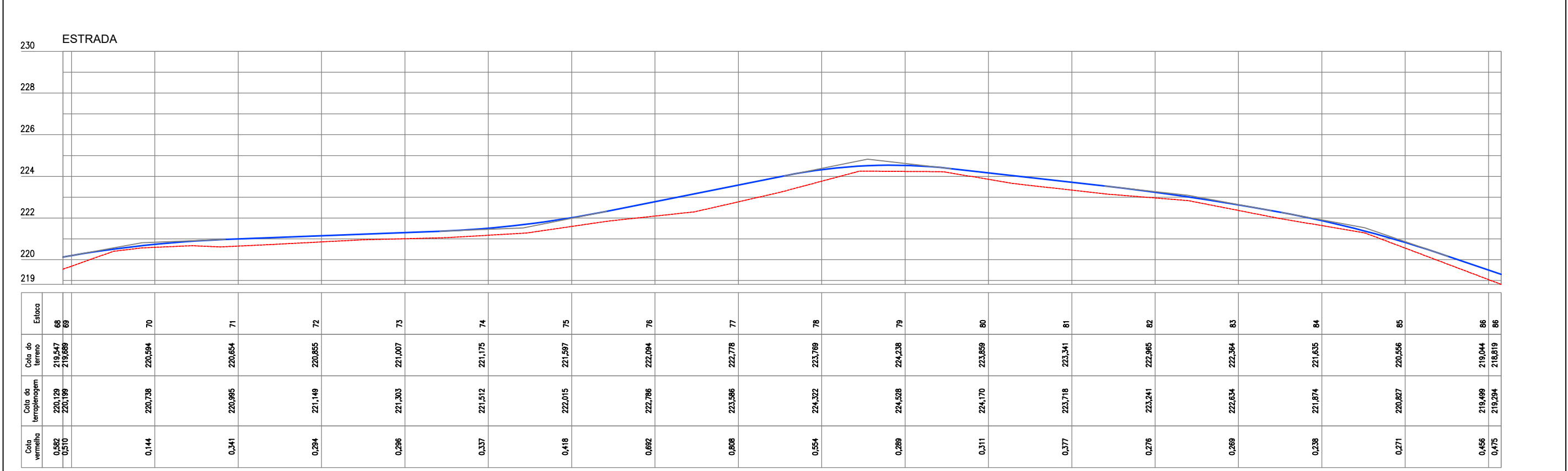
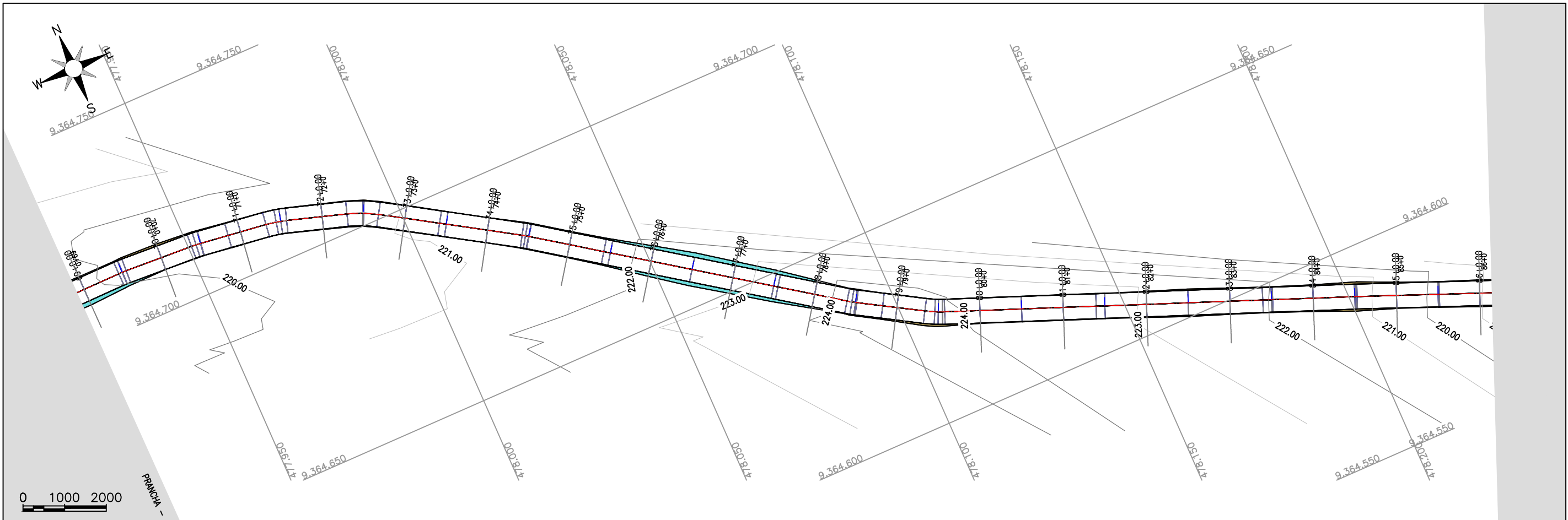

| | | | | |
|---|--|------------------------------------|--|--|
| <p>TERRENO NATURAL PROJETADO ATERRO CORTE CURVAS DE NÍVEL</p> | <p>JOTA BARROS PROJETOS Arthur Moreira Torquato Engº Civil - CREA 53900/D - CE</p> | <p>JOTA BARROS PROJETOS</p> | <p>PREFEITURA MUNICIPAL DE MILHÃ - CE</p> <p>ADEQUAÇÃO DE ESTRADAS VICINAIS NO MUNICÍPIO DE MILHÃ / CE</p> <p>BAIXA VERDE LADO D. - ESTAQUEAMENTO E PERFIL LONGITUDINAL</p> <p>PROJETISTA: ENG. CIVIL ARTHUR MOREIRA TORQUATO - CREA 53.900D-CE</p> <p>ARQUIVO: MILHÃ_BAIXA VERDE_LD_GEO_R0.DWG</p> | <p>PRANCHA:</p> <p>5 / 12</p> <p>ESCALA:</p> <p>1/1000</p> |
|---|--|------------------------------------|--|--|

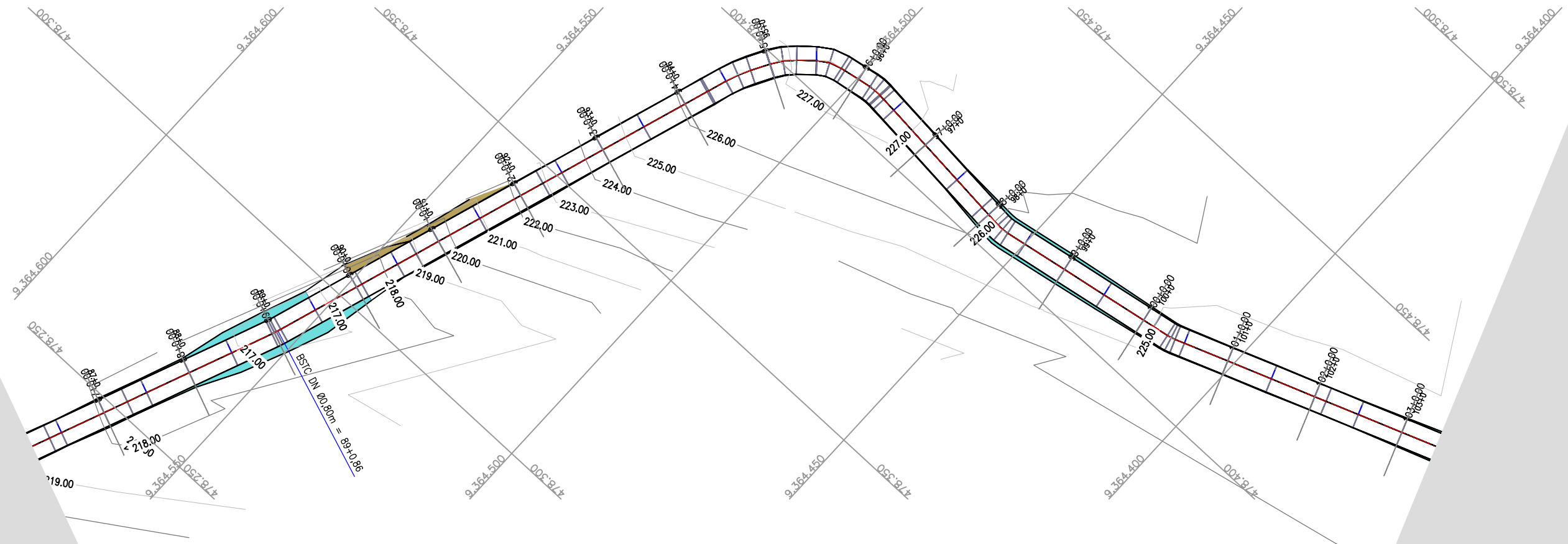

0 1000 2000

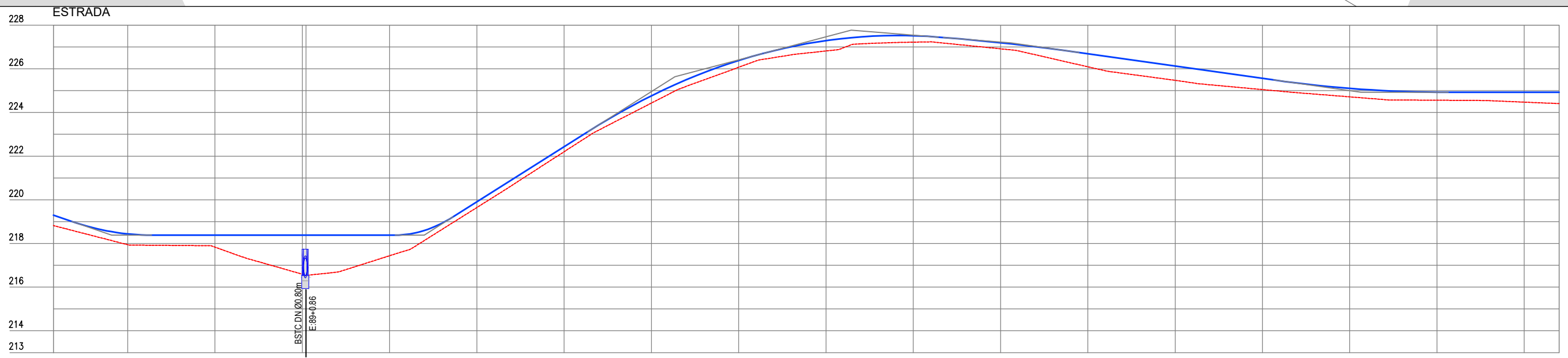

| Estaca | 86 | 87 | 88 | 89+0,86 | 90 | 91 | 92 | 93 | 94 | 95 | 96 | 97 | 98 | 99 | 100 | 101 | 102 | 103 | 103 |
|-----------------------|---------|---------|---------|---------|---------|---------|---------|---------|---------|---------|---------|---------|---------|---------|---------|---------|---------|---------|---------|
| Cota do terreno | 218,819 | 217,941 | 217,829 | 216,593 | 217,436 | 219,645 | 222,202 | 224,430 | 226,070 | 226,817 | 227,220 | 226,916 | 226,092 | 225,472 | 225,046 | 224,715 | 224,561 | 224,473 | 224,406 |
| Cota da terraplenagem | 219,294 | 218,438 | 218,382 | 218,382 | 218,382 | 219,905 | 222,432 | 224,762 | 226,384 | 227,292 | 227,516 | 227,192 | 226,691 | 226,126 | 225,562 | 225,104 | 224,926 | 224,924 | 224,924 |
| Cota vermelha | 0,475 | 0,496 | 0,552 | 1,888 | 0,945 | 0,260 | 0,230 | 0,332 | 0,314 | 0,475 | 0,296 | 0,277 | 0,599 | 0,654 | 0,513 | 0,389 | 0,366 | 0,451 | 0,516 |

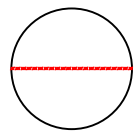

TERRENO NATURAL

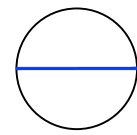

PROJETADO

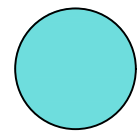

ATERRO

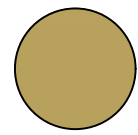

CORTE

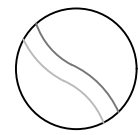

CURVAS DE NÍVEL

JOTA BARROS PROJETOS
Arthur Moreira Torquato
Engº Civil - CREA 53900/D - CE



PREFEITURA MUNICIPAL DE MILHÃ - CE

ADEQUAÇÃO DE ESTRADAS VICINAIS NO MUNICÍPIO DE MILHÃ / CE

BAIXA VERDE LADO D. - ESTAQUEAMENTO E PERFIL LONGITUDINAL

PROJETISTA: ENG. CIVIL ARTHUR MOREIRA TORQUATO - CREA 53.900D-CE

ARQUIVO: MILHÃ_BAIXA VERDE_LD_GEO_R0.DWG

PRANCHA:

6 / 12

ESCALA:

1/1000

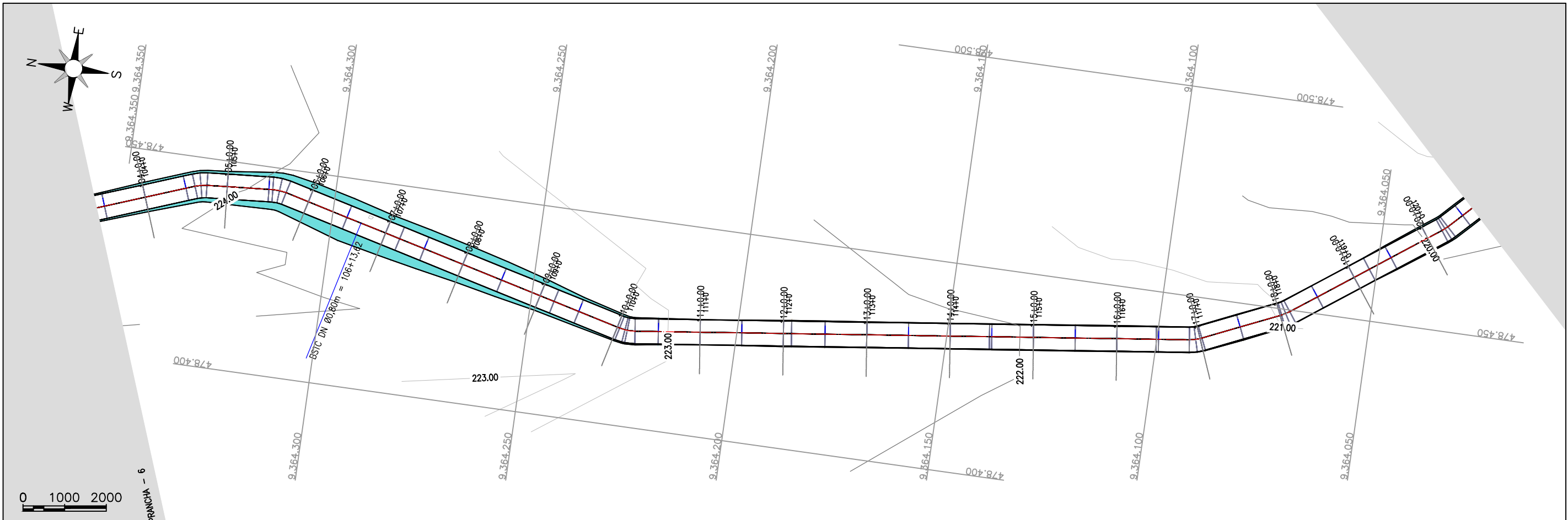

ESTRADA

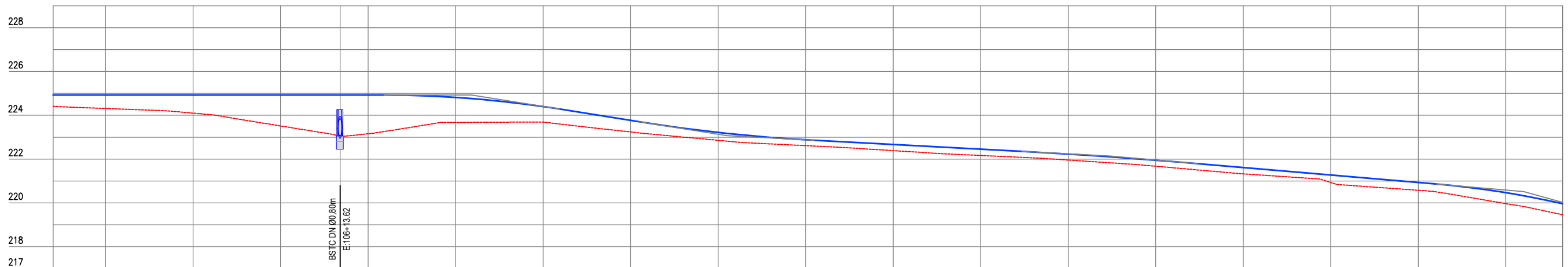

| Cota Vermelha | Cota da terraplenagem | Cota do terreno | Estaca |
|---------------|-----------------------|-----------------|-----------|
| 0,518 | 224,924 | 224,406 | 103 |
| 0,612 | 224,924 | 224,311 | 104 |
| 0,825 | 224,924 | 224,089 | 105 |
| 1,410 | 224,924 | 223,514 | 106 |
| 1,869 | 224,924 | 223,055 | 106+13,62 |
| 1,769 | 224,924 | 223,155 | 107 |
| 1,144 | 224,817 | 223,674 | 108 |
| 0,706 | 224,398 | 223,682 | 109 |
| 0,529 | 223,768 | 223,239 | 110 |
| 0,362 | 223,218 | 222,857 | 111 |
| 0,265 | 222,579 | 222,614 | 112 |
| 0,279 | 222,665 | 222,386 | 113 |
| 0,286 | 222,452 | 222,165 | 114 |
| 0,273 | 222,229 | 221,957 | 115 |
| 0,275 | 221,950 | 221,675 | 116 |
| 0,290 | 221,615 | 221,325 | 117 |
| 0,341 | 221,273 | 220,932 | 118 |
| 0,356 | 220,931 | 220,575 | 119 |
| 0,488 | 220,467 | 219,969 | 120 |
| 0,507 | 219,985 | 219,458 | 120 |

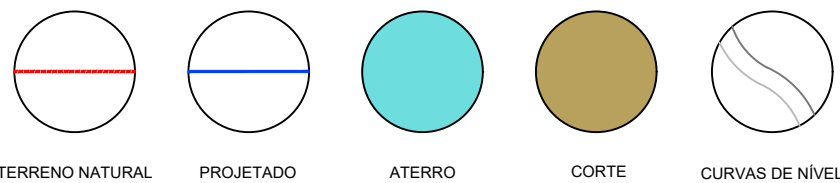

JOTA BARROS PROJETOS
 Arthur Moreira Torquato
 Engº Civil - CREA 53900/D - CE



| | |
|--|--|
| PREFEITURA MUNICIPAL DE MILHÃ - CE | |
| ADEQUAÇÃO DE ESTRADAS VICINAIS NO MUNICÍPIO DE MILHÃ / CE | |
| BAIXA VERDE LADO D. - ESTAQUEAMENTO E PERFIL LONGITUDINAL | |
| PROJETISTA: | ENG. CIVIL ARTHUR MOREIRA TORQUATO - CREA 53.900D-CE |
| ARQUIVO: | MILHÃ_BAIXA VERDE_LD_GEO_R0.DWG |

| | |
|----------|--------|
| PRANCHA: | 7 / 12 |
| ESCALA: | 1/1000 |

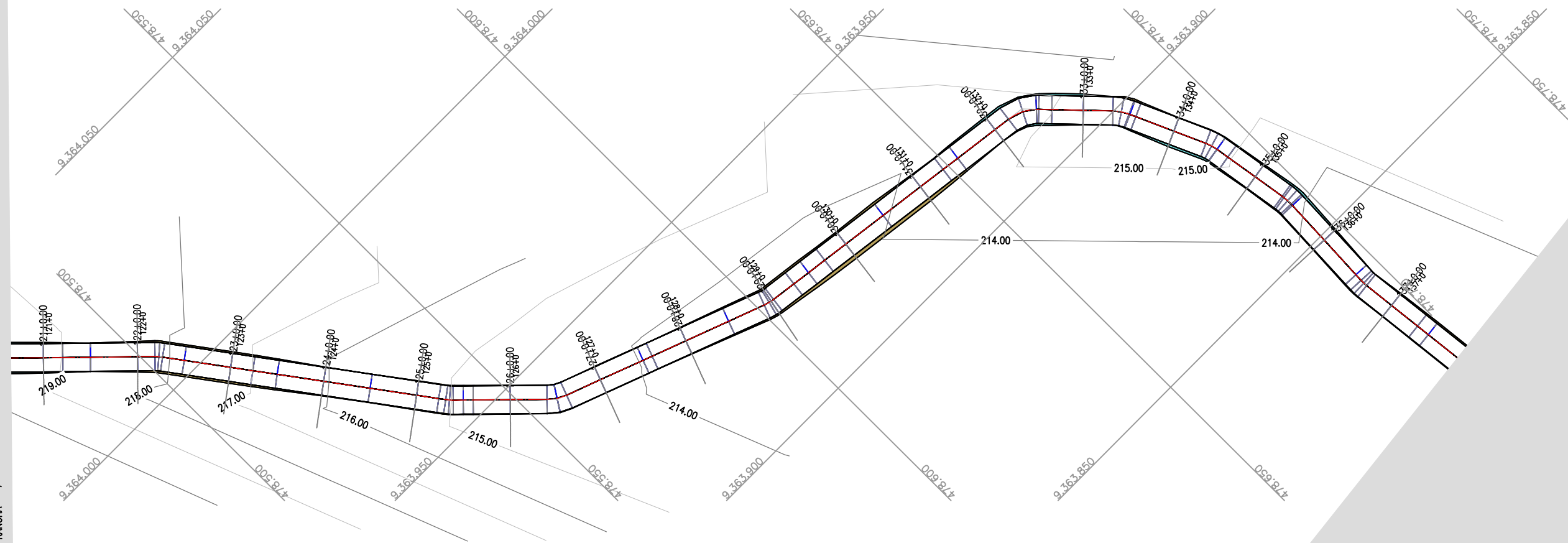

0 1000 2000
PRANCHA - 7

224 ESTRADA

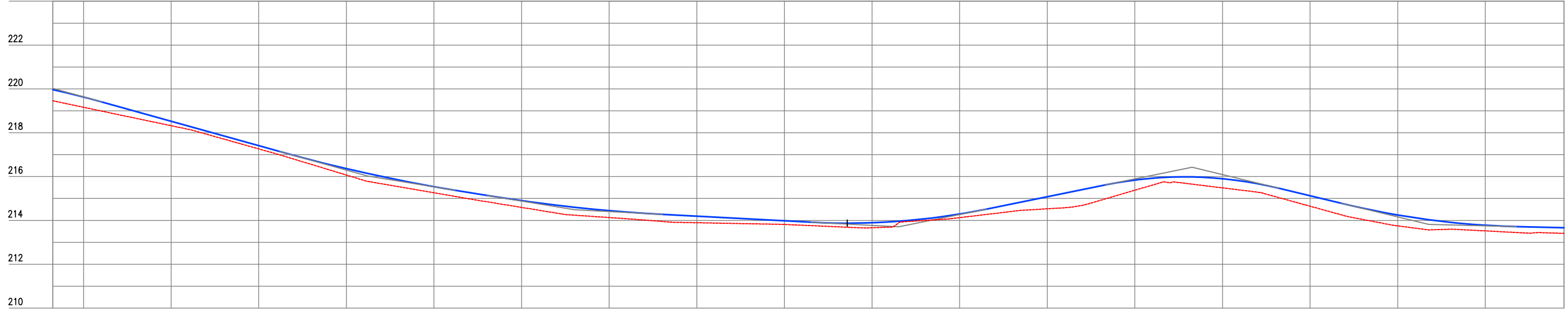

| Estaca | 120 | 121 | 122 | 123 | 124 | 125 | 126 | 127 | 128 | 129 | 130 | 131 | 132 | 133 | 134 | 135 | 136 | 137 | 137 |
|-----------------------|---------|---------|---------|---------|---------|---------|---------|---------|---------|---------|---------|---------|---------|---------|---------|---------|---------|---------|---------|
| Cota do terreno | 219,458 | 219,161 | 218,322 | 217,263 | 216,070 | 215,257 | 214,593 | 214,131 | 213,895 | 213,815 | 213,666 | 214,127 | 214,530 | 215,377 | 215,485 | 214,847 | 213,751 | 213,522 | 213,408 |
| Cota da terraplenagem | 219,965 | 219,627 | 218,522 | 217,409 | 216,363 | 215,541 | 214,900 | 214,444 | 214,192 | 213,981 | 213,893 | 214,293 | 215,081 | 215,841 | 215,902 | 215,123 | 214,248 | 213,780 | 213,665 |
| Cota vertical | 0,507 | 0,465 | 0,200 | 0,146 | 0,293 | 0,284 | 0,307 | 0,314 | 0,298 | 0,165 | 0,227 | 0,166 | 0,550 | 0,464 | 0,417 | 0,475 | 0,496 | 0,258 | 0,256 |

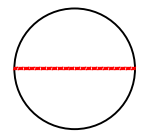

TERRENO NATURAL

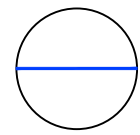

PROJETADO

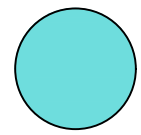

ATERRO

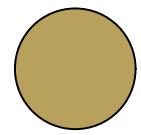

CORTE

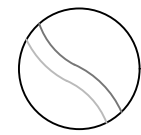

CURVAS DE NÍVEL

JOTA BARROS PROJETOS
Arthur Moreira Torquato
Engº Civil - CREA 53900/D - CE



PREFEITURA MUNICIPAL DE MILHÃ - CE

ADEQUAÇÃO DE ESTRADAS VICINAIS NO MUNICÍPIO DE MILHÃ / CE

BAIXA VERDE LADO D. - ESTAQUEAMENTO E PERFIL LONGITUDINAL

PROJETISTA: ENG. CIVIL ARTHUR MOREIRA TORQUATO - CREA 53.900D-CE

ARQUIVO: MILHÃ_BAIXA VERDE LD_GEO_R0.DWG

PRANCHA:

8 / 12

ESCALA:

1/1000

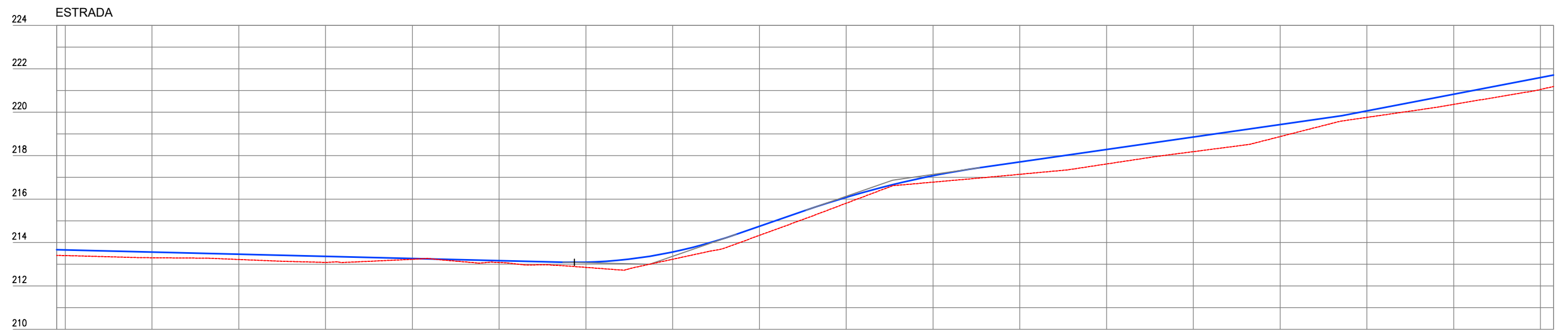
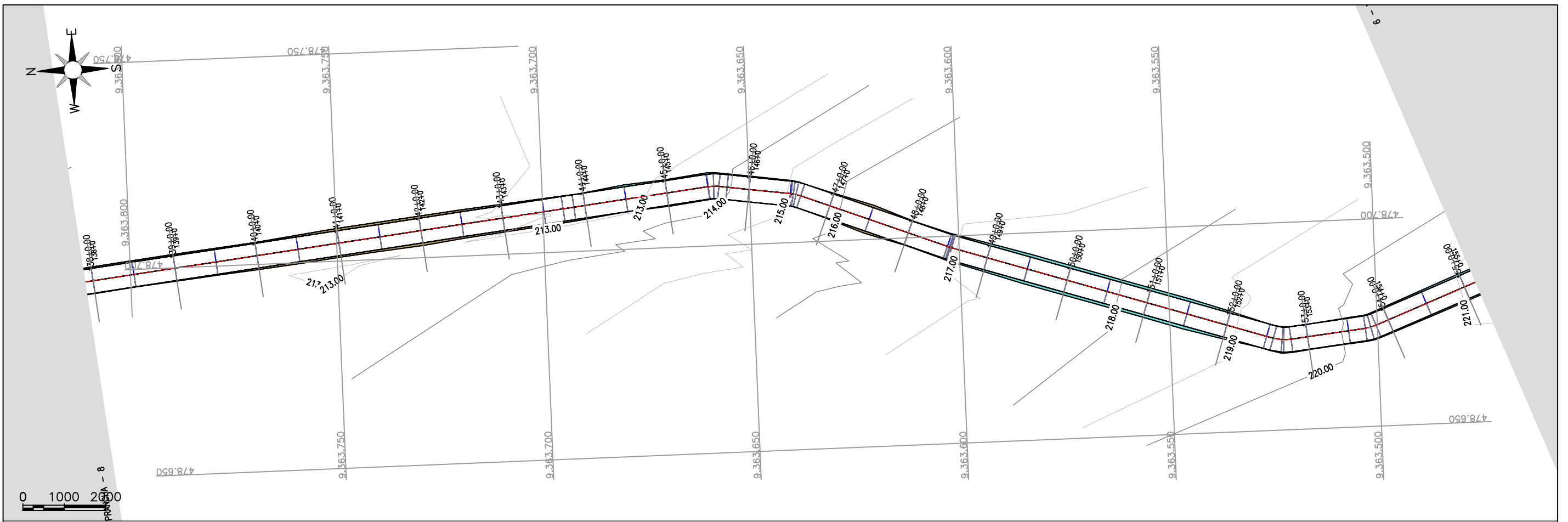

| Cota vermelha | Cota da terraplenagem | Cota do terreno | Estaca |
|---------------|-----------------------|-----------------|--------|
| 0,256 | 213,665 | 213,408 | 137 |
| 0,280 | 213,655 | 213,395 | 138 |
| 0,259 | 213,557 | 213,299 | 139 |
| 0,241 | 213,459 | 213,219 | 140 |
| 0,279 | 213,362 | 213,083 | 141 |
| 0,036 | 213,264 | 213,228 | 142 |
| 0,089 | 213,166 | 213,077 | 143 |
| 0,241 | 213,095 | 212,854 | 144 |
| 0,334 | 213,563 | 213,229 | 145 |
| 0,416 | 214,745 | 214,329 | 146 |
| 0,273 | 216,083 | 215,809 | 147 |
| 0,295 | 217,075 | 216,779 | 148 |
| 0,567 | 217,708 | 217,141 | 149 |
| 0,668 | 218,284 | 217,616 | 150 |
| 0,675 | 218,959 | 218,184 | 151 |
| 0,557 | 219,435 | 218,678 | 152 |
| 0,303 | 220,065 | 219,762 | 153 |
| 0,470 | 220,832 | 220,362 | 154 |
| 0,550 | 221,598 | 221,046 | 155 |
| 0,531 | 221,713 | 221,183 | 155 |

TERRENO NATURAL PROJETADO ATERRO CORTE CURVAS DE NÍVEL

JOTA BARROS PROJETOS
 Arthur Moreira Torquato
 Engº Civil - CREA 53900/D - CE



PREFEITURA MUNICIPAL DE MILHÃ - CE
 ADEQUAÇÃO DE ESTRADAS VICINAIS NO MUNICÍPIO DE MILHÃ / CE
BAIXA VERDE LADO D. - ESTAQUEAMENTO E PERFIL LONGITUDINAL

PROJETA: ENG. CIVIL ARTHUR MOREIRA TORQUATO - CREA 53.900D-CE
 ARQUIVO: MILHÃ_BAIXA VERDE LD_GEO_R0.DWG

PRANCHA:
9 / 12
 ESCALA:
1/1000

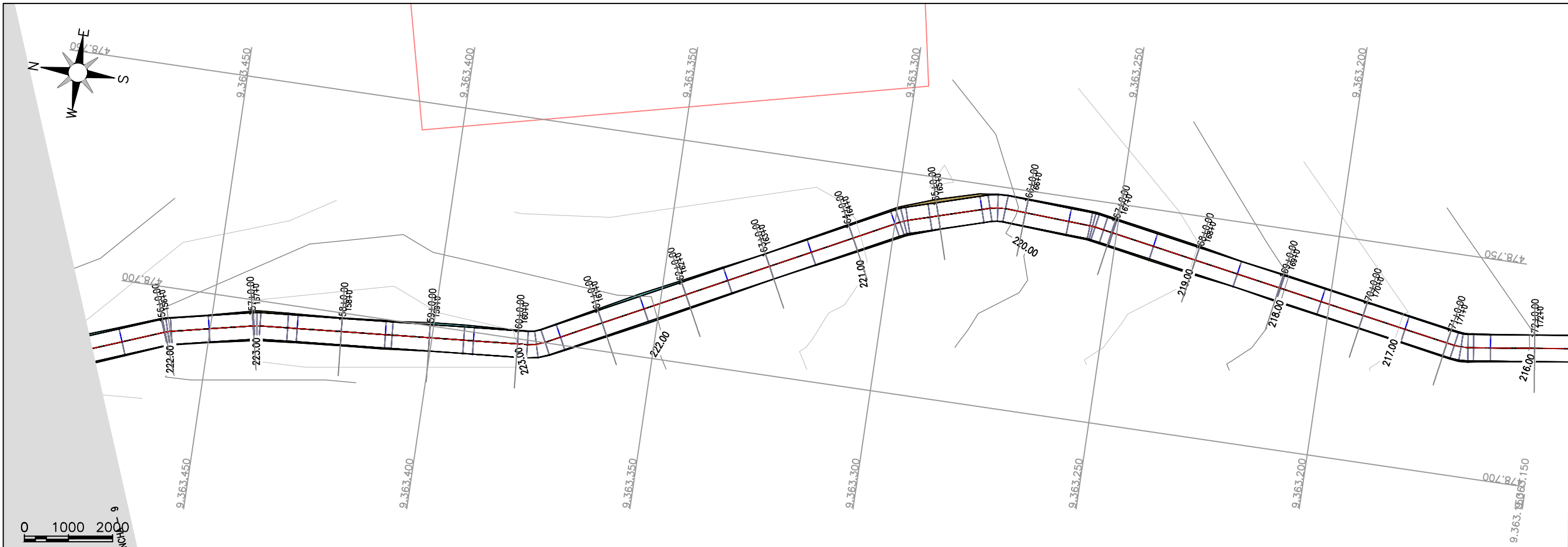

ESTRADA

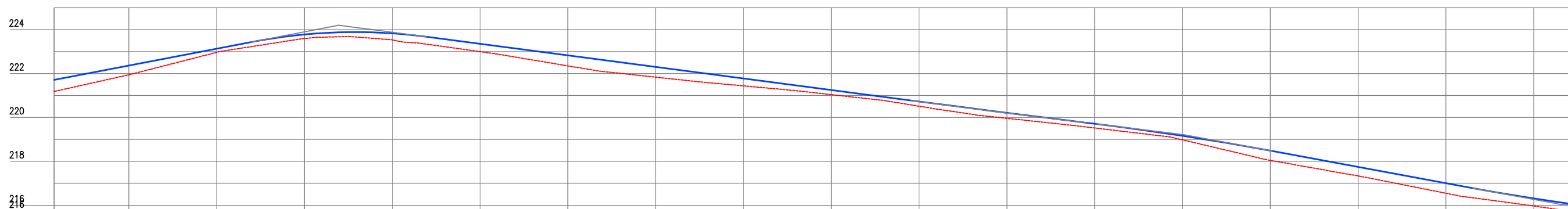

| Cota vermelha | Cota da terraplenagem | Cota do terreno | Estaca |
|---------------|-----------------------|-----------------|--------|
| 0,531 | 221,713 | 221,183 | 155 |
| 0,420 | 222,365 | 221,946 | 156 |
| 0,168 | 223,132 | 222,964 | 157 |
| 0,183 | 223,778 | 223,595 | 158 |
| 0,295 | 223,828 | 223,533 | 159 |
| 0,355 | 223,352 | 222,897 | 160 |
| 0,478 | 222,827 | 222,349 | 161 |
| 0,467 | 222,301 | 221,835 | 162 |
| 0,338 | 221,776 | 221,438 | 163 |
| 0,212 | 221,251 | 221,039 | 164 |
| 0,215 | 220,726 | 220,511 | 165 |
| 0,251 | 220,211 | 219,959 | 166 |
| 0,193 | 219,713 | 219,519 | 167 |
| 0,183 | 219,161 | 218,978 | 168 |
| 0,441 | 218,485 | 218,044 | 169 |
| 0,412 | 217,745 | 217,333 | 170 |
| 0,658 | 217,004 | 216,546 | 171 |
| 0,341 | 216,307 | 215,967 | 172 |
| 0,328 | 216,076 | 215,748 | 172 |

TERRENO NATURAL PROJETADO ATERRO CORTE CURVAS DE NÍVEL

JOTA BARROS PROJETOS
 Arthur Moreira Torquato
 Engº Civil - CREA 53900/D - CE



PREFEITURA MUNICIPAL DE MILHÃ - CE
 ADEQUAÇÃO DE ESTRADAS VICINAIS NO MUNICÍPIO DE MILHÃ / CE
BAIXA VERDE LADO D. - ESTAQUEAMENTO E PERFIL LONGITUDINAL
 PROJETA: ENG. CIVIL ARTHUR MOREIRA TORQUATO - CREA 53.900D-CE
 ARQUIVO: MILHÃ_BAIXA VERDE LD_GEO_R0.DWG

PRANCHA:
10 / 12
 ESCALA:
1/1000

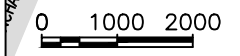
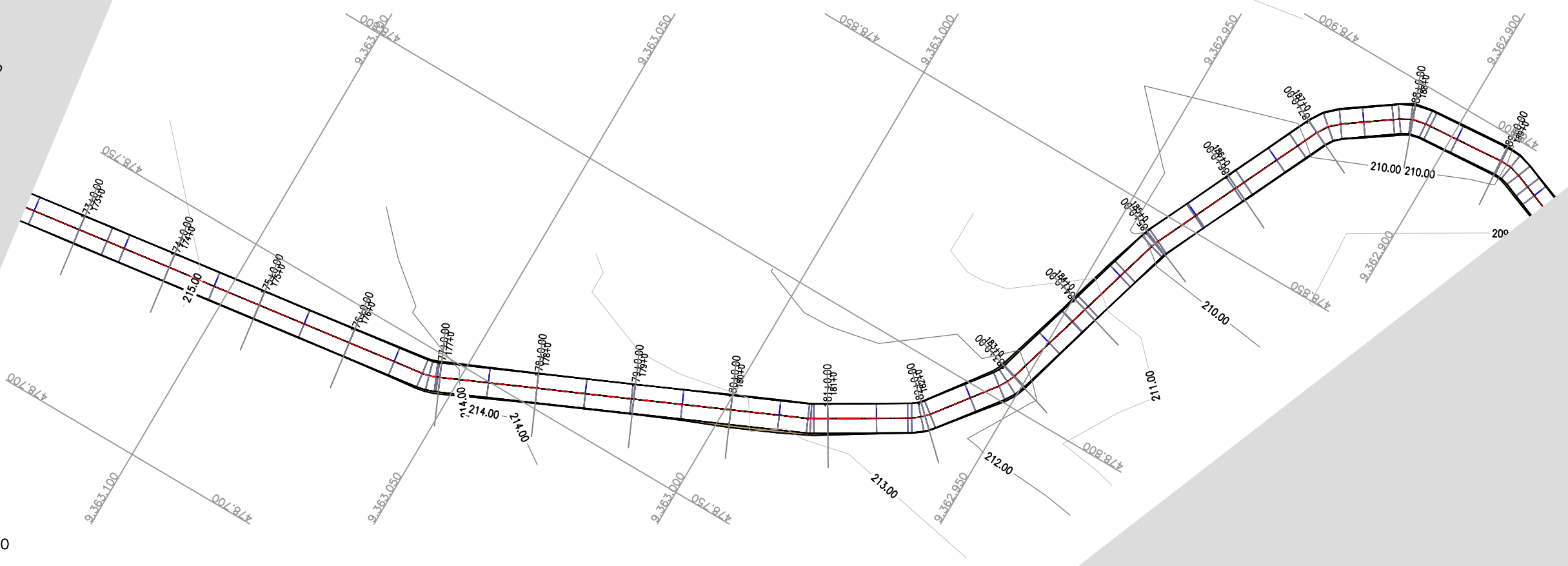
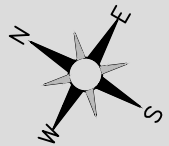

ESTRADA

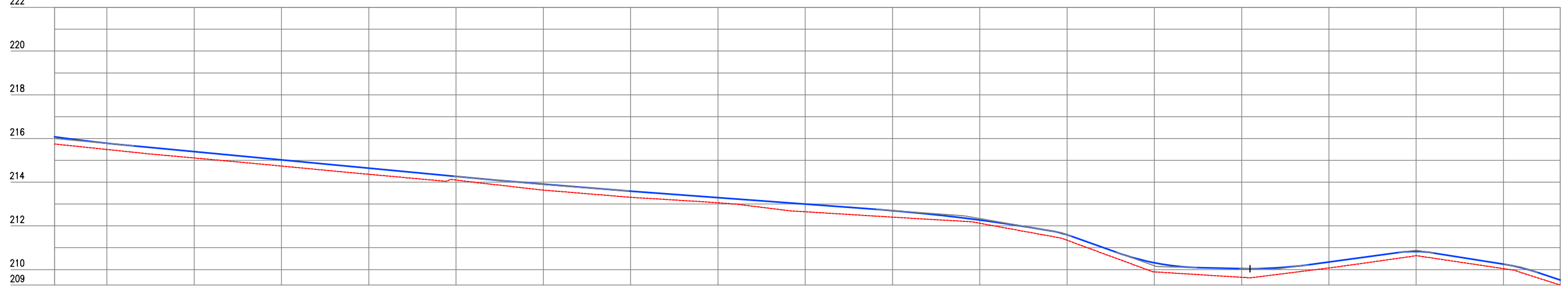

| Estaca | Cota do terreno | Cota da terraplenagem | Cota vermelha |
|--------|-----------------|-----------------------|---------------|
| 172 | 215,748 | 216,076 | 0,328 |
| 173 | 215,487 | 215,783 | 0,287 |
| 174 | 215,108 | 215,397 | 0,289 |
| 175 | 214,737 | 215,019 | 0,282 |
| 176 | 214,361 | 214,642 | 0,281 |
| 177 | 214,098 | 214,264 | 0,165 |
| 178 | 213,637 | 213,907 | 0,270 |
| 179 | 213,307 | 213,591 | 0,284 |
| 180 | 213,059 | 213,294 | 0,236 |
| 181 | 212,645 | 212,997 | 0,352 |
| 182 | 212,400 | 212,697 | 0,298 |
| 183 | 212,121 | 212,267 | 0,146 |
| 184 | 211,344 | 211,593 | 0,250 |
| 185 | 209,894 | 210,309 | 0,415 |
| 186 | 209,647 | 210,043 | 0,396 |
| 187 | 210,073 | 210,348 | 0,274 |
| 188 | 210,636 | 210,830 | 0,194 |
| 189 | 210,043 | 210,246 | 0,203 |
| 189 | 209,291 | 209,526 | 0,234 |

| | | | | |
|-----------------|-----------|--------|-------|-----------------|
| | | | | |
| TERRENO NATURAL | PROJETADO | ATERRO | CORTE | CURVAS DE NÍVEL |

JOTA BARROS PROJETOS
 Arthur Moreira Torquato
 Engº Civil - CREA 53900/D - CE



| | |
|--|--|
| PREFEITURA MUNICIPAL DE MILHÃ - CE | |
| ADEQUAÇÃO DE ESTRADAS VICINAIS NO MUNICÍPIO DE MILHÃ / CE | |
| BAIXA VERDE LADO D. - ESTAQUEAMENTO E PERFIL LONGITUDINAL | |
| PROJETISTA: | ENG. CIVIL ARTHUR MOREIRA TORQUATO - CREA 53.900D-CE |
| ARQUIVO: | MILHÃ_BAIXA VERDE_LD_GEO_R0.DWG |

| | |
|----------|----------------|
| PRANCHA: | 11 / 12 |
| ESCALA: | 1/1000 |

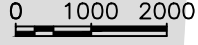
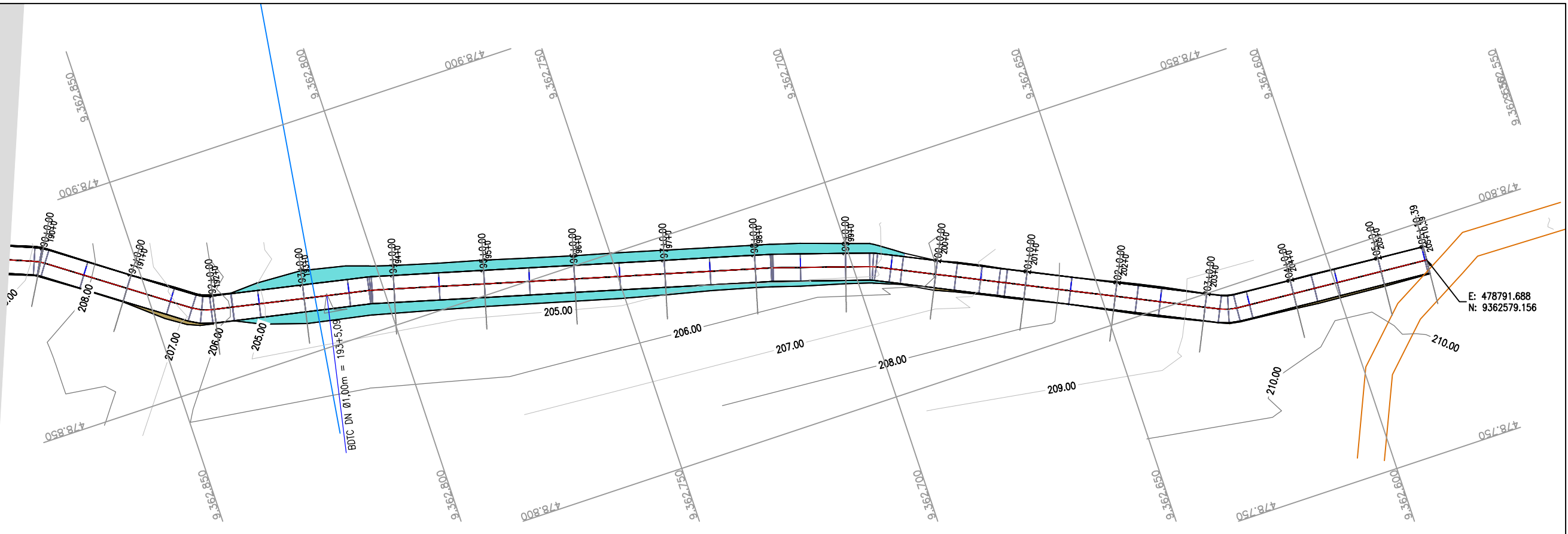
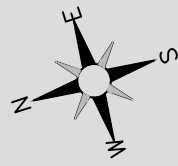

E: 478791.688
N: 9362579.156

ESTRADA

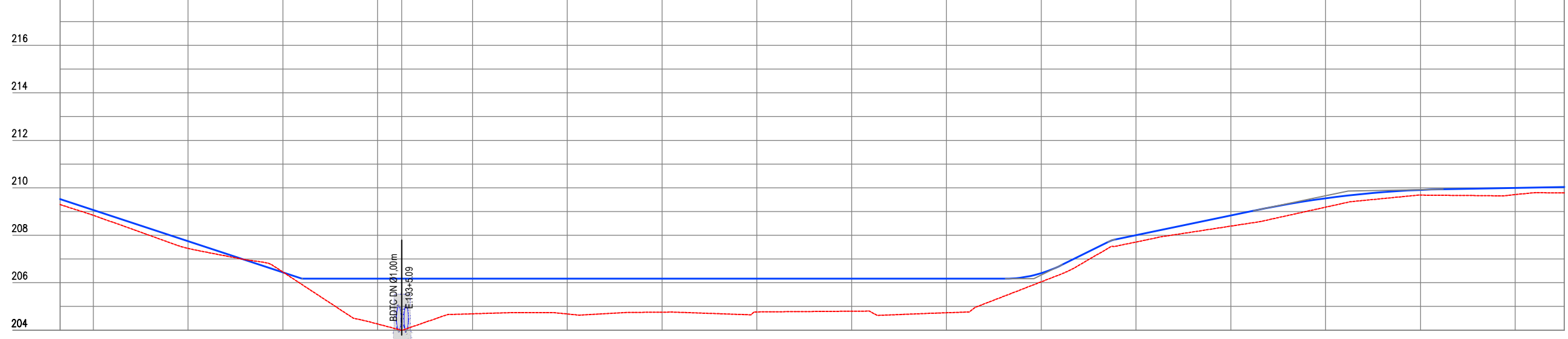

| Cota vermelha | Cota da terraplenagem | Cota do terreno | Estaca |
|---------------|-----------------------|-----------------|----------|
| 0,234 | 209,526 | 209,291 | 189 |
| 0,224 | 209,065 | 208,842 | 190 |
| 0,303 | 207,751 | 207,447 | 191 |
| -0,015 | 206,436 | 206,452 | 192 |
| 1,907 | 206,169 | 204,261 | 193 |
| 2,175 | 206,169 | 203,993 | 193+5,09 |
| 1,478 | 206,169 | 204,691 | 194 |
| 1,465 | 206,169 | 204,684 | 195 |
| 1,409 | 206,169 | 204,759 | 196 |
| 1,399 | 206,169 | 204,770 | 197 |
| 1,369 | 206,169 | 204,799 | 198 |
| 1,434 | 206,169 | 204,735 | 199 |
| 0,366 | 206,403 | 206,037 | 200 |
| 0,289 | 206,004 | 207,714 | 201 |
| 0,450 | 206,834 | 208,385 | 202 |
| 0,373 | 209,556 | 209,183 | 203 |
| 0,220 | 209,911 | 209,691 | 204 |
| 0,282 | 209,997 | 209,715 | 205 |
| | | | 205 |

JOTA BARROS PROJETOS
Arthur Moreira Torquato
Engº Civil - CREA 53900/D - CE



PREFEITURA MUNICIPAL DE MILHÃ - CE

ADEQUAÇÃO DE ESTRADAS VICINAIS NO MUNICÍPIO DE MILHÃ / CE

BAIXA VERDE LADO D. - ESTAQUEAMENTO E PERFIL LONGITUDINAL

PROJETISTA: ENG. CIVIL ARTHUR MOREIRA TORQUATO - CREA 53.900D-CE

ARQUIVO: MILHÃ_BAIXA VERDE LD_GEO_R0.DWG

PRANCHA: 12 / 12

ESCALA: 1/1000